

76829-0006 SHOWN

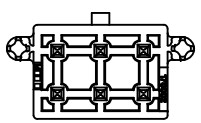
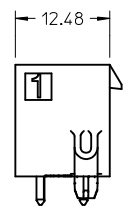
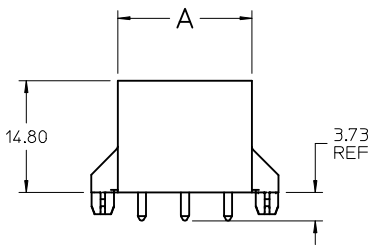
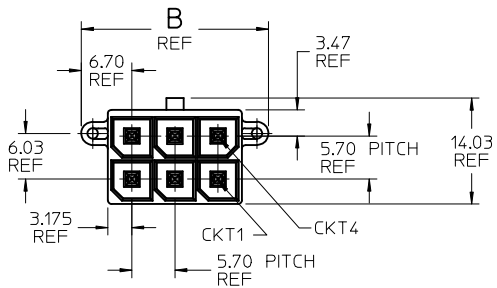

| CKT SIZE | | PART NO. | PLATING | DIM A | DIM B | DIM C BASIC | DIM D |
|----------|---|-------------|---------|-------|-------|-------------|-------|
| 2 | X | 76829-0002 | TIN | 8.35 | 15.39 | 12.34 | 16.39 |
| 4 | X | 76829-0004 | TIN | 12.05 | 19.10 | 16.04 | 20.10 |
| 6 | X | 76829-0006 | TIN | 17.75 | 24.80 | 21.74 | 25.80 |
| 8 | X | 76829-0008 | TIN | 23.45 | 30.50 | 27.44 | 31.50 |
| 10 | X | 76829-0010 | TIN | 29.15 | 36.20 | 33.14 | 37.20 |
| 12 | X | 76829-0012 | TIN | 34.85 | 41.90 | 38.84 | 42.90 |
| 2 | | 172065-0002 | 15 GOLD | 8.35 | 15.39 | 12.34 | 16.39 |
| 4 | | 172065-0004 | 15 GOLD | 12.05 | 19.10 | 16.04 | 20.10 |
| 6 | | 172065-0006 | 15 GOLD | 17.75 | 24.80 | 21.74 | 25.80 |
| 8 | | 172065-0008 | 15 GOLD | 23.45 | 30.50 | 27.44 | 31.50 |
| 10 | | 172065-0010 | 15 GOLD | 29.15 | 36.20 | 33.14 | 37.20 |
| 12 | | 172065-0012 | 15 GOLD | 34.85 | 41.90 | 38.84 | 42.90 |
| 2 | | 172065-1002 | 30 GOLD | 8.35 | 15.39 | 12.34 | 16.39 |
| 4 | | 172065-1004 | 30 GOLD | 12.05 | 19.10 | 16.04 | 20.10 |
| 6 | | 172065-1006 | 30 GOLD | 17.75 | 24.80 | 21.74 | 25.80 |
| 8 | | 172065-1008 | 30 GOLD | 23.45 | 30.50 | 27.44 | 31.50 |
| 10 | | 172065-1010 | 30 GOLD | 29.15 | 36.20 | 33.14 | 37.20 |
| 12 | | 172065-1012 | 30 GOLD | 34.85 | 41.90 | 38.84 | 42.90 |

NOTES:

- MATERIAL:
HOUSING: LCP, UL94V-0, GLOW WIRE CAPABLE PER IEC-60335-1 5TH EDITION, COLOR: BLACK.
TERMINAL: HIGH CONDUCTIVITY COPPER.
- TERMINAL PLATING:
(TIN) 1.52 MICROMETER /(60 MICROINCH) MIN REFLOWED MATTE TIN OVER
1.27 MICROMETER /(50 MICROINCH) MIN NICKEL OVERALL.
(15 GOLD) 0.38 MICROMETER /(15 MICROINCH) MIN SELECT GOLD ON CONTACT AREA
2.54 MICROMETER /(100 MICROINCH) MIN SELECT MATTE TIN ON SOLDER AREA BOTH OVER 1.27 MICROMETER /(50 MICROINCH) MIN NICKEL OVERALL
(30 GOLD) 0.76 MICROMETER /(30 MICROINCH) MIN SELECT GOLD ON CONTACT AREA
2.54 MICROMETER /(100 MICROINCH) MIN SELECT MATTE TIN ON SOLDER AREA BOTH OVER 1.27 MICROMETER /(50 MICROINCH) MIN NICKEL OVERALL
- PRODUCT SPECIFICATION PS-76823-100.
- PART MATES WITH MOLEX PART NUMBER 170001 AND 171692 SERIES.
- PACKAGING: TRAY PACKED PER MOLEX SPECIFICATION PK-31301-976.
- APPLICATION SPECIFICATION: AS-76823-100
- PARTS CONFORM TO CLASS "B" REQUIREMENTS OF COSMETIC SPECIFICATION PS-45499-002.

| | | | | | | | |
|---|-----------------|---------------------------------------|---|---|-------------------------------|------------------------|-----------|
| UPDATE NOTE 1 EC NO: UCP2015-4319 DRWIN: DFOX CHKD: IBELL APPR: FSMITH 2015/04/17 2015/04/17 2015/04/29 | QUALITY SYMBOLS | GENERAL TOLERANCES (UNLESS SPECIFIED) | DIMENSION STYLE MM ONLY | SCALE 2:1 | DESIGN UNITS METRIC | THIRD ANGLE PROJECTION | |
| | ▽=0 | mm INCH | DRAWN BY DATE MKARADIMAS 2010/10/06 | MEGA-FIT VERTICAL HEADER ASSY 2-12 CKT TOP LATCH | | | |
| | ▽=0 | 4 PLACES ± --- ± --- | CHECKED BY DATE APATEL 2010/10/06 | | | | |
| | ▽=0 | 3 PLACES ± --- ± --- | 2 PLACES ± 0.25 ± --- | APPROVED BY DATE APATEL 2012/06/13 | MATERIAL NO. | DOCUMENT NO. | SHEET NO. |
| | ▽=0 | 2 PLACES ± --- ± --- | 1 PLACE ± --- ± --- | 0 PLACE ± ± | SEE CHART | SD-76829-0100 | 1 OF 2 |
| D5 | DESCRIPTION | ANGULAR ±1/2° | DRAFT WHERE APPLICABLE MUST REMAIN WITHIN DIMENSIONS THIS DRAWING CONTAINS INFORMATION THAT IS PROPRIETARY TO MOLEX INCORPORATED AND SHOULD NOT BE USED WITHOUT WRITTEN PERMISSION | | | | |

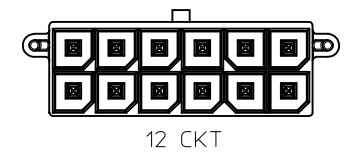
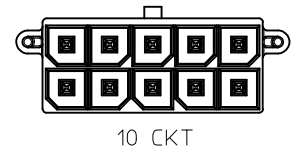
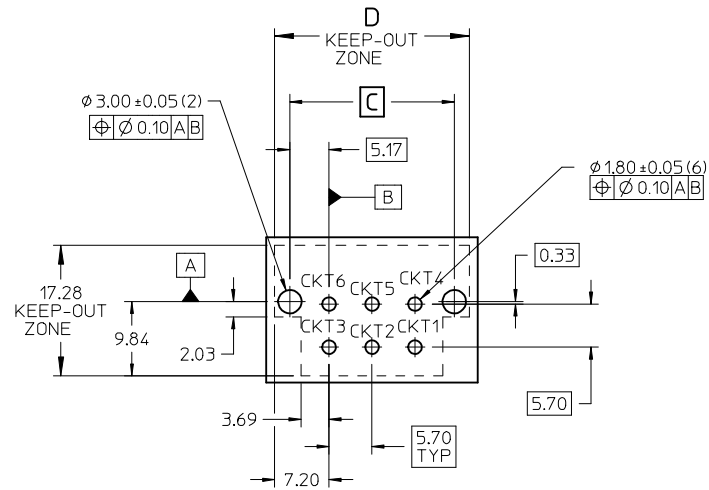
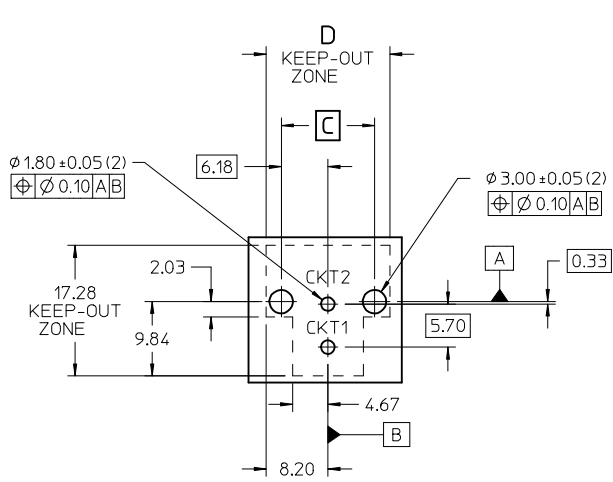
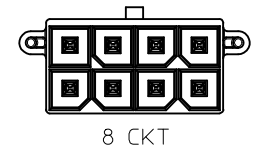
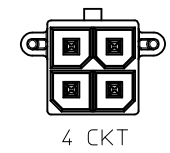
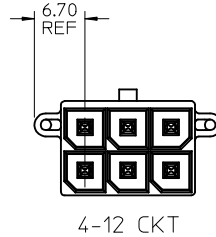
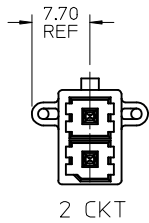

| | | | | | | | | | | |
|---|--------------------------------------|---------------------------------------|----|----------------------------|------------------------|--------------------|--|------------------------|--|--|
| SEE SHEET 1 IEC NO: UCP2015-4319 DRWN: DFOX CHKD: JELL APPR: FSMITH 2015/04/17 2015/04/17 2015/04/29 | QUALITY SYMBOLS ▽=0 ▽=0 ▽=0 | GENERAL TOLERANCES (UNLESS SPECIFIED) | | DIMENSION STYLE MM ONLY | | SCALE 2:1 | DESIGN UNITS METRIC | THIRD ANGLE PROJECTION | | |
| | | 4 PLACES ± --- ± --- | mm | INCH | DRAWN BY MKARADIMAS | DATE 2010/10/06 | MEGA-FIT VERTICAL HEADER ASSY 2-12 CKT TOP LATCH molex DOCUMENT NO. SD-76829-0100 SHEET NO. 2 OF 2 | | | |
| | | 3 PLACES ± --- ± --- | | | CHECKED BY APATEL | DATE 2010/10/06 | | | | |
| | | 2 PLACES ± 0.25 ± --- | | | APPROVED BY APATEL | DATE 2012/06/13 | | | | |
| | | 1 PLACE ± --- ± --- | | | | | | | | |
| 0 PLACE ± ± | | | | | | | | | | |
| DRAFT WHERE APPLICABLE MUST REMAIN WITHIN DIMENSIONS | | ANGULAR ±1/2° | | SEE CHART | | | | | | |