

CW-B1651

REV	DOCUMENT	CHANGED BY	CHECK
4	0043895	MBH 22SEP08	BLR

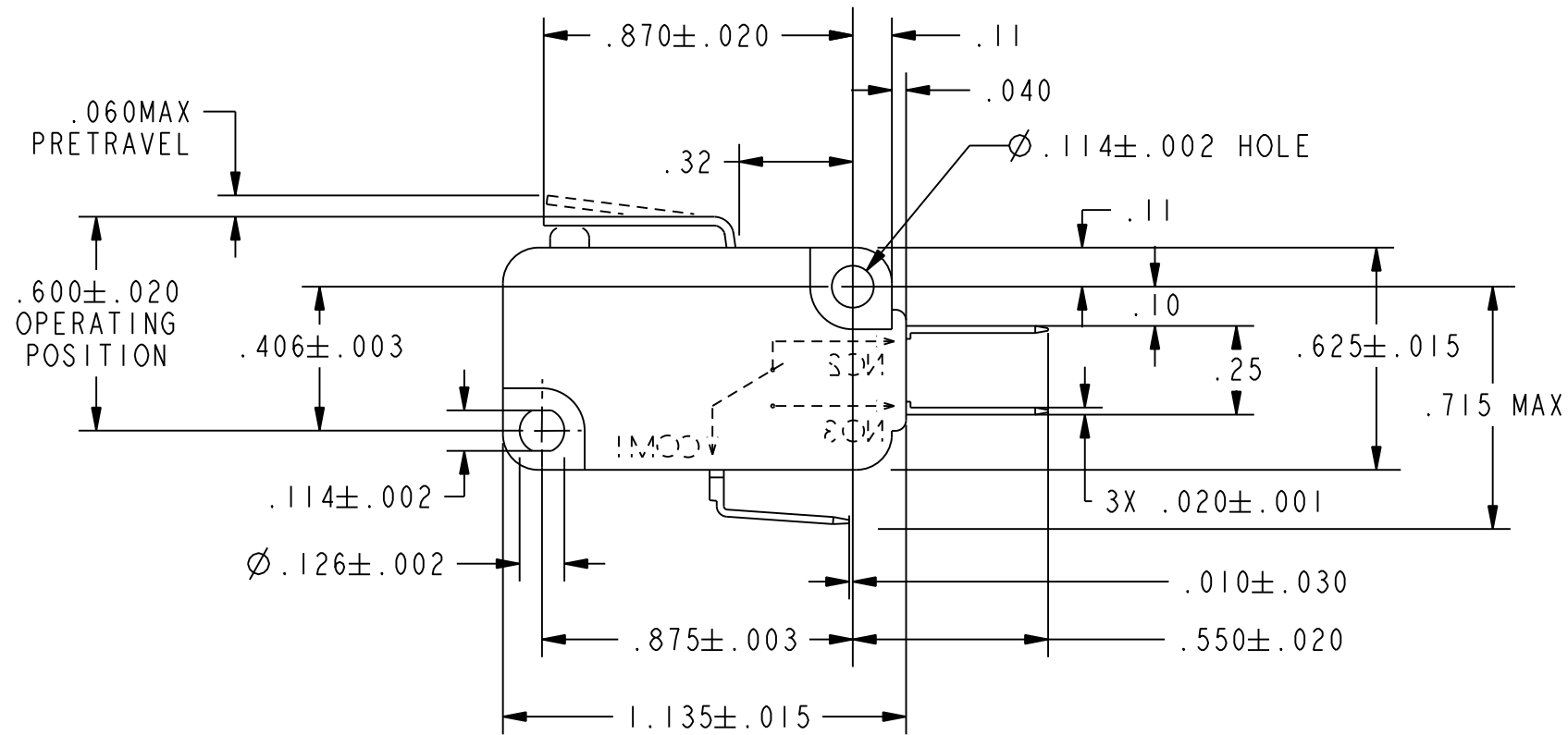
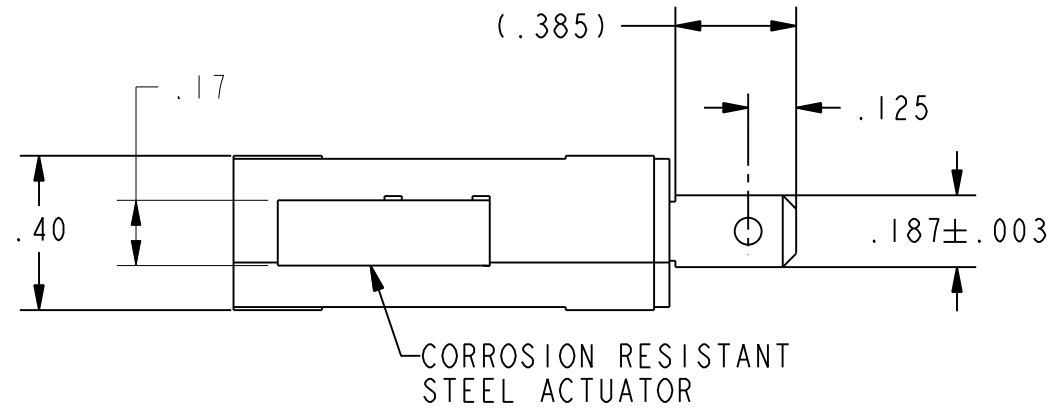

RELEASE NO	CATALOG LISTING
PR-19218	V7-1C17D8-002
	CW-B1651

CHARACTERISTICS	
OPERATING FORCE	-----160 GRAMS MAX
RELEASE FORCE	-----15 GRAMS MIN
DIFFERENTIAL TRAVEL	-----0.15 MAX
OVERTRAVEL	-----0.035 MIN
RELEASE TRAVEL	-----0.009 MIN

ELECTRICAL DATA	
CONTACT ARRANGEMENT	
S P D T	
L215	
15.1A 1/2HP 125, 250 OR 277 VAC	
1/2A 125 VDC	
1/4A 250 VDC; 5A 125 VAC "L"	

UNLESS OTHERWISE SPECIFIED TOLERANCES ARE:

	<input checked="" type="checkbox"/> US (inch) CUSTOMARY	<input type="checkbox"/> SI (mm) METRIC
NO PLACE	X ±.040	±1
ONE PLACE	.X ±.030	±0.4
TWO PLACE	.XX ±.015	±0.15
THREE PLACE	.XXX ±.005	± —
ANGLES	± —	± —
RAW MATERIAL-COMMERCIAL STANDARD		

THIRD ANGLE PROJECTION

DRAWN	WJC	11 JUN 91
CHECK	JAL	12 JUN 91
THIS DRAWING COVERS A PROPRIETARY ITEM AND IS THE PROPERTY OF HONEYWELL. THIS DRAWING IS NOT TO BE COPIED OR USED WITHOUT THE PERMISSION OF HONEYWELL.		
DIMENSIONS ARE TO BE MET BEFORE PROTECTIVE COATINGS ARE APPLIED		
PTC 2D	ASME Y14.5M-1994	

Honeywell			
TITLE SWITCH, BASIC			
SIZE	DWG TYPE	DRAWING NAME	REV
B	I	V7-1C17D8-002	4
SCALE	-	WEIGHT	SHEET 1 OF 1