

FRONT VIEW

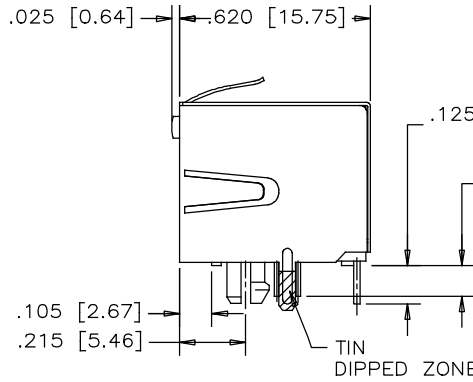

SIDE VIEW

REVISIONS			
REV	DESCRIPTION, ECN, EAR NO.	DATE	APP'D
E	PROPOSAL	JUN 19/08	L.CHAN
F	UPDATED NOTES	JAN 23/15	L.CHAN
G	CHANGE SHIELD'S MATERIAL PER ECN 160658	JUN 14/16	L.CHAN

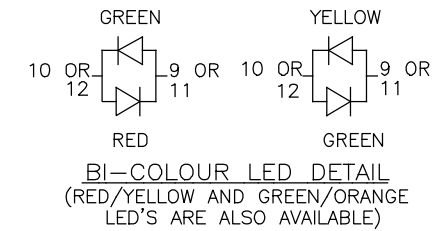

BI-COLOUR LED DETAIL  
(RED/YELLOW AND GREEN/ORANGE LED'S ARE ALSO AVAILABLE)

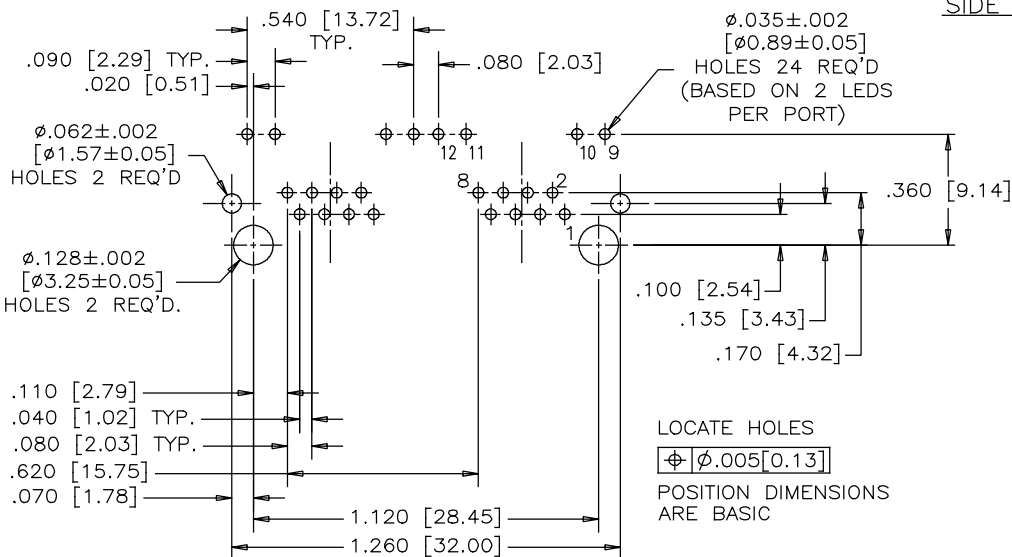

RECOMMENDED P.C.B. LAYOUT  
(COMPONENT SIDE OF BOARD  
TOLERANCES: +/- .002[0.05])

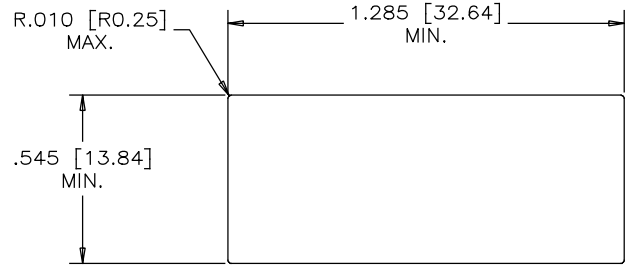

RECOMMENDED PANEL CUTOUT

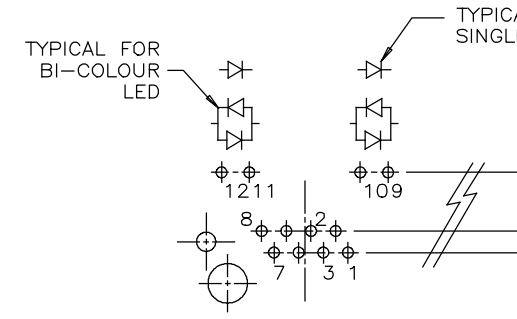

LED SCHEMATIC

**MATERIALS:**  
 PLASTIC HOUSING: HIGH TEMPERATURE THERMOPLASTIC  
 FLAMMABILITY RATING UL 94V-0,  
 COLOUR: BLACK  
**CONTACTS:**  
 PHOSPHOR BRONZE  
 PLATING: 50 μ" [1.27 MICRONS] MIN.  
 GOLD ON MATING SURFACES.  
 50 μ" [1.27 MICRONS]  
 MIN. NICKEL UNDERPLATE  
 100 μ" [2.54 MICRONS]  
 MIN. MATTE TIN ON CONTACT TAILS.  
**SHIELD:** STAINLESS STEEL  
 WITH TIN DIP ON SOLDER TAIL.  
**ENVIRONMENTAL:**  
 OPERATING TEMPERATURE: -55°C TO 85°C

**PART NUMBER:** RJHSE-538X-02X  
 REFER TO LED OPTIONS DRAWING  
 FOR ORDERING CODES



UNLESS SPECIFIED OTHERWISE	DRAWN FRANK.WANG	DATE SEP24/14	Amphenol Canada Corp. www.amphenolcanada.com
PRIMARY UNITS INCH	CHECKED LAWRENCE.C	DATE SEP24/14	
SECONDARY MILLIMETER	M.E. APP'D	TITLE	2 PORT HIGH SPEED MODULAR JACK, 8 POSITION, 8 CONTACTS, SHIELDED AND WITH LED OPTIONS - RoHS COMPLIANT
REFERENCE IN PARENTHESES	Q.A. APP'D	DWG. NO.	
GENERAL TOLERANCES	DWG APPR.	REF.	
1 DECIMAL PLACE ±0.025	ENG. REL. NO.	THIRD ANGLE PROJECTION	P-RJHSE-538X-02X
2 DECIMAL PLACES ±0.020	REF.	DO NOT SCALE DRAWING	
3 DECIMAL PLACES ±0.015			REV G
ANGULAR DEGREES ±1.0°			CODE ID NO. 03554 DWG SIZE: c SCALE: N/A SHEET 1 OF 1