



PANDUIT PART #	WIRE RANGE		WIRE STRIP LENGTH +1/32 -0 [+0,8 -0]	WIRE CLASS	DIMENSIONS in. [mm]				INSTALLATION TOOLS
	AWG	[mm <sup>2</sup> ]			L	ID-1 (REF.)	OD-1 (REF.)	OD-2	
F84-12	6	[16,0]	15/32 [12,0]	G, H, I, K, M	0.47 [12,0]	0.23 [5,8]	0.24 [6,2]	0.30 [7,5]	++CT-1004 CT-1104 #CT-2504CH
F84-15			19/32 [15,0]		0.59 [15,0]	0.23 [5,8]	0.24 [6,2]	0.30 [7,5]	
F84-18			23/32 [18,0]		0.71 [18,0]	0.23 [5,8]	0.24 [6,2]	0.30 [7,5]	
F84-20			25/32 [20,0]		0.79 [20,0]	0.23 [5,8]	0.24 [6,2]	0.30 [7,5]	
F84-25			31/32 [25,0]		0.98 [25,0]	0.23 [5,8]	0.24 [6,2]	0.30 [7,5]	
F84-32			1-1/4 [32,0]		1.26 [32,0]	0.23 [5,8]	0.24 [6,2]	0.30 [7,5]	
F85-12	4	[25]	15/32 [12,0]	G, H, I, K, M	0.47 [12,0]	0.29 [7,3]	0.30 [7,7]	0.37 [9,5]	CT-1005
F85-15			19/32 [15,0]		0.59 [15,0]	0.29 [7,3]	0.30 [7,7]	0.37 [9,5]	
F85-18			23/32 [18,0]		0.71 [18,0]	0.29 [7,3]	0.30 [7,7]	0.37 [9,5]	
F85-25			31/32 [25,0]		0.98 [25,0]	0.29 [7,3]	0.30 [7,7]	0.37 [9,5]	
F85-32			1 1/4 [32,0]		1.26 [32,0]	0.29 [7,3]	0.30 [7,7]	0.37 [9,5]	
F86-18			2		[35]	23/32 [18,0]	G, H, I, K, M	0.71 [18,0]	
F86-20	25/32 [20,0]	0.79 [20,0]		0.33 [8,3]		0.34 [8,7]		0.43 [11,0]	
F86-25	31/32 [25,0]	0.98 [25,0]		0.33 [8,3]		0.34 [8,7]		0.43 [11,0]	
F86-32	1 1/4 [32,0]	1.26 [32,0]		0.33 [8,3]		0.34 [8,7]		0.43 [11,0]	

\* NOT UL LISTED, UL486F SCOPE IS 20 - 1/0 AWG ONLY  
 ++ TOOL/PART COMBINATION IS NOT UL LISTED  
 \*\* DIES USED WITH CT-3001 OR CT-3001/E TOOL  
 # CRIMP HEAD USED WITH CT-2500 TOOL  
 @ DIES USED WITH CT-3001/ST, CT-3001/CCP SERIES TOOLS AND CT-930LPCH CRIMP HEAD AND CT-902HP 5K PUMP  
 △ CRIMPS WITH 1 AWG F87-18 FERRULES USING CD-2001-F87 OR CD-920-F87 DIES REQUIRE DOUBLE 180° CRIMP

NOTES:

- USED FOR:
  - UL LISTED WITH STRANDED COPPER WIRE 20 - 1/0 AWG ONLY
  - 302°F [150°C] MAX. OPERATING TEMPERATURE
- MATERIAL:
  - STAMPING: COPPER, TIN PLATED
- SEE [www.panduit.com](http://www.panduit.com) FOR PACKAGE QUANTITIES
- DIMENSIONS IN BRACKETS ARE METRIC EQUIVALENT
- FOR TOLERANCING REFER TO DIN 46228 PART 1

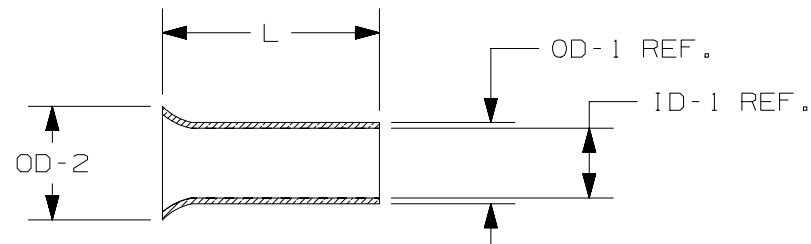

PANDUIT PART #	WIRE RANGE		WIRE STRIP LENGTH +1/32 -0 [+0,8 -0]	WIRE CLASS	DIMENSIONS in. [mm]				INSTALLATION TOOLS/DIES
	AWG	[mm <sup>2</sup> ]			L	ID-1 (REF.)	OD-1 (REF.)	OD-2	
F87-18	1-1/0	[50]	23/32 [18,0]	G, H, DLO, I, K, M	0.71 [18,0]	0.41 [10,3]	0.43 [10,9]	0.51 [13,0]	CT-1006 **CD-2001-F87 @CD-920-F87
F87-22			7/8 [22,0]		0.87 [22,0]	0.41 [10,3]	0.43 [10,9]	0.51 [13,0]	
F87-25			31/32 [25,0]		0.98 [25,0]	0.41 [10,3]	0.43 [10,9]	0.51 [13,0]	
F87-32			1 1/4 [32,0]		1.26 [32,0]	0.41 [10,3]	0.43 [10,9]	0.51 [13,0]	
* F89-25			2/0		[70]	31/32 [25,0]	H, DLO, I, K, M	0.98 [25,0]	
* F89-32	1 1/4 [32,0]	1.26 [32,0]		0.49 [12,5]		0.52 [13,3]		0.59 [15,0]	
* F90-25	3/0	[95]	31/32 [25,0]	H, DLO, I, K, M	0.98 [25,0]	0.57 [14,5]	0.60 [15,3]	0.67 [17,0]	**CD-2001-F90 @CD-920-F90
* F90-30			1 3/16 [30,0]		1.18 [30,0]	0.57 [14,5]	0.60 [15,3]	0.67 [17,0]	
* F90-32			1 1/4 [32,0]		1.26 [32,0]	0.57 [14,5]	0.60 [15,3]	0.67 [17,0]	
* F91-32	4/0-250	[120]	1 1/4 [32,0]	H, DLO, I, K, M	1.26 [32,0]	0.65 [16,5]	0.69 [17,5]	0.75 [19,0]	**CD-2001-F91 @CD-920-F91
* F91-40			1 19/32 [40,0]		1.57 [40,0]	0.65 [16,5]	0.69 [17,5]	0.75 [19,0]	
* F92-32	300	[150]	1 1/4 [32,0]	H, DLO, I, K, M	1.26 [32,0]	0.73 [18,5]	0.77 [19,5]	0.83 [21,0]	**CD-2001-F92 @CD-920-F92
* F92-38			1 1/2 [38,0]		1.50 [38,0]	0.73 [18,5]	0.77 [19,5]	0.83 [21,0]	
* F93-32	350	[185]	1 1/4 [32,0]	H, DLO, I, K, M	1.26 [32,0]	0.79 [20,0]	0.83 [21,2]	0.93 [23,5]	**CD-2001-F93 @CD-920-F93
* F93-40			1 19/32 [40,0]		1.57 [40,0]	0.79 [20,0]	0.83 [21,2]	0.93 [23,5]	
* F94-40	500	[240]	1 19/32 [40,0]	H, DLO, I, K, M	1.57 [40,0]	0.90 [22,8]	0.94 [24,0]	1.02 [25,8]	**CD-2001-F94 @CD-920-F94



TITLE				FERRULES - BARE, NO SLEEVE SHEET 2 OF 2 CUSTOMER DRAWING			
ITEM REVISION NAME				N41670BA/21			
DATASET FILE NAME				N41670BA_DC/20			
UNLESS OTHERWISE SPECIFIED, DIMENSIONAL TOLERANCES ARE: IN [mm]				MATERIAL:			
.X ±				.XXX ±			
.XX ±				ANGLES ±			
THIRD ANGLE PROJECTION				DRAWING NUMBER:			
A41670				SHT 2 OF 2			
DRAWN BY	DATE	CHK	SCALE	SIZE			
JKD	2/10/99	SKB	N.T.S.	B			