

PRODUCT NO.
61729-*

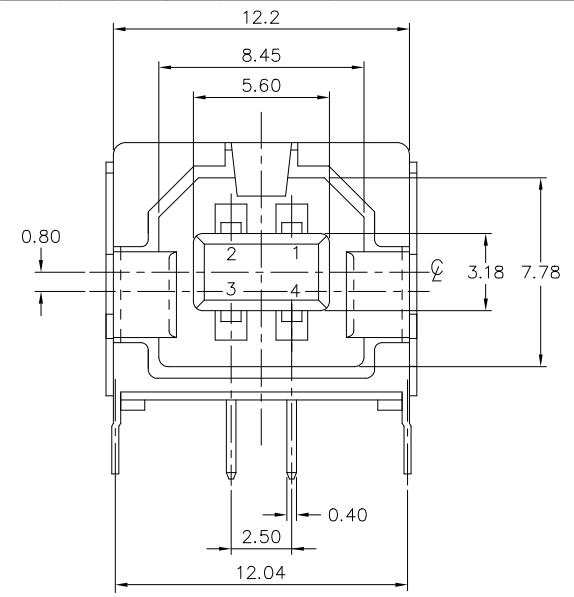

Amphenol FCI

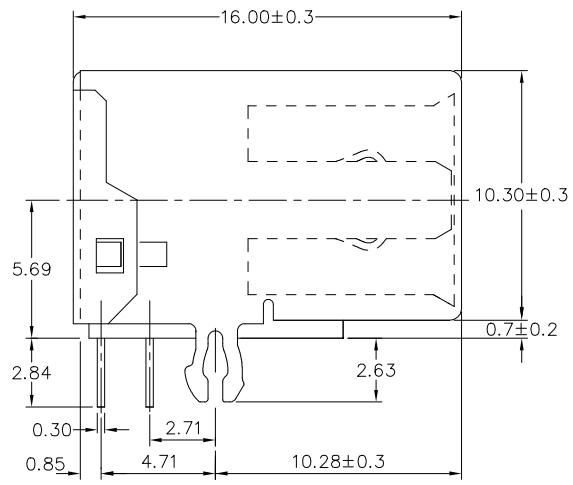
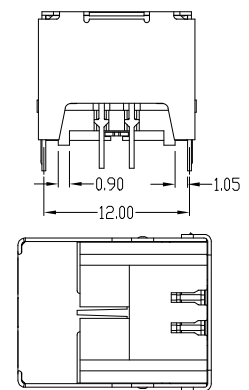

TYPE "4" PARTIAL BACK WITH SHORT SOLDER TAIL, SHELL TAIL AND SPECIAL HOUSING FOR PIP PROCESS 61729-XXWXLF

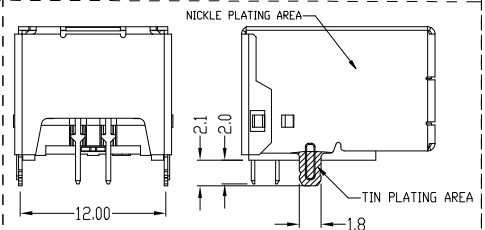

TYPE "5" PARTIAL BACK WITH SHORT SOLDER TAIL, SHORT SHELL TAIL AND SELECTED MATTE TIN SHELL FOR PIP PROCESS 61729-XXTXLF

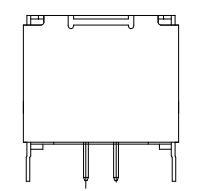

TYPE "1" FULL BACK

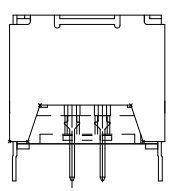

TYPE "2" PARTIAL BACK

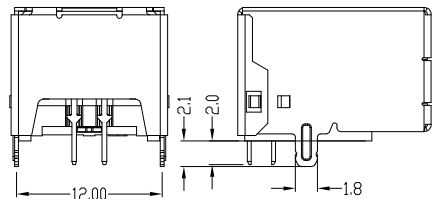

TYPE "3" PARTIAL BACK WITH SHORT SOLDER TAIL AND SHELL TAIL FOR PIP PROCESS 61729-XXQXLF

mat'l. code		surface ISO 1302 ✓		tolerance ISO 406 ISO 1101		projection		product family	
ltr		ecn no		dr		date		HPL 511 USB2.0	
AA		ELX-N-34768-1		YY		09/19/19		title	
AB		ELX-N-37746-1		YY		07/21/20		USB RECEPTACLE B TYPE	
				angles		linear		scale 1:1	
				0°±2'		0.0±0.30			
						0.00±0.20			
						0.000±0.10			
V		N08-0246		RB		12/08/08		dr Yuan-Yuan Bao 07/21/20	
W		ECR-N-16533		LQ		12/17/13		engr Yuan-Yuan Bao 07/21/20	
X		ELX-N-29556		LZ		03/09/18		chr Li-Qing Lei 07/21/20	
Y		ELX-N-32780		YY		02/26/19		appd Tim.Yao 07/21/20	
sheet		revision						Amphenol FCI	
index		sheet						dwg no 61729 sheet 1 of 3 size A3	
								type Product Customer Drawing	

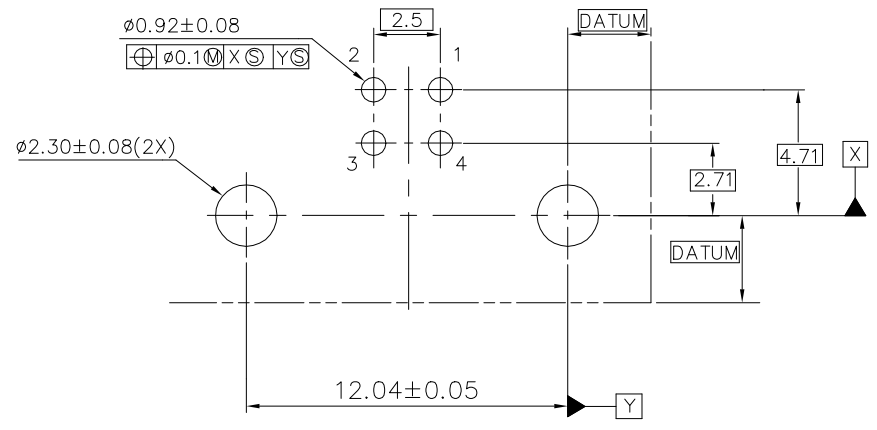

P.C. BOARD LAYOUT
 STYLE 1 APPLY FOR TYPE 1 & 2

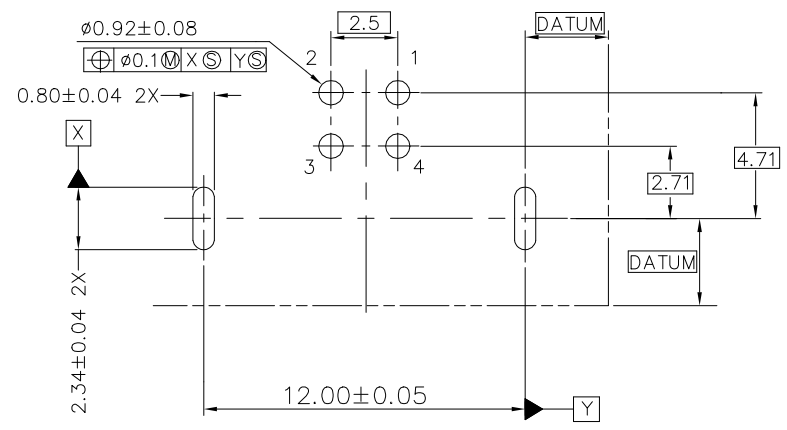

P.C. BOARD LAYOUT
 STYLE 2 APPLY FOR TYPE 3

NOTES:

1. MATERIAL:
 SHIELD & CONTACTS: COPPER ALLOY
 HOUSING: UL 94V-0 ,HIGH TEMPERATURE THERMOPLASTIC.
 COLOR: SEE PRODUCT NUMBER CODE.
2. PLATING: SEE PRODUCT NUMBER CODE.
 SHIELD: BRIGHT TIN, NICKEL UNDERPLATE(USED FOR WAVE SOLDER PROCESS),
 PLATING NICKEL ONLY(USED FOR PIP PROCESS).
3. DATUMS & BASIC DIMENSIONS TO BE DETERMINED BY CUSTOMER
4. RECOMMENDED BOARD THICKNESS IS 1.57 mm (.062)
5. PACKING STANDARD GS-14-920 WILL BE APPLIED FOR LEAD FREE P/N'S
6. FOR LEAD FREE P/N, THE PRODUCT MEET EUROPEAN UNION DIRECTIVES AND OTHER COUNTRY REGULATION AS DESCRIBED IN GS-22-008
7. FOR LEAD FREE P/N'S, THE HOUSING WILL WITHSTAND EXPOSURE TO 260°C PEAK TEMPERATURE FOR 10 SECONDS IN A CONVECTION, INFRO-RED OR VAPOR PHASE REFLOW OVEN.
8. THE PART CAN BE USED FOR PIP PROCESS.

Amphenol FCI
 © 2016 AFCI

mat'l. code		surface ISO 1302 ✓	tolerance ISO 406 ISO 1101	projection	product family HPL 511 USB2.0
ltr	ecn no	dr	date	tolerances unless otherwise specified	title
AB				0.0±0.30 0.00±0.20 0.000±0.10	USB RECEPTACLE B TYPE
				linear	mm
				0°±2'	scale 1:1
		dr	Yuan-Yuan Bao	07/21/20	Amphenol FCI dwg no 61729 sheet 2 of 3 size A3 type Product Customer Drawing
		eng	Yuan-Yuan Bao	07/21/20	
		chr	Li-Qing Lei	07/21/20	
		appd	Tim Yao	07/21/20	
sheet index	revision sheet				

PRODUCT NUMBER CODE:

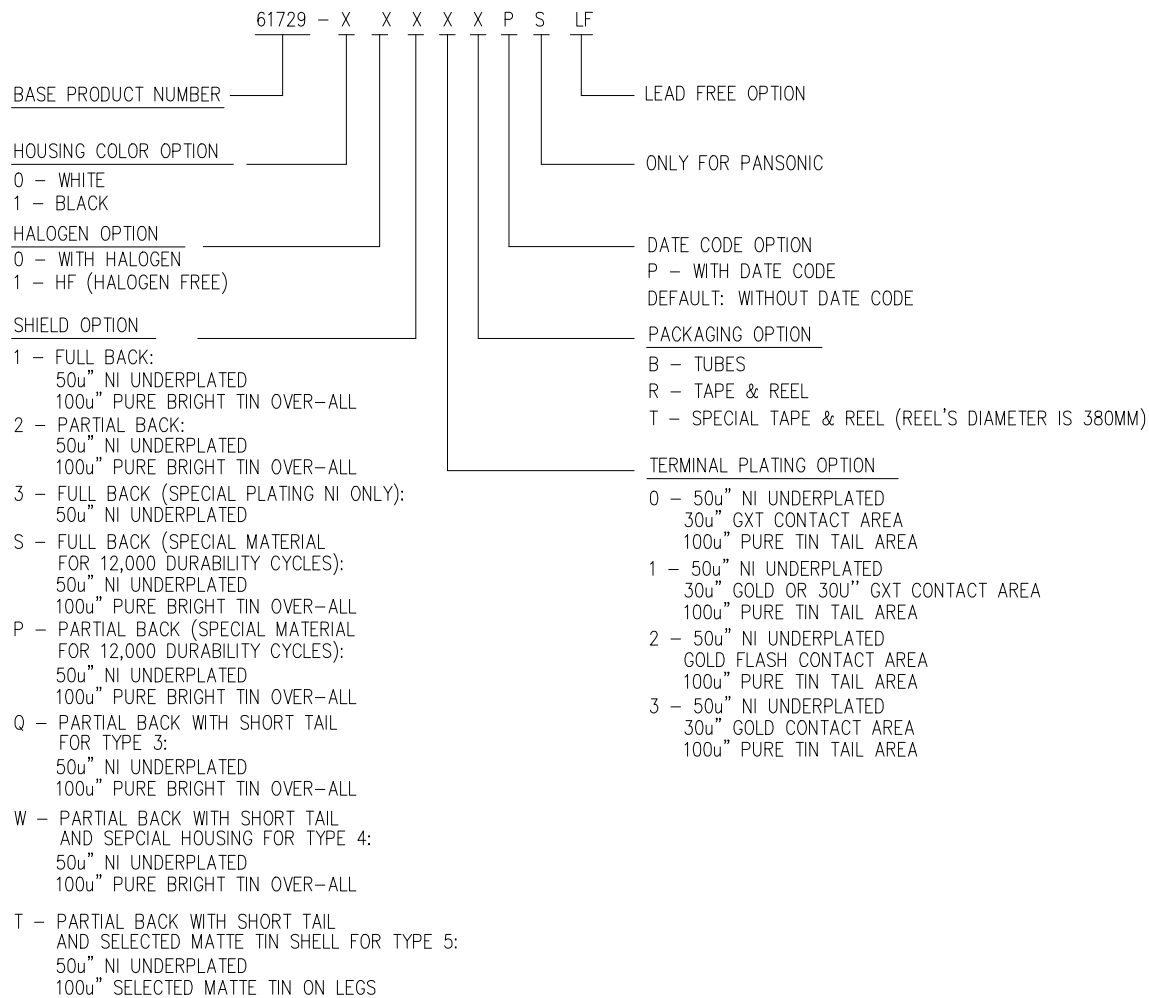

© 2016 AFCI

mat'l. code		surface	tolerance	projection	product family
		ISO 1302 ✓	ISO 406 ISO 1101		HPL 511 USB2.0
ltr	ecn no	dr	date	tolerances unless otherwise specified	title
AB				0.0±0.30 0.00±0.20 0.000±0.10	USB RECEPTACLE B TYPE
				linear	mm
				0°±2'	scale 1:1
		dr	Yuan-Yuan Bao	07/21/20	Amphenol FCI dwg no 61729 sheet 3 of 3 size A3 type Product Customer Drawing
		eng	Yuan-Yuan Bao	07/21/20	
		chr	Li-Qing Lei	07/21/20	
		appd	Tim.Yao	07/21/20	
sheet index	revision sheet				