

PRODUCT NUMBER	PITCH
OQxx12x000J0G	3.50mm

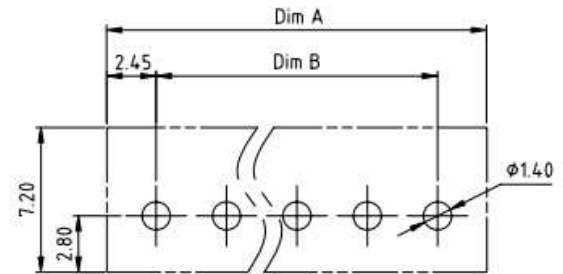

RECOMMENDED P.C.B LAYOUT
TOP VIEW

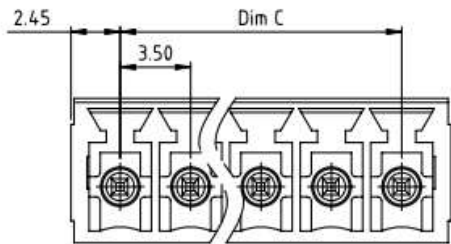
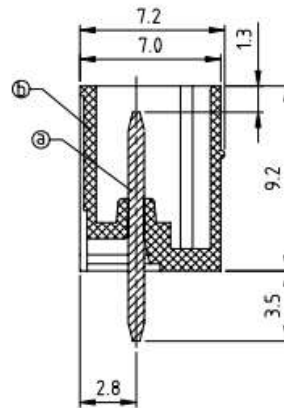
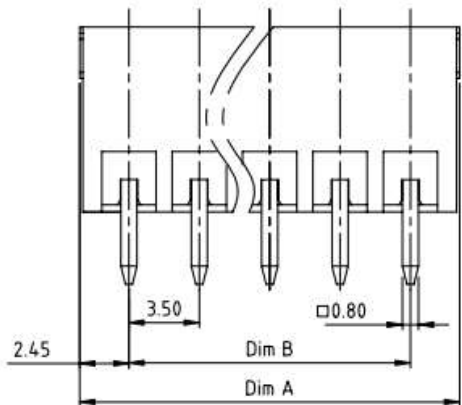

Material:

- Item ③ Male contact pin: Copper Tin plated
- Item ⑤ Terminal housing: Thermoplastic (UL94V-0)

Electrical: cULus /VDE

- Voltage rating: 300V/300V
- Current rating: 10A/10.5A
- Withstanding Voltage: 1.6 KV/2.5KV
- Operating temperature: -40°C to +115°C
- Soldering temperature: 260°C±5°C/5 Sec
- Safety Approval: us

DIMENSION

Dim A	(N-1)×3.5+4.90
Dim B&C	(N-1)×3.5

N= NUMBER OF POLES

Poles	Tolerance
2P-6P	±0.15
7P-12P	±0.20
13P-18P	±0.25
19P-24P	±0.30

PART NO.: OQ xx 1 2 x 0 00J0 G

No. of poles	0	Black (RAL9005)	RoHS compliant (lead<4%) In copper Alloy
02 2 poles	2	Red (RAL3001/D)	
03 3 poles	3	Orange(RAL2011/P)	
...	4	Yellow(RAL1018/A)	
24 24 poles	5	Green(RAL6018/T)	
	6	Blue (RAL5015/A)	
	8	Grey(RAL7035/D)	
	9	White(RAL1102)	
	C	Green(RAL6018/U)	

mat'l. code	surface ASME Y14.5 ✓	tolerance ASME Y14.5	projection 	product family TERMINAL BLOCK
ltr	ecn no	dr	date	title TERMINAL BLOCK PLUGGABLE SOCKET,VERTICAL
				scale MM
	angles	linear		dwg no OQxx12x000J0G
	X±0.5	X.X±0.3		sheet 1 of 1 size A4
	X'±1'	X.XX±0.1		type CUSTOMER Drawing
	dr	HANKE FENG	032614	
	enr	HANKE FENG	032614	
	chr	SHI JUN	032614	
	appd	SHI JUN	032614	
sheet index	revision sheet	A	1	