

Leiterplatten-Layout Vorschlag für SMT
PCB-Layout Proposal for SMT

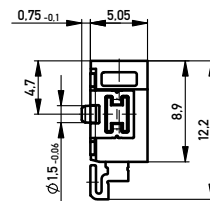
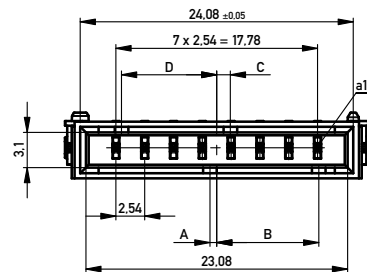
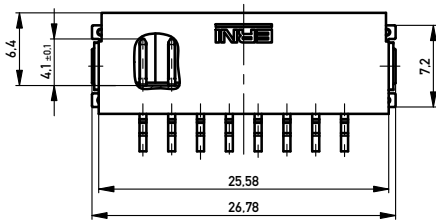
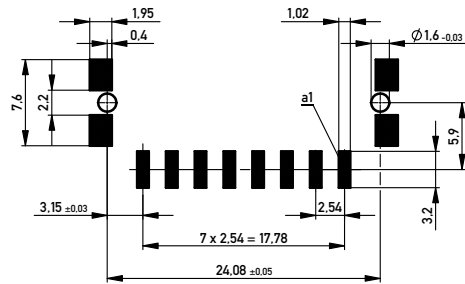

Anforderungsstufe 1
Performance Level 1

Kontaktbereich vergoldet
Mating Area gold plating

Anschlussbereich verzinkt 4-6 µm
Terminal Area 4-6 µm tin plating

Koplanarität der Anschlüsse ≤ 0,1 mm
Coplanarity Area of Termination ≤ 0,1 mm

Verpackt in Gurtverpackung
Tape on Reel Packaging
Verpackungseinheit: 440 Stück
Packaging unit: 440 pcs

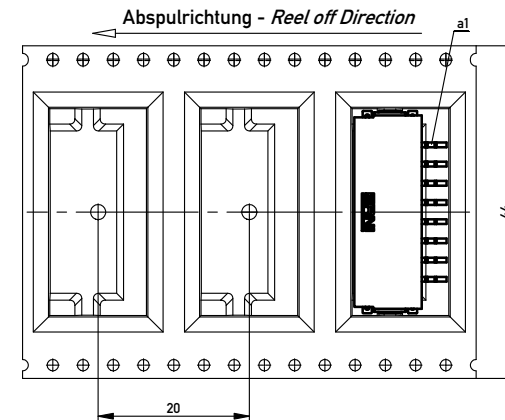
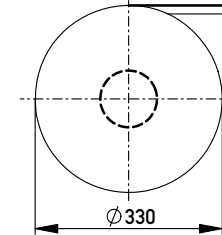

| | | | | | | | |
|-----------------------|---------------------|------------------|-----|-----|-----|-----|---|
| 454197 | | weiß white | 0,6 | 9 | 1,2 | 8,4 | Codierung wie Variante schwarz Encoding such variant black |
| 284124 | | rot red | 4,2 | 5,4 | 4,8 | 4,8 | |
| 284123 | | grün green | 3 | 6,6 | 3,6 | 6 | |
| 284122 | | blau blue | 1,8 | 7,8 | 2,4 | 7,2 | |
| 284121 | | schwarz black | 0,6 | 9 | 1,2 | 8,4 | |
| Ident-Nr. part-no. | Codierung coding | Farbe color | A | B | C | D | Bemerkung note |

| | | | | | |
|--|-----------|---|--|--------------------------------------|-----|
| Information: | | Tolerances | | Scale | 3:1 |
| All rights reserved. Only for Information. To ensure that this is the latest version of this drawing, please contact one of the ERNI companies before using. | | Subject to modification without prior notice. Drawing will not be updated. | | Designation M 2.54 SRC-A, 8-polig | |
| e | M 04.2013 | | | www.ERNI.com | |
| Index | Date | Class | | 224922 | |
| | | | | SRCA | |
| | | | | I A2 | |