

THIS DRAWING CONTAINS INFORMATION PROPRIETARY TO POSITRONIC AND IT'S SUBSIDIARIES. POSITRONIC BELIEVES THE DATA ON THIS DRAWING TO BE RELIABLE, SINCE THE TECHNICAL INFORMATION IS GIVEN FREE OF CHARGE, THE USER EMPLOYS SUCH INFORMATION AT HIS OWN DISCRETION AND RISK. POSITRONIC ASSUMES NO RESPONSIBILITY FOR RESULTS OBTAINED OR DAMAGES INCURRED FROM USE OF SUCH INFORMATION IN WHOLE OR IN PART.

DATE	REV	REVISION RECORD	APP	DR	CK
11-06-19	A	ECO 70604	RK	MS	AB

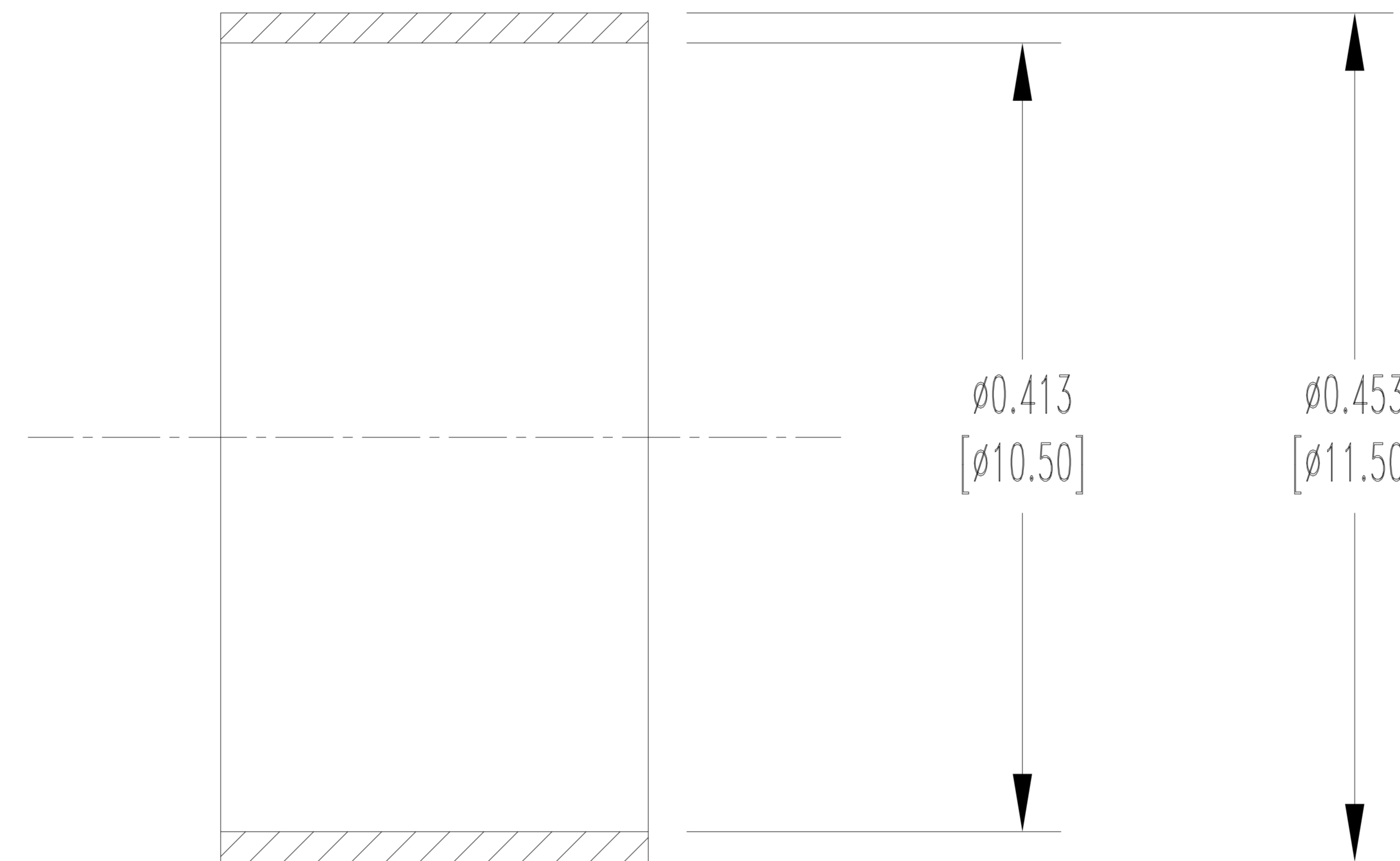

NOTES:

1. CRIMP FERRULE TO BE PURCHASED FROM INOTEC.
2. PART IS COMPLIANT PER CURRENT RoHS DIRECTIVE.
3. DIMENSIONS ARE IN INCHES [MILLIMETERS].

	<b>POSITRONIC INDUSTRIES INC.</b> SPRINGFIELD, MISSOURI 65801	
	SCALE N.T.S.	DRAWN BY MORE S. APPROVED BY RK
DECIMAL TOL. $\pm 0.015$ [0.38]	TITLE D SERIES	
ANGULAR TOL. $\pm 5^\circ$	DATE 11-06-19	
DRAWING NUMBER A4592-105-115-0		REV. A