

ITEM NUMBER	DESCRIPTION
1	CONNECTOR, SMA TYPE (SEE TABLE)/BRASS
2	PIN CHUCK, SMAM RG174, GOLD/BRASS
3	CRIMP RING RG174, (SEE TABLE)/BRASS
4	HEAT SHRINK, POLYOL, 2:1, BLACK

REVISIONS			
REV	DESCRIPTION	DATE	APPV
A	INITIAL RELEASE OF LINX INTERNAL DRAWING	MSCHULTE 21/JAN/19	DV 08/MAR/19

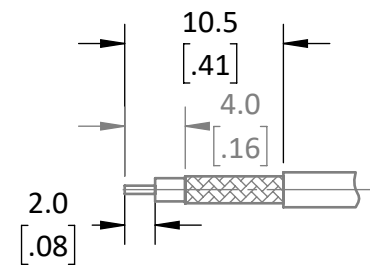
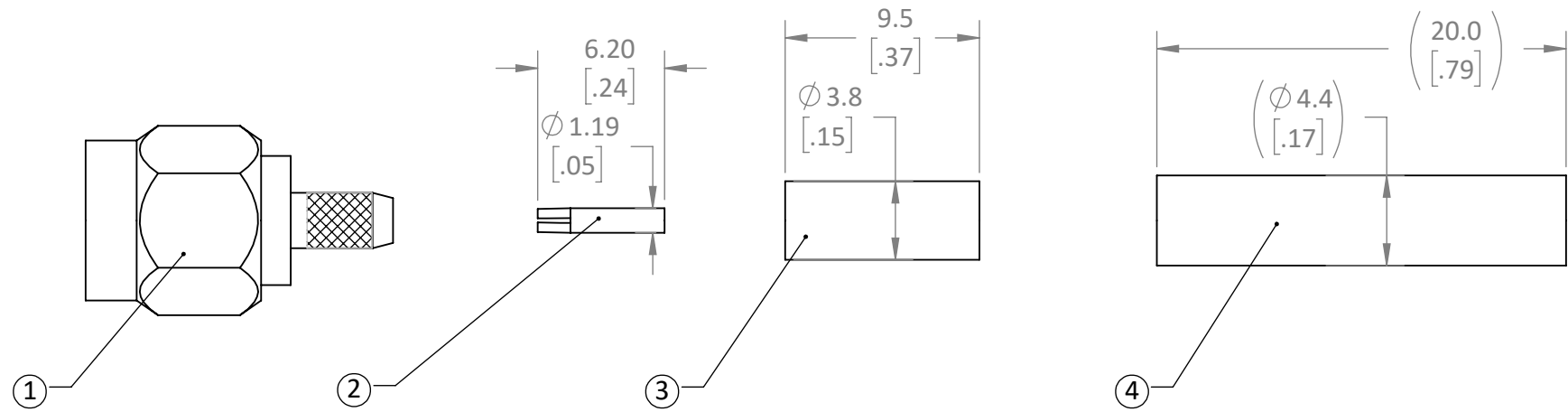
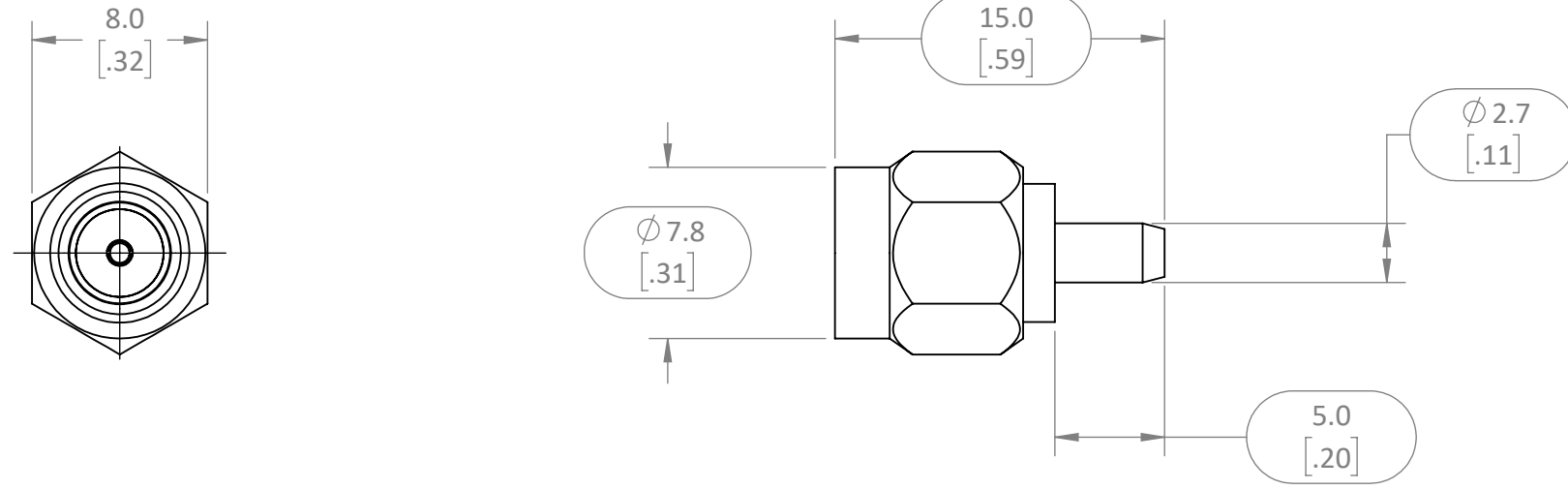

- NOTES: (UNLESS OTHERWISE SPECIFIED)
- ALL DIMENSIONS ARE IN MILLIMETERS [IN].
 - DIMENSIONS APPLY AFTER FINISHING.
 - MANUFACTURE TO BE COMPLIANT WITH EU RoHS DIRECTIVE, USE MATERIALS THAT DO NOT CONTAIN REACH SUBSTANCES OF VERY HIGH CONCERN >1000ppm, AND USE DRC CONFLICT-FREE SOURCED MATERIALS.
 - MECHANICAL PROPERTIES
 - DURABILTY: 500 CYCLES
 - RECCOMENDED TORQUE: 0.56 Nm [5.0in lbs]
 - TEMPERATURE RANGE: -55° - +155°C
 - CORROSION (SALT SPRAY): ASTM B-117
 - ELECTRICAL SPECIFICATIONS ARE LISTED FOR REFERENCE ONL SEE LINX DATA SHEET FOR ELECTRICAL PROPERTIES.
 - IMPEDANCE: 50Ω
 - INSERTION LOSS: .075xvf(GHz) [CONNECTOR]
 - PRODUCT QUALIFIED IAW LINX TEST PLAN AT CURRENT REVISION.
 - UNLISTED DIMENSIONS ARE CONTROLLED BY SOLID MODEL AT LATEST REVISION.
 - PACKAGE KITS INDIVIDUALLY AND PLACE IN LOT BAGS.
 - LABEL LOT BAGS AND BOXES IAW LINX LABEL DRAWING [MEC-LBL-4x2.5-PAPER-ID]

ASSEMBLY INSTRUCTIONS

- Strip the cable to the recommended dimensions.
- Slip heat shrink and crimp ring onto stripped cable.
- Solder the socket at the center-conductor.
- Insert the socket, center conductor and insulator into the body until the top of the socket is flush with the white insulation in the body.
- Wrap the braid around the tail of the body and crimp the ring with a 0.128" hex crimp tool, (or one labeled for use with RG-174 cable)
- Use heat shrink to cover crimp.

RECOMMENDED CABLE STRIPPING DIMENSIONS CAN ALSO BE USED WITH RG-188 & RG-316

ITEM NUMBER	FINISH
CONREVSMA007	NICKEL
CONREVSMA007-G	GOLD

WARNING: THIS DRAWING CONTAINS PROPRIETARY INFORMATION THAT IS THE SOLE PROPERTY OF LINX TECHNOLOGIES, AND SHALL BE TREATED AS SUCH. NO DISCLOSURE OR REPRODUCTION OF THIS DOCUMENT IS PERMITTED, IN WHOLE OR IN PART, WITHOUT THE EXPRESS WRITTEN PERMISSION OF LINX TECHNOLOGIES OR ITS DESIGNATED AGENTS.

STE 159 ORT LANE
MERLIN, OR 97532
connectivity

MATERIAL:	INTERPRET DIMENSIONS AND TOLERANCES PER ASME Y14.5.	PROJECTION:
WEIGHT:	.X ±2.0 .XX ±1.00 .XXX ±.500	ANGLES: ±1° SURFACE: ✓
FINISH: VAR	DRAWN: MSCHULTE ENGR: DASARATHAN	DT: 7/27/2022 DT: 10-JUL-08

TITLE: SMA MALE CABLE END CRIMP FOR COAX CABLE		REV A
SIZE B	DWG. NO. C-CONREVSMA007-X	
SCALE: 3:1	DO NOT SCALE DRAWING	SHEET 1 OF 1