

Top View of Assembly

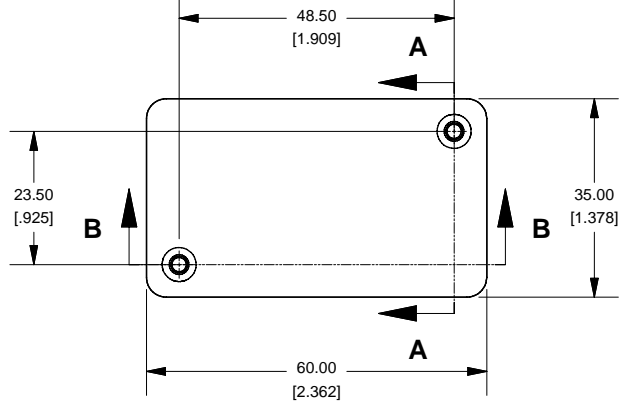

SECTION A-A End View of Assembly

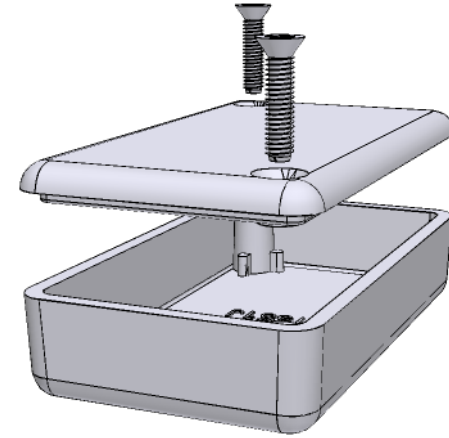
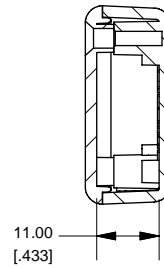

SECTION B-B Side View of Assembly

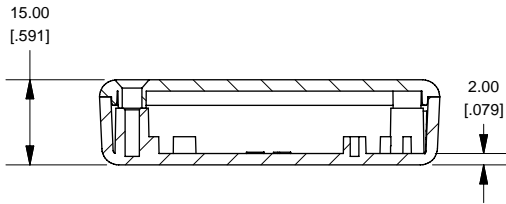

Top View Looking Inside Box

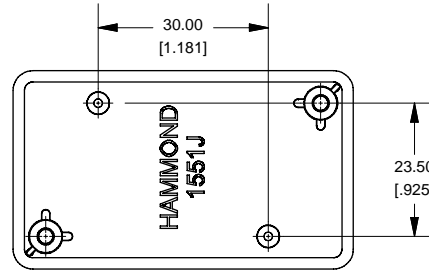

SECTION C-C Boss Heights

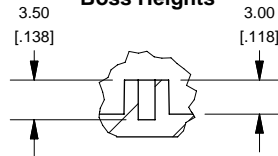

Lid

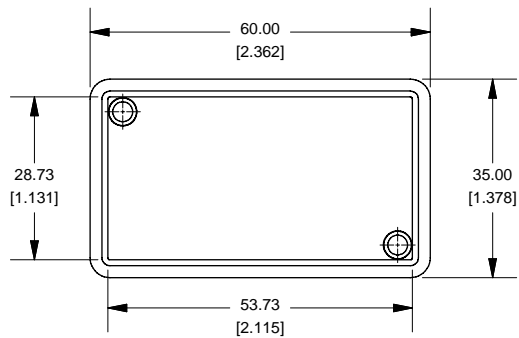

Maximum P.C. Board Size

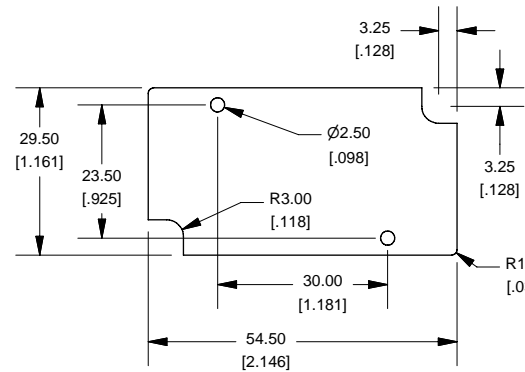

NOTE

Purchased assembly includes lid and box made from GP ABS material and cover screws.

1551J	
1551J Flange Enclosure	
Black Enclosure - RAL 7001 - UL94 - HB	1551JHBK
Gray Enclosure - RAL 7035 - UL94 - HB	1551JGY
Translucent Blue - UL94 - HB	1551JTBU
ACCESSORIES	
Black Enclosure Cover Screws (Pkg 100) (#4 X 1/2" Self Tapping)	1591TS100BK
Gray Enclosure Cover Screws (Pkg 100) (#4 X 1/2" Self Tapping)	1591TS100
P.C. Board Screws (Pkg 100) (32 x 3/16" Self Tapping)	1551ATS100

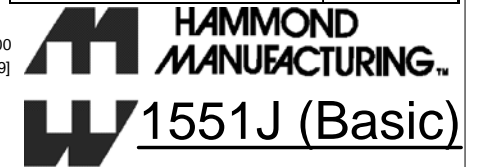

www.hammondmfg.com