

NOTES:

1. MATERIAL:
 - 1.1. PLASTIC: NYLON PA46, UL94V-2.
COLOR: BLACK. HALOGEN FREE.
 - 1.2. INSERT MOLDING: LCP, UL94V-0.
 - 1.3. TERMINAL: COPPER ALLOY.
 - 1.4. SHIELD SHELL: STAINLESS STEEL.
2. PLATING:
 - 2.1. TERMINAL:
 - 2.1.1. UNDERPLATING: NICKEL 1.30 MICROMETER MIN.
 - 2.1.2. CONTACT AREA: GOLD 0.76 MICROMETER MIN.
 - 2.1.3. SOLDER AREA: MATTE TIN 2.50 MICROMETER MIN.
 - 2.2. METAL SHELL:
 - SOLDERABLE NICKEL 1.30 MICROMETER MIN.
3. PRODUCT SPECIFICATION: PS-105081-001.
4. PACKAGING SPECIFICATION ACCORDING TO SPECIFIED P/N.
5. THIS PRODUCT COMPLIANT TO RoHS DIRECTIVE 2002/95/EC, AND ELV DIRECTIVE 2000/53/EC.
6. RECOMMENDED APPLIED PWB THICKNESS SEE TABLE.

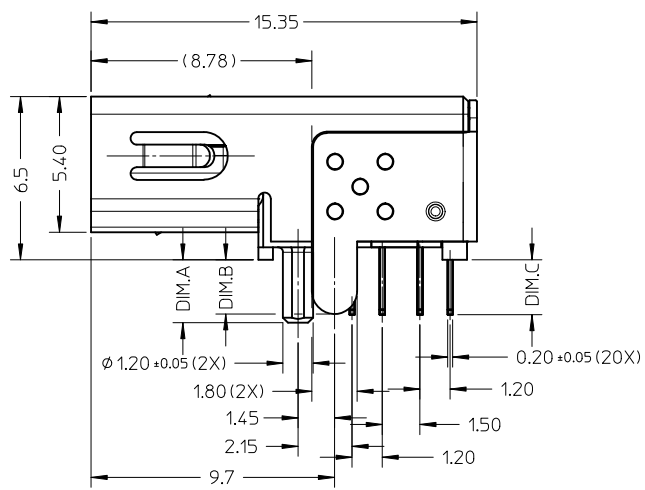
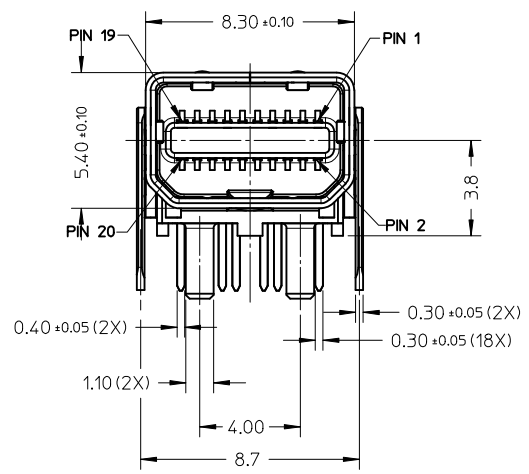

105081-3001	2.0	1.8	1.8	1.20±0.10	WITHOUT	PK-105081-002 (TAPE & REEL)
105081-2001	2.5	2.2	2.2	1.60±0.10		
105081-1001	2.0	1.8	1.8	1.20±0.10	WITH	PK-105081-001 (TRAY)
105081-0001	2.5	2.2	2.2	1.60±0.10		
105081-5001						
PART NUMBER	DIM.A	DIM.B	DIM.C	PWB THICK.	COVER	PACKAGING SPEC.

REVISED
 EC NO: SH2010-0117
 DRW:KWEI 2010/03/31
 CHK:DZHANG 2010/03/31
 APPR:RZHANG 2010/08/11

QUALITY SYMBOLS
 $F_A=0$
 $F_B=0$
 $F_C=0$

GENERAL TOLERANCES (UNLESS SPECIFIED)

	mm	INCH
4 PLACES	± ---	± ---
3 PLACES	± ---	± ---
2 PLACES	± 0.25	± ---
1 PLACE	± 0.30	± ---
ANGULAR ± ---°		

DRAFT WHERE APPLICABLE
 MUST REMAIN WITHIN DIMENSIONS

DIMENSION STYLE
MM ONLY

DRAWN BY	DATE
KLAUS WEI	2008/10/06
CHECKED BY	DATE
ROST ZHANG	2008/10/06
APPROVED BY	DATE
HARVEY WANG	2008/10/06

MATERIAL NO.
105081-001

SCALE 5:1	DESIGN UNITS METRIC	THIRD ANGLE PROJECTION
TITLE CUSTOMER DRAWING FOR R/A MINI-DP RECEPT.		
MOLEX INCORPORATED		DOCUMENT NO. SD-105081-001
THIS DRAWING CONTAINS INFORMATION THAT IS PROPRIETARY TO MOLEX INCORPORATED AND SHOULD NOT BE USED WITHOUT WRITTEN PERMISSION		SHEET NO. 1 OF 2

	10	9	8	7	6	5	4	3	2	1
	TOP ROW			BOTTOM ROW						
F	PIN NUMBER	SIGNAL TYPE	PIN NAME	PIN NUMBER	SIGNAL TYPE	PIN NAME				
	1	GND	GROUND	2	IN	HOT PLUG DETECT				
	3	OUT	ML_LANE 0 (p)	4	CONFIG	CONFIG 1				
	5	OUT	ML_LANE 0 (n)	6	CONFIG	CONFIG 2				
	7	GND	GROUND	8	GND	GROUND				
	9	OUT	ML_LANE 1 (p)	10	OUT	ML_LANE 3 (p)				
	11	OUT	ML_LANE 1 (n)	12	OUT	ML_LANE 3 (n)				
E	13	GND	GROUND	14	GND	GROUND				
	15	OUT	ML_LANE 2 (p)	16	I/O	AUX_CH (p)				
	17	OUT	ML_LANE 2 (n)	18	I/O	AUX_CH (n)				
	19	RTN	RETURN	20	POWER OUT	DP_POWER				

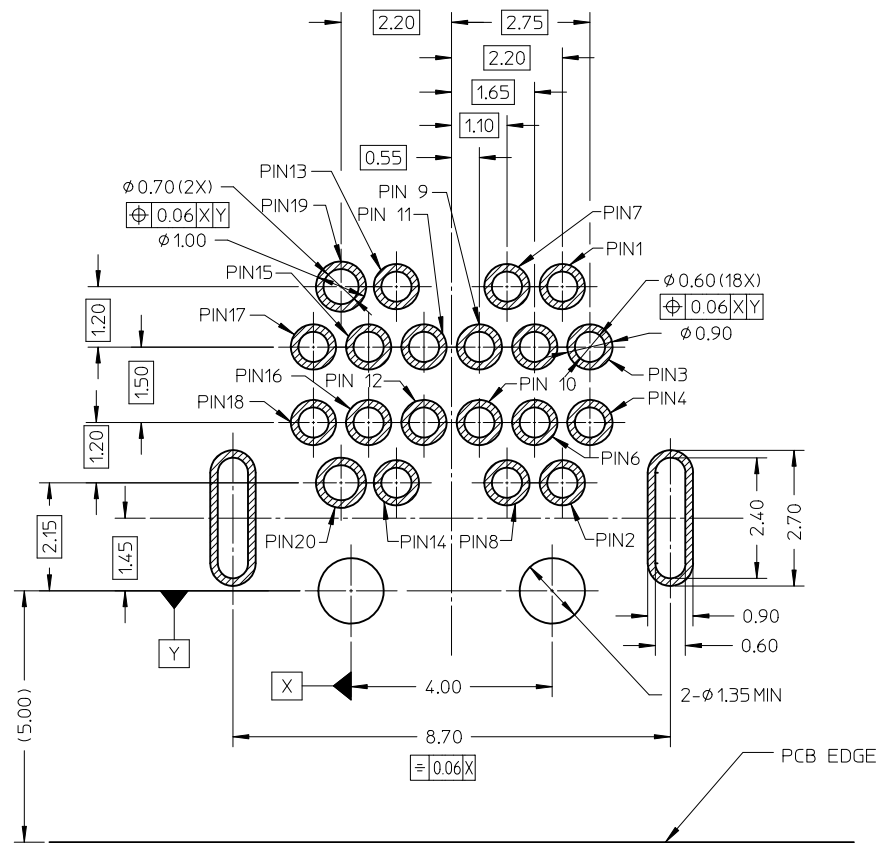
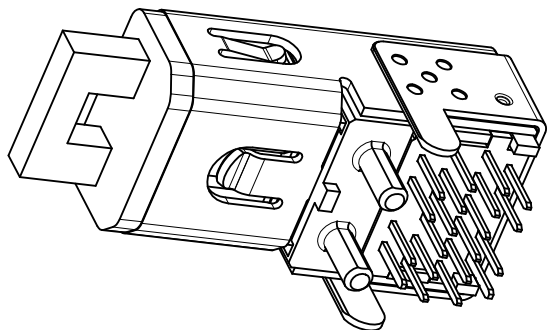

RECOMMENDED PCB LAYOUT
DEFAULT TOLERANCE ±0.05

REVISED EC NO: SH2010-0117 DRW:KWEI CHK:RZHANG APP:RZHANG	DESCRIPTION REV	2010/03/31	2010/03/31	2010/08/11	QUALITY SYMBOLS F _A =0 F _G =0 F _P =0	GENERAL TOLERANCES (UNLESS SPECIFIED)		DIMENSION STYLE MM ONLY		SCALE 5:1	DESIGN UNITS METRIC	THIRD ANGLE PROJECTION		
						mm	INCH	DRAWN BY KLAUS WEI	DATE 2008/10/06	TITLE CUSTOMER DRAWING FOR R/A MINI-DP RECEPT.				
						4 PLACES	± ---	± ---	CHECKED BY ROST ZHANG	DATE 2008/10/06	MATERIAL NO. 105081- *001			
						3 PLACES	± ---	± ---	APPROVED BY HARVEY WANG	DATE 2008/10/06	DOCUMENT NO. SD-105081-001			
			2 PLACES	± 0.05	± ---	ANGULAR ± ---°		DRAFT WHERE APPLICABLE MUST REMAIN WITHIN DIMENSIONS		MOLEX INCORPORATED		SHEET NO. 2 OF 2		
			1 PLACE	± 0.10	± ---					THIS DRAWING CONTAINS INFORMATION THAT IS PROPRIETARY TO MOLEX INCORPORATED AND SHOULD NOT BE USED WITHOUT WRITTEN PERMISSION				

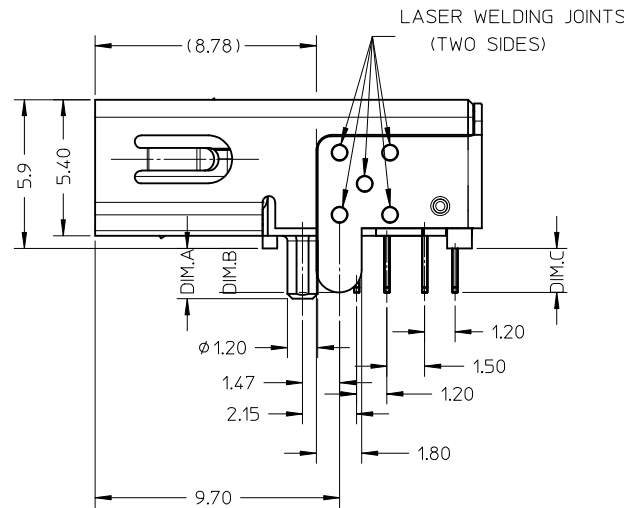
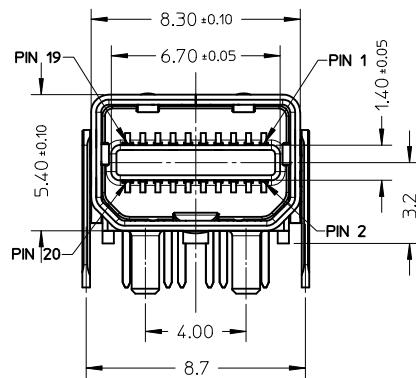
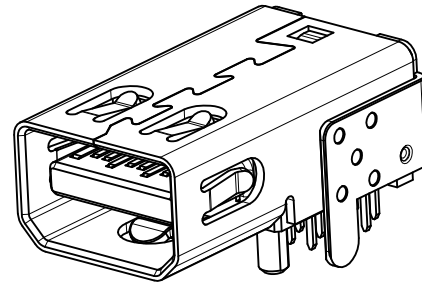
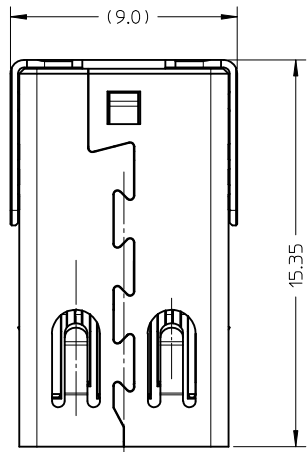

NOTES:

1. MATERIAL:
 - 1.1. PLASTIC: NYLON PA46, UL94V-2, COLOR: BLACK, HALOGEN FREE.
 - 1.2. INSERT MOLDING: LCP, UL94V-0.
 - 1.3. TERMINAL: COPPER ALLOY.
 - 1.4. SHIELD SHELL: STAINLESS STEEL.
2. PLATING:
 - 2.1. TERMINAL:
 - 2.1.1. UNDERPLATING: NICKEL 1.30 MICROMETER MIN.
 - 2.1.2. CONTACT AREA: GOLD 0.38 MICROMETER MIN.
 - 2.1.3. SOLDER AREA: MATTE TIN 2.50 MICROMETER MIN.
 - 2.2. METAL SHELL: SOLDERABLE NICKEL 1.30 MICROMETER MIN.
3. PRODUCT SPECIFICATION: PS-105081-001.
4. PACKAGING SPECIFICATION ACCORDING TO SPECIFIED P/N.
5. THIS PRODUCT COMPLIANT TO RoHS DIRECTIVE 2002/95/EC, AND ELV DIRECTIVE 2000/53/EC.
6. RECOMMENDED APPLIED PWB THICKNESS SEE TABLE.

105081-4001	2.0	1.75	1.75	1.20±0.10	PK-105081-002 (TRAY)
105081-6001	2.5	2.18	2.18	1.60±0.10	
PART NUMBER	DIM.A	DIM.B	DIM.C	PWB THICK.	PACKAGING SPEC.

NEW PRODUCT
 EC NO: SH2011-0039
 DRW:KWEI
 CHKD:
 APPR:RZHANG
 2010/08/04
 2010/11/19

QUALITY SYMBOLS

 DESCRIPTION
 REV

GENERAL TOLERANCES (UNLESS SPECIFIED)	
	mm INCH
4 PLACES	± --- ± ---
3 PLACES	± --- ± ---
2 PLACES	± 0.25 ± ---
1 PLACE	± 0.30 ± ---
ANGULAR ± ---°	
DRAFT WHERE APPLICABLE MUST REMAIN WITHIN DIMENSIONS	

DIMENSION STYLE	
MM ONLY	
DRAWN BY	DATE
KLAUS WEI	2008/10/06
CHECKED BY	DATE
ROST ZHANG	2008/10/06
APPROVED BY	DATE
RZHANG	2010/11/19
MATERIAL NO.	
105081-*001	
SIZE	
A3	

SCALE	DESIGN UNITS	THIRD ANGLE PROJECTION
5:1	METRIC	
TITLE		
CUSTOMER DRAWING FOR R/A MINI-DP RECEPT. LOWER HEIGHT		
MOLEX INCORPORATED		
MATERIAL NO.	DOCUMENT NO.	SHEET NO.
105081-*001	SD-105081-002	1 OF 2
THIS DRAWING CONTAINS INFORMATION THAT IS PROPRIETARY TO MOLEX INCORPORATED AND SHOULD NOT BE USED WITHOUT WRITTEN PERMISSION		

TOP ROW			BOTTOM ROW		
PIN NUMBER	SIGNAL TYPE	PIN NAME	PIN NUMBER	SIGNAL TYPE	PIN NAME
1	GND	GROUND	2	IN	HOT PLUG DETECT
3	OUT	ML_LANE 0 (p)	4	CONFIG	CONFIG 1
5	OUT	ML_LANE 0 (n)	6	CONFIG	CONFIG 2
7	GND	GROUND	8	GND	GROUND
9	OUT	ML_LANE 1 (p)	10	OUT	ML_LANE 3 (p)
11	OUT	ML_LANE 1 (n)	12	OUT	ML_LANE 3 (n)
13	GND	GROUND	14	GND	GROUND
15	OUT	ML_LANE 2 (p)	16	I/O	AUX_CH (p)
17	OUT	ML_LANE 2 (n)	18	I/O	AUX_CH (n)
19	RTN	RETURN	20	POWER OUT	DP_POWER

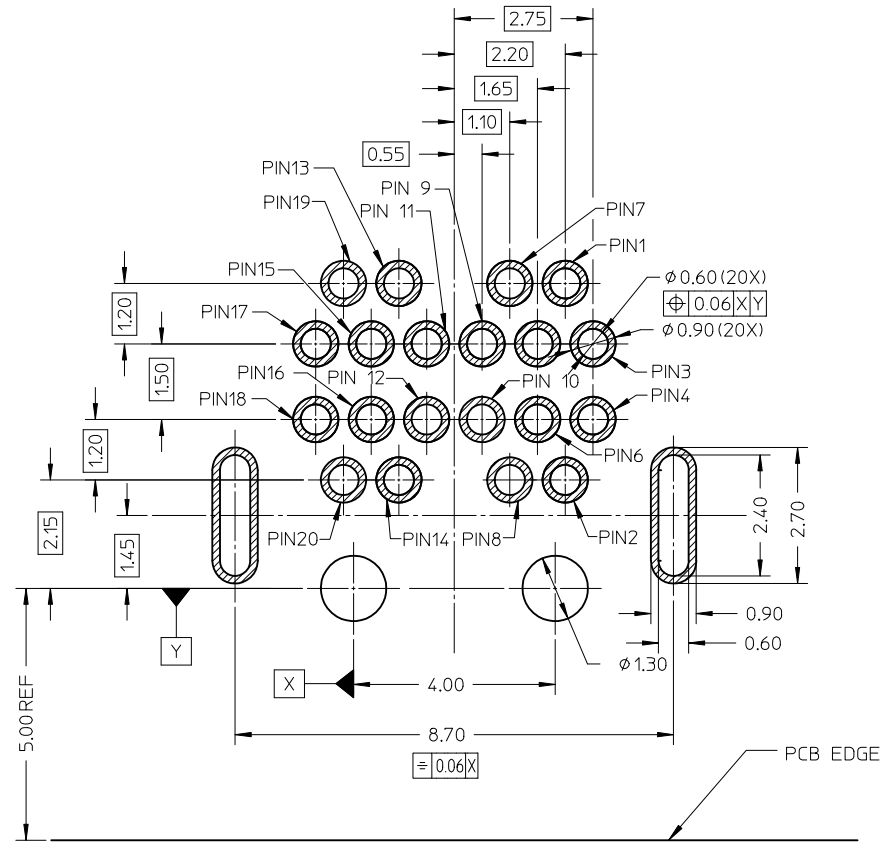
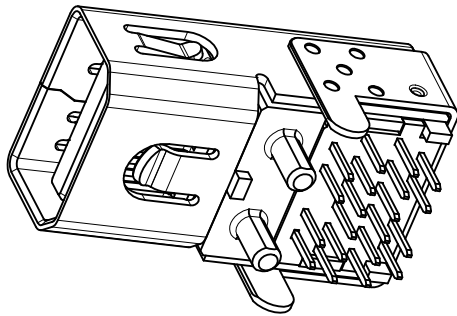

RECOMMENDED PCB LAYOUT
DEFAULT TOLERANCE ±0.05

NEW PRODUCT EC NO: SH2011-0039 DRW/K: CWEI CHK/D: RZHANG APPR: RZHANG 2010/08/04 2010/11/19	DESCRIPTION REV	QUALITY SYMBOLS	GENERAL TOLERANCES (UNLESS SPECIFIED)	DIMENSION STYLE	SCALE	DESIGN UNITS	THIRD ANGLE PROJECTION
		$\nabla=0$ $\square=0$	mm INCH 4 PLACES ± --- ± --- 3 PLACES ± --- ± --- 2 PLACES ±0.05 ± --- 1 PLACE ±0.10 ± --- ANGULAR ± ---°	MM ONLY	5:1	METRIC	
			DRAFT WHERE APPLICABLE MUST REMAIN WITHIN DIMENSIONS	DRAWN BY: KLAUS WEI CHECKED BY: ROST ZHANG APPROVED BY: RZHANG MATERIAL NO.: 105081- *001	DATE: 2008/10/06 DATE: 2008/10/06 DATE: 2010/11/19	TITLE	CUSTOMER DRAWING FOR R/A MINI-DP RECEPT. LOWER HEIGHT MOLEX INCORPORATED
				SIZE: A3 THIS DRAWING CONTAINS INFORMATION THAT IS PROPRIETARY TO MOLEX INCORPORATED AND SHOULD NOT BE USED WITHOUT WRITTEN PERMISSION	DOCUMENT NO.: SD-105081-002 SHEET NO.: 2 OF 2		