

# XVC6B4

tower light 60 mm 24 V steady LED - blue/  
green/orange/red

## Main

Range of product	Harmony XVC6
Product or component type	Complete pre-wired monolithic tower light
Beacon or indicator bank unit type	4 illuminated units
Sound signalling	Without
Mounting diameter	60 mm
Component name	XVC
Light source	Blue LED steady Green LED steady Orange LED steady Red LED steady
[Us] rated supply voltage	24 V
Supply circuit type	AC/DC

## Complementary

Material	Polycarbonate (illuminated unit) ABS (acrylonitrile butadiene-styrene) (base unit) PBT + ABS (UL94HB) (top cover) STK (chromium-plated) (support tube)
Product mounting	On support tube, 22 mm
Cable cross section	0.33 mm <sup>2</sup>
AWG gauge	22
Cable length	600 mm
Marking	CE
[Uimp] rated impulse withstand voltage	0.8 kV
Current consumption	100 mA
Flashing frequency	1 Hz
Product weight	0.82 kg
Height	548.3 mm

## Environment

Standards	EN/IEC 61000-6-2 EN/IEC 61000-6-3 EN/IEC 61000-6-4
Product certifications	UL
Protective treatment	TC
Ambient air temperature for storage	-35...70 °C
Ambient air temperature for operation	-10...50 °C
Class of protection against electric shock	Class I conforming to EN/IEC 61140
IP degree of protection	IP23 in vertical surface installation conforming to EN/IEC 60529 IP54 in flat surface installation conforming to EN/IEC 60529
RoHS EUR status	Compliant
RoHS EUR conformity date	0808

The information provided in this documentation contains general descriptions and/or technical characteristics of the performance of the products contained herein. This documentation is not intended as a substitute for and is not to be used for determining suitability or reliability of these products for specific user applications. It is the duty of any such user or integrator to perform the appropriate and complete risk analysis, evaluation and testing of the products with respect to the relevant specific application or use thereof. Neither Schneider Electric Industries SAS nor any of its affiliates or subsidiaries shall be responsible or liable for misuse of the information contained herein.

Pre-assembled and Pre-wired Tower Light with Support Tube Mounting

Dimensions

Below drawing shows the maximum configuration of the product. Select the number of stages according to the product characteristics in order to get b dimension.

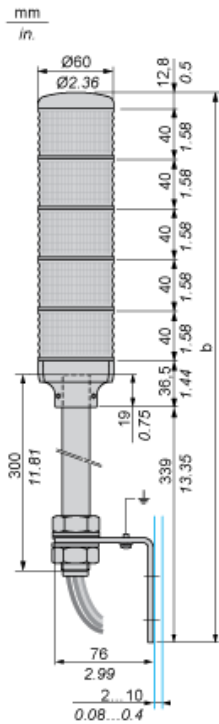

No. of illuminated units	b Without buzzer (mm)	b Without buzzer (in.)
1 stage	428.3	16.86
2 stages	468.3	18.44
3 stages	508.3	20.01
4 stages	548.3	20.01
5 stages	588.3	23.16

---

Pre-assembled and Pre-wired Tower Light

---

Support Tube Mounting

