

REV.	MODIFICATION.	DATE	DRN
01	NEW DRAWING	18/10/04	NJB
02	ECN05-026	03/02/05	OW
03	ECN05-056	27/04/05	OW
04	ECN06-227	03/10/06	NJB

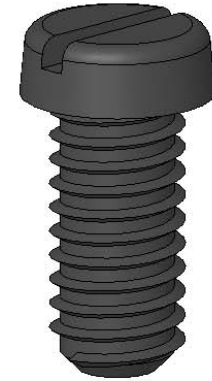
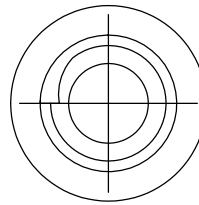
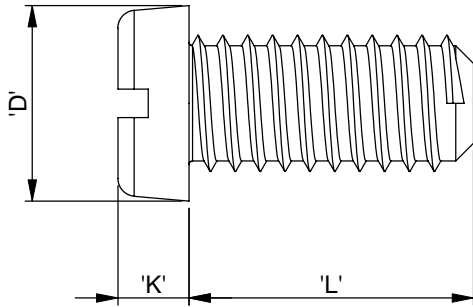

NOTES:
 1a) Metric primary units:mm.
 b) Imperial secondary units: [Inches].

NSE-1207-M6-L	6.0 8.0 10.0 12.0 16.0 20.0 25.0 30.0 40.0 50.0 [.236] [.315] [.394] [.473] [.630] [.788] [.985] [.182] [.575] [.969]	10.0 [.394]	3.9 [.153]
NSE-1207-M5-L	6.0 8.0 10.0 12.0 16.0 20.0 25.0 30.0 40.0 [.236] [.315] [.394] [.473] [.630] [.788] [.985] [.182] [.575]	8.5 [.334]	3.3 [.129]
NSE-1207-M4-L	6.0 8.0 10.0 12.0 16.0 20.0 25.0 30.0 40.0 [.236] [.315] [.394] [.473] [.630] [.788] [.985] [.182] [.575]	7.0 [.275]	2.6 [.102]
NSE-1207-M3-L	4.0 5.0 6.0 8.0 10.0 12.0 16.0 20.0 25.0 30.0 [.158] [.197] [.236] [.315] [.394] [.473] [.630] [.788] [.985] [.182]	5.5 [.216]	2.0 [.078]
NSE-1207-M2.5-L	6.0 8.0 10.0 12.0 15.0 20.0 25.0 [.236] [.315] [.394] [.473] [.591] [.788] [.985]	4.5 [.177]	1.8 [.070]
NSE-1207-M2-L	4.0 5.0 6.0 8.0 10.0 12.0 16.0 20.0 25.0 [.158] [.197] [.236] [.315] [.394] [.473] [.630] [.788] [.985]	3.8 [.149]	1.4 [.055]
PART REF:	L	D	K

INFORMATION CONTAINED IN THIS DOCUMENT IS CONFIDENTIAL TO RICHCO INTERNATIONAL Co. Ltd. AND MAY NOT BE DISCLOSED OR REPRODUCED IN WHOLE OR PART WITHOUT THEIR WRITTEN CONSENT



GENERAL TOLERANCES ±0.25 [0.010]
 ARE FOR REFERENCE UNLESS OTHERWISE
 1 DECIMAL PLACE ±
 2 DECIMAL PLACES ±
 ANGULAR ±1°

MATERIAL: NYLON 6/6 (RMS-179)		COLOUR: NATURAL	
TITLE: METRIC SCREW (DIN EN ISO 1207)		PART No: NSE-1207-MX-L	
DRG No: 04-114	NPR REF:		SIZE A4
DRN NJB	DATE 18/10/04	CHKD I.C	DATE 18/10/04
SCALE NTS		SHEET No 1 OF 1	