

**14-810.918 - Buzzer**

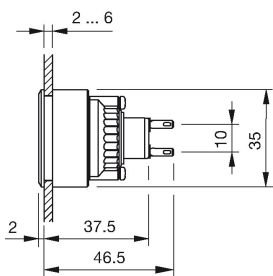

*Attention: The preview is based on a sample product. This can differ from your current configuration.*

**Dimensions**



**Mounting cut-outs**

**Mounting**

Mounting cut-out  $\varnothing$  30.5 mm  
 Mounting style flush mounting

**Front**

Front shape round  
 Front dimension  $\varnothing$  35 mm  
 Front cap material Aluminium  
 Front cap colour natural

**Other Attributes**

Weight 0.016 kg  
 Operating voltage 24 V DC

**IP-Rating**

Front protection IP 40

**Connection Method**

Terminal Solder 2.8 x 0.5 mm

**Function**

Buzzer

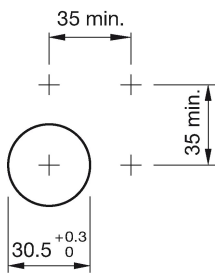

**Wiring diagram**

