

IEC Appliance Inlet C8, Screw-on Mounting, Front Side, Solder or Quick-connect or Print Terminal



C8  
  
 70 °C



### Description

- Panel Mount:  
Screw-on mounting, front or rear-side
- Appliance Inlet, Pin temperature 70 °C, Protection class II
- Solder, Quick Connect or PCB Terminal

### Approvals

- VDE Certificate Number: 40002274
- UL File Number: E96454
- CSA File Number: 27324

### References

#### Weblinks

[pdf](#), [html](#), [General Product Information](#), [Approvals](#), [RoHS](#), [CHINA-RoHS](#), [Mating Connectors](#), [e-Store](#), [SCHURTER-Stock-Check](#), [Distributor-Stock-Check](#), [Accessories](#)

### Technical Data

|                           |   |
|---------------------------|---|
| Ratings IEC               | 2.5 A / 250 VAC; 50 Hz  |
| Ratings UL/CSA            | 2.5 A / 250 VAC; 60 Hz  |
| Dielectric Strength       | > 4 kVAC between L-N<br>> 2 kVAC between L/N-PE<br>(1 min/50 Hz)  |
| Allowable Operation Temp. | -25 °C to 70 °C   |
| Degree of Protection      | from front side IP 20 acc. to IEC 60529                           |
| Protection Class          | Suitable for appliances with protection class 2 acc. to IEC 61140 |
| Panel Thickness s         | Screw<br>Mounting screw torque max 0 Nm                           |
| Material: Housing         | PA6, black / grey / white, UL 94V-0                               |

|                 |  |
|-----------------|--|
| Appliance Inlet | C8 acc. to IEC/EN 60320-1<br>UL 498, CSA C22.2 no. 42 (for cold conditions) pin-temperature 70 °C, 2.5 A, Protection Class 2 |
|-----------------|--|

### Dimensions

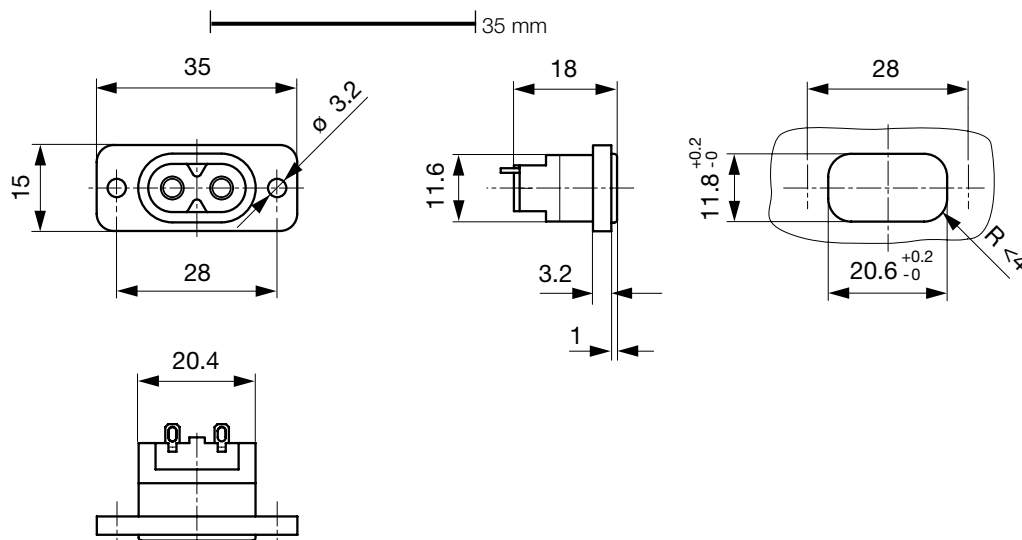

Length of the terminal please find at the order code configuration table

## Config. Code

2576 - H - A B C 0- D - E G F

The characters are placeholders for the correspondingly keys of selections from the key tables.

2576 - **H** - A B C 0- D - E G F = Type

| Type               | Configuration key |
|--------------------|-------------------|
| protection class 2 | B                 |

2576 - H - **A** B C 0- D - E G F = Terminals

| Terminal L                         | Configuration key |
|------------------------------------|-------------------|
| short solder terminal (L = 4.8 mm) | 2                 |
| long solder terminal (L = 8.5 mm)  | 3                 |
| PCB-terminal (short)               | 5                 |
| PCB-terminal (long)                | 6                 |
| Blade terminal (2.8 x 0.8 mm)      | 7                 |

2576 - H - A **B** C 0- D - E G F = Terminals

| Terminal N                         | Configuration key |
|------------------------------------|-------------------|
| short solder terminal (L = 4.8 mm) | 2                 |
| long solder terminal (L = 8.5 mm)  | 3                 |
| PCB-terminal (short)               | 5                 |
| PCB-terminal (long)                | 6                 |
| Blade terminal (2.8 x 0.8 mm)      | 7                 |

Symbols similar as in table A

2576 - H - A B **C** 0- D - E G F = Terminals

| Terminal Ground  | Configuration key |
|------------------|-------------------|
| without terminal | 0                 |

Symbols similar as in table A

2576 - H - A B C 0- **D** - E G F = Color

| Color                | Configuration key |
|----------------------|-------------------|
| jet black; RAL9005   | A                 |
| silver grey; RAL7001 | B                 |
| pure white; RAL9010  | D                 |

2576 - H - A B C 0- D - **E** G F = Style

| Style                     | Configuration key |
|---------------------------|-------------------|
| flange with through holes | 2                 |

2576 - H - A B C 0- D - E **G** F = Dimension X

| Dimension "X" | Configuration key |
|---------------|-------------------|
| 00            |                   |

The dimension "X" is displayed in ( $\frac{1}{10}$  mm). This information is also valid for the order code

2576 - H - A B C 0- D - E G **F** = Orientation of Terminals

| Orientation of Terminals | Configuration key |
|--------------------------|-------------------|
| horizontal               | A                 |
| vertical                 | B                 |

**Packaging unit** 100 Pcs

## Accessories

### Description

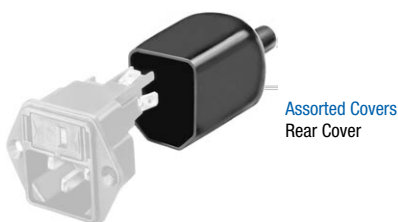

Assorted Covers  
Rear Cover

## Mating Outlets/Connectors

### Category / Description

[Power Cord Overview complete](#)



|   |      |
|---|------|
| Power Cord with IEC Connector C7, Straight 70°C | 2510 |
|---|------|

|  |      |
|--|------|
| Power Cord with IEC Connector C7, Angled | 2511 |
|--|------|

|                                     |      |
|-------------------------------------|------|
| Power Cord with IEC Plug C7, Angled | 2514 |
|-------------------------------------|------|

|   |      |
|---|------|
| Power Cord with IEC Connector C7, Straight 70°C | 4810 |
|---|------|

[Power Cord further types to 2576](#)