

Limit switches

For light to medium duty applications, type XCJ

References, characteristics

Type of operating head	Plunger (fixing by head or body)
------------------------	----------------------------------

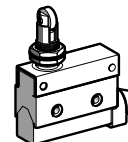
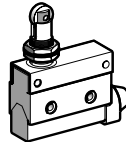
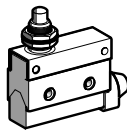

Type of operator	Steel end plunger	Steel roller plunger for lateral cam movement	Steel roller plunger for traverse cam movement
------------------	-------------------	---	--

References

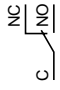
Single pole 1 C/O (form C)		XCJ-110	XCJ-102	XCJ-103
Masse (kg)		0.081	0.086	0.088

Complementary characteristics not shown under general characteristics (page 32702/3)

Switch actuation	On end	By 30° cam
Operating force (max.)	5.88 N	
Release force (min.)	0.98 N	
Operating frequency	120 operations per minute	
Maximum actuation speed	0.01 mm/s...50 cm/s (at pin plunger)	
Mechanical durability	10 x 10⁶ operations	
Cabling	M3 screw terminals (use cable lug with flexible cable) Maximum torque : 0.8 N.m	

Operating diagrams

Type of actuation

Operating diagrams

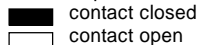
Contact operation

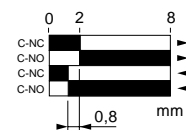
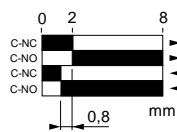
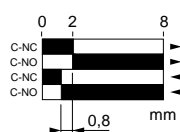
 ■ contact closed
 □ contact open



Limit switches

For light to medium duty applications, type XCJ

Dimensions

XCJ-110

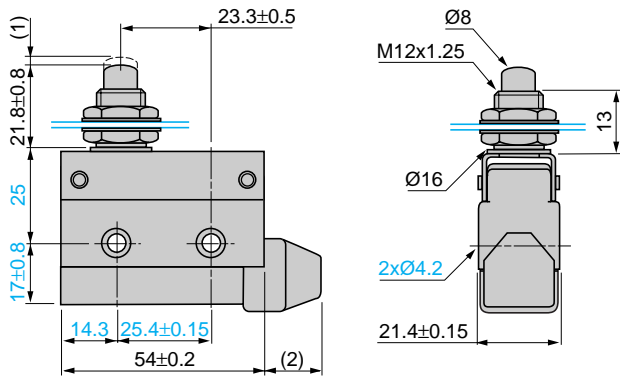

XCJ-102

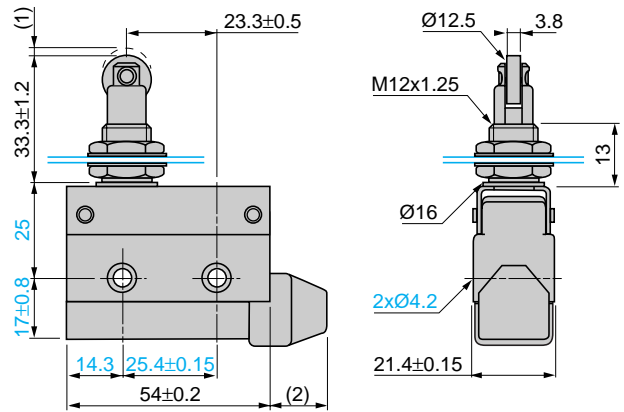

(1) 2 max.
(2) 16.5 max.

(1) 2 max.
(2) 16.5 max.

XCJ-103

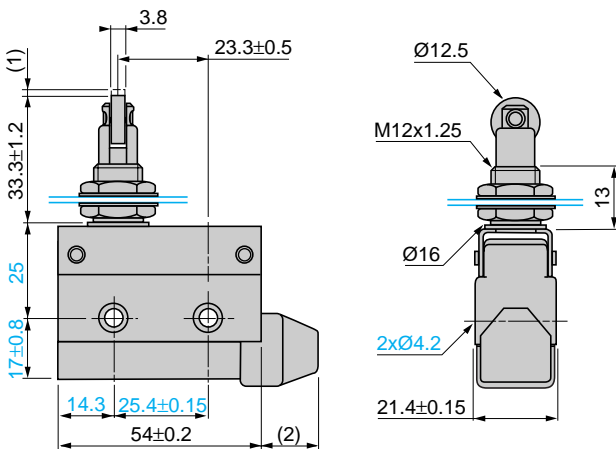

(1) 2 max.
(2) 16.5 max.

Limit switches

For light to medium duty applications, type XCJ

References, characteristics

Type of operating head	Plunger (fixing by body)
------------------------	--------------------------

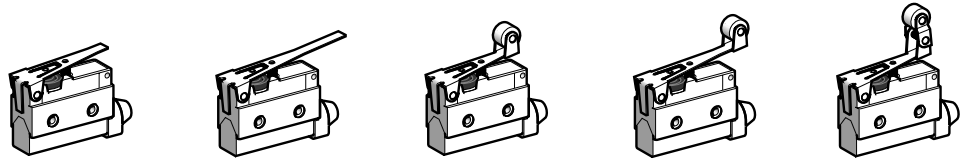

Type of operator	Short flat lever plunger	Long flat lever plunger	Short flat roller lever plunger	Long flat roller lever plunger	Short flat roller lever plunger, one way operation
------------------	--------------------------	-------------------------	---------------------------------	--------------------------------	--

References

Single pole 1 C/O (form C)		XCJ-125	XCJ-126	XCJ-127	XCJ-128	XCJ-121
Masse (kg)		0.052	0.053	0.057	0.057	0.059

Complementary characteristics not shown under general characteristics (page 32702/3)

Switch actuation	On end	By 30° cam			
Operating force (max.)	2.16 N	1.47 N	2.3 N	1.77 N	2.75 N
Release force (min.)	0.59 N	0.39 N	0.78 N	0.49 N	0.98 N
Operating frequency	120 operations per minute				
Maximum actuation speed	0.01 mm/s...50 cm/s (at pin plunger)				
Mechanical durability	10 x 10⁶ operations				
Cabling	M3 screw terminals (use cable lug with flexible cable) Maximum torque : 0.8 N.m				

Operating diagrams

Type of actuation

Operating diagrams

Contact operation

 contact closed
 contact open

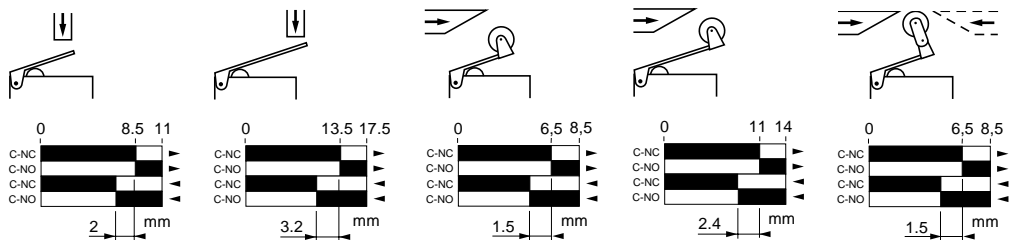

Limit switches

For light to medium duty applications, type XCJ

Dimensions

XCJ-125

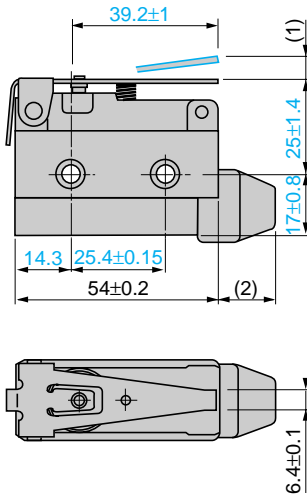

(1) 8.5 max.
(2) 16.5 max.

XCJ-126

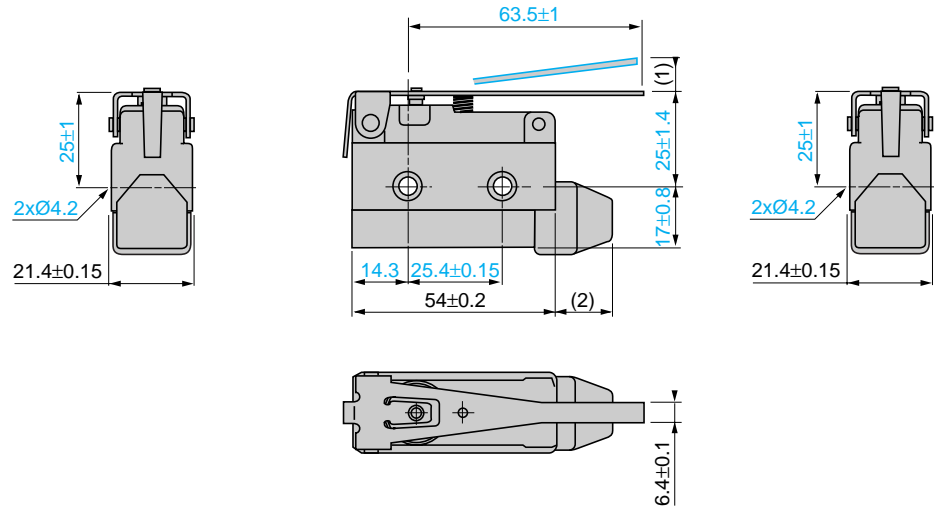

(1) 13.5 max.
(2) 16.5 max.

XCJ-127

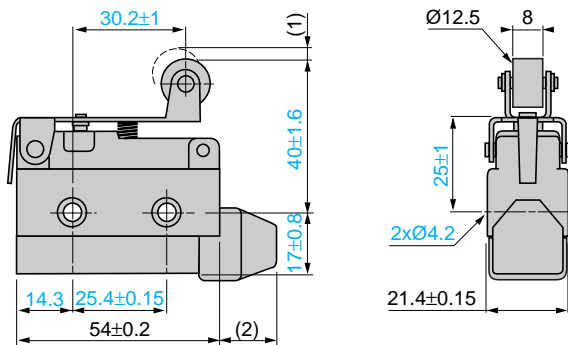

(1) 6.5 max.
(2) 16.5 max.

XCJ-128

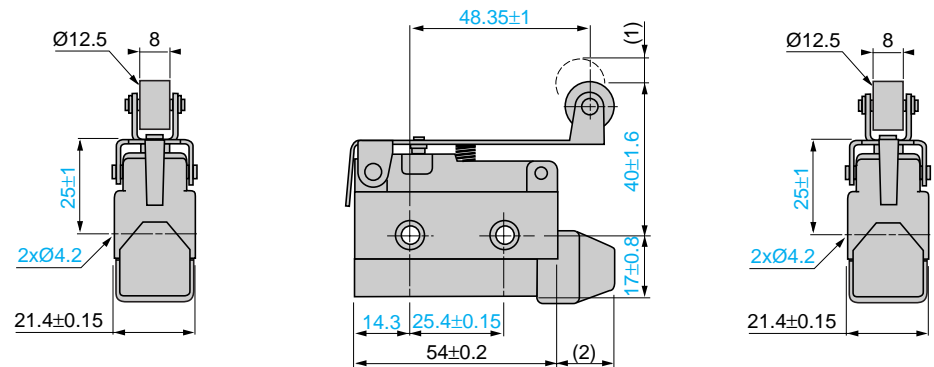

(1) 11 max.
(2) 16.5 max.

XCJ-121

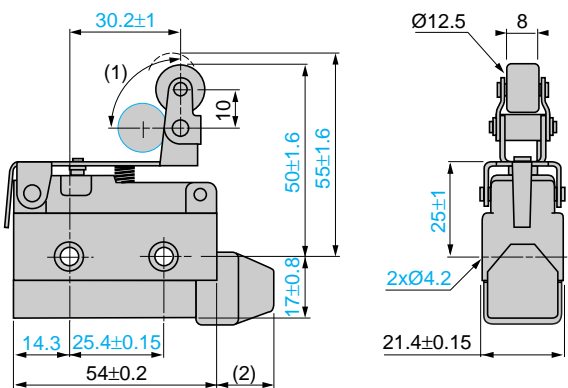

(1) 90° max.
(2) 16.5 max.