



EGN.1M.302.XLM

MECHANICAL DETAILS

Shell Style Model EG* : Fixed receptacle nut fixing

Keying 3 keys (beta=165, gamma=30, plug: male contacts, receptacle: female contacts)

Housing Material Environment friendly aluminium (nickel plated, anthracite color) shell and nut, other pieces bronze/brass

Cable Fixing 0 - 0 mm

Variant 2 :

	C	D	E	L	P	S1	e
Mm.	14.2	6.8	4.5	18.1	5.3	9.5	M11x1.0
In.	0.56	0.27	0.18	0.71	0.21	0.37	

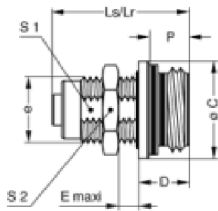

PERFORMANCE DETAIL

Insert :

Insulator Specifications

Contact Type: Crimp

Positioner: DCE.91.130.5MVM



OTHER CHARACTERISTICS

Shell Style/Model Libellé

Humidity (max): <=95% [at 60 deg C /140 F]

Vibration: 15 g [10 Hz - 2000 Hz]

Shock Resistance: 100 g [6 ms]

Operating -55°C/ +200°C

Climatical 15/200/21 (Al. shell)

Lighting strike EIA 10K amps - 6 times

EMI Shielding EIA - 1Ghz-80 dB,3GHz-70 dB,6GHz- 58dB

IP Rating 68

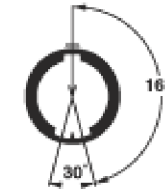

Available Download

[M_series.pdf](#)

Related links

- [Contact](#)
- [Quote Request](#)
- [Catalogs Downloads](#)
- [Catalogs Requests](#)
- [Sample Request](#)
- [3D drawings](#)