

Subminiature Fuse, 4.05 x 10 mm, Quick-Acting F, 250 VAC, 125 VDC



UL 248-14 · 250VAC · 125VDC · Quick-Acting F



### Description

- Low Breaking Capacity

### Standards

- UL 248-14  
- CSA C22.2 no. 248.14

### Approvals

- UL File Number: E42088

### References

[Packaging Details](#)

### Weblinks

[pdf-datasheet](#), [html-datasheet](#), [General Product Information](#), [Approvals](#), [CE declaration of conformity](#), [RoHS](#), [CHINA-RoHS](#), [e-Shop](#), [SCHURTER-Stock-Check](#), [Distributor-Stock-Check](#), [Detailed request for product](#)

### Technical Data

|                              |   |
|------------------------------|---|
| Rated Voltage                | 125 - 250 VAC, 125 VDC  |
| Rated current                | 0.05 - 5 A  |
| Breaking Capacity            | 50 A - 300 A  |
| Characteristic               | Quick-Acting F  |
| Admissible Ambient Air Temp. | -40 °C to 85 °C   |
| Material: Tube               | Ceramic   |
| Material: Axial Leads        | Tin-Plated Copper   |
| Unit Weight                  | 0.6 g   |
| Storage Conditions           | 0 °C to 60 °C, max. 70% r.h.  |
| Product Marking              |  Current, Characteristic |

|                              |   |
|------------------------------|---|
| Soldering Methods            | Wave  |
| Solderability                | 235 °C / 2 sec acc. to IEC 60068-2-20, Test Ta, method 1  |
| Resistance to Soldering Heat | 260 °C / 5 sec acc. to IEC 60068-2-20, Test Tb, method 1A |

### Dimension

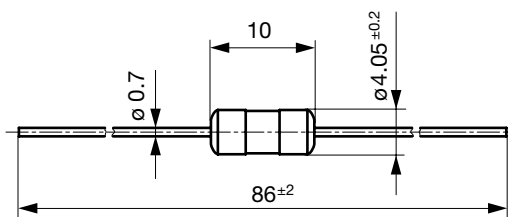
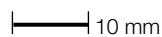

### Pre-Arcing Time

| Rated Current I <sub>n</sub> | 1.0 x I <sub>n</sub> min. | 2.0 x I <sub>n</sub> max. | 3.0 x I <sub>n</sub> max. |
|------------------------------|---------------------------|---------------------------|---------------------------|
| 0.05 A - 5 A                 | 4 h                       | 60 s                      | 100 ms                    |

**Time-Current-Curves**

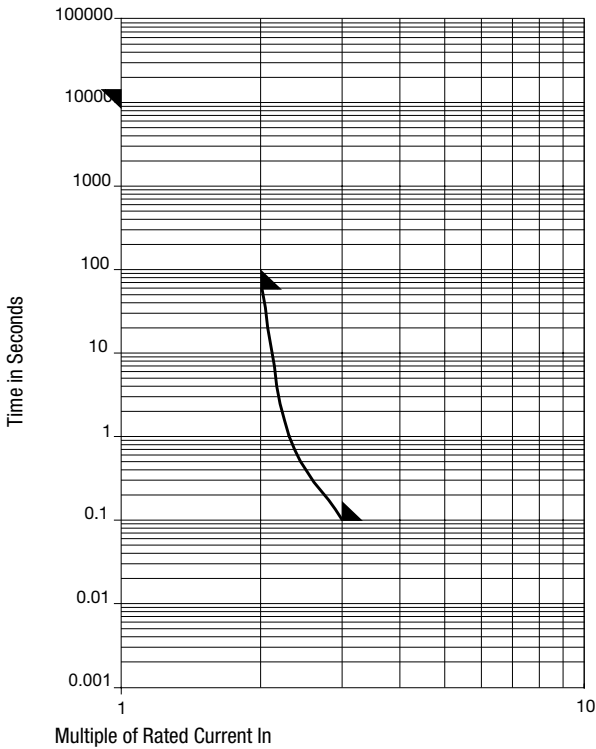

**All Variants**

| Rated Current [A] | Rated Voltage [VAC] | Rated Voltage [VDC] | Breaking Capacity | Voltage Drop 1.0 In typ. [mV] | Melting I <sup>2</sup> t 10.0 Intyp. [A <sup>2</sup> s] | Order Number   |
|-------------------|---------------------|---------------------|-------------------|-------------------------------|---|----------------|
| 0.08              | 250                 | 125                 | 1)                | 950                           | 0.00039   | ● 7010.1760.xx |
| 0.1               | 250                 | 125                 | 1)                | 875                           | 0.00079   | ● 7010.1770.xx |
| 0.125             | 250                 | 125                 | 1)                | 870                           | 0.0013  | ● 7010.1780.xx |
| 0.15              | 250                 | 125                 | 1)                | 545                           | 0.0029  | ● 7010.1790.xx |
| 0.2               | 250                 | 125                 | 1)                | 520                           | 0.0071  | ● 7010.1910.xx |
| 0.3               | 250                 | 125                 | 1)                | 920                           | 0.021   | ● 7010.1920.xx |
| 0.4               | 250                 | 125                 | 1)                | 725                           | 0.057   | ● 7010.1930.xx |
| 0.6               | 250                 | 125                 | 1)                | 205                           | 0.059   | ● 7010.1810.xx |
| 0.8               | 250                 | 125                 | 1)                | 150                           | 0.095   | ● 7010.1820.xx |
| 1.25              | 250                 | 125                 | 1)                | 125                           | 0.29  | ● 7010.1840.xx |
| 1.6               | 250                 | 125                 | 1)                | 135                           | 0.48  | ● 7010.1850.xx |
| 2                 | 250                 | 125                 | 1)                | 110                           | 0.95  | ● 7010.1860.xx |
| 2.5               | 250                 | 125                 | 1)                | 145                           | 1.2   | ● 7010.1870.xx |
| 3                 | 250                 | 125                 | 1)                | 220                           | 1.8   | ● 7010.1880.xx |
| 4                 | 250                 | 125                 | 1)                | 130                           | 3.4   | ● 7010.1890.xx |
| 5                 | 250                 | 125                 | 1)                | 105                           | 7.7   | ● 7010.1900.xx |

Most Popular.

Availability for all products can be searched real-time: <http://www.schurter.com/en/Stock-Check/Stock-Check-SCHURTER>

1) 50 A @ 250 VAC/DC / 300 A @ 125 VAC/DC

**Packaging Unit**    .xx = .12 Plastic Bag (50 pcs.)  
                               .xx = .46 Taped 19 cm Reel (1000 pcs.)