

Device connector, front mounting - SH-8ESC58AWA00S - 1621567

Please be informed that the data shown in this PDF Document is generated from our Online Catalog. Please find the complete data in the user's documentation. Our General Terms of Use for Downloads are valid (<http://phoenixcontact.com/download>)



Device connector for front wall, straight, shielded: Yes, SPEEDCON locking, M23, Number of positions: 4+4+4+PE, Type of contact: Socket, Crimp connection, Axial O-ring, 4xØ3,2, Flange dimensions: 26 mm x 26 mm



Key commercial data

Packing unit	1
GTIN	 4 046356 937153
Custom tariff number	85366990

Technical data

General

Mounting type	4xØ3,2
---------------	--------

Classifications

eCl@ss

eCl@ss 4.0	272607xx
eCl@ss 4.1	27260701
eCl@ss 5.0	27143424
eCl@ss 5.1	27143424
eCl@ss 6.0	27143424
eCl@ss 7.0	27440209
eCl@ss 8.0	27440209

ETIM

ETIM 4.0	EC002635
ETIM 5.0	EC002635

Drawings

Device connector, front mounting - SH-8ESC58AWA00S - 1621567

Schematic diagram

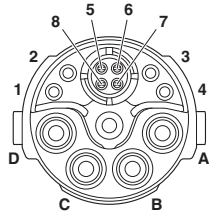

Dimensioned drawing

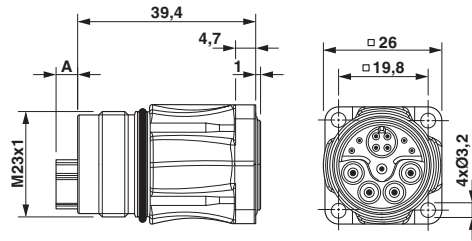

Socket pin assignment, CAT5

Pin version: dimension A = 4.75 mm, socket version: dimension A = 0 mm