

**SPECIFICATION**

RATED VOLTAGE 440V  
 CURRENT 8A AT 40 Deg. C  
 FREQUENCY 50/60Hz  
 TEMPERATURE RANGE-25 TO 85 Deg. C  
 LEAKAGE CURRENT 6.6mA AT 250V 50Hz  
 TEST VOLTAGE 2kV DC

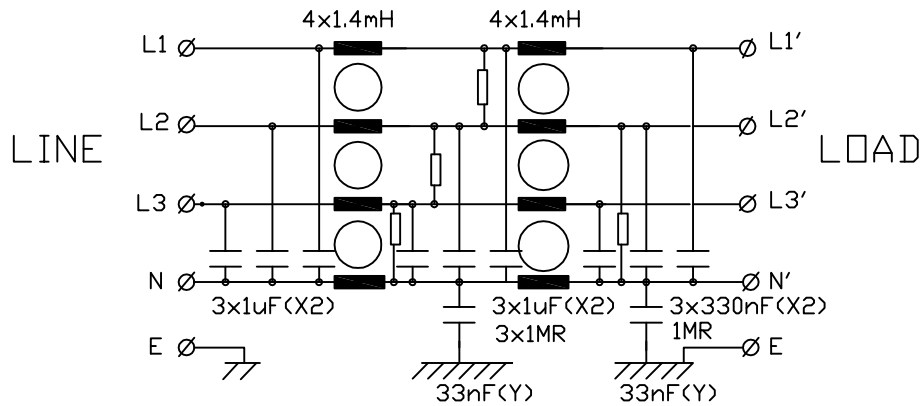

**MINIMUM INSERTION LOSS**

Frequency Hz	30k	100k	150k	300k	10M
Common Mode dB	8	50	64	>75	>75
Differential dB		17	32	>42	>42

ALL DIMENSIONS IN MM / ANGLES IN DECIMAL DEGREES

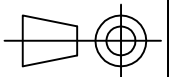

DrgNo IHF408-GS

TITLE TWO STAGE MAINS FILTER 440V 8A 50/60Hz

**ROXBURGH EMC**  ISSUE 1

GENERAL SPECIFICATION  
 FOR IHF408-GS

CUSTOMER  
 FILTER REF

Sheet 1 of 1 | Aprvd Date 02/12/02 | Aprvd By JRT | Drwn by SW | SCALE NTS | CNN--- | Location N: \DWG\GS\GS000308

©DELTRON EMCON LTD, ROXBURGH HOUSE, FOXHILLS INDUSTRIAL PARK, SCUNTHORPE, NORTH LINCOLNSHIRE, DN15 8QJ TEL +44 1724 281770 F +44 1724 270230