

# Data Sheet

## Type 360291

### Illustration

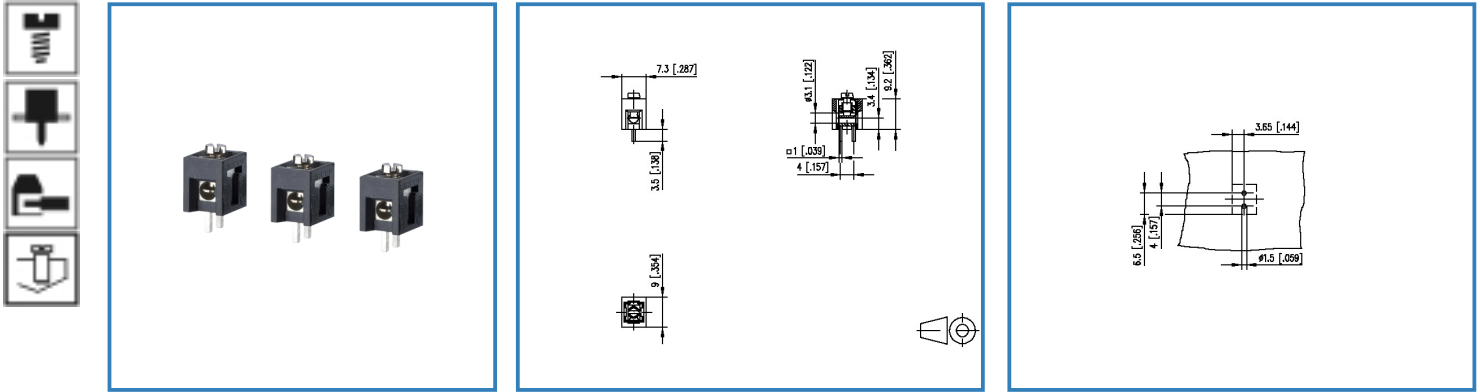

see enlarged drawing at the end of the document

### Product specification

- screw type terminal block, solderable, double solder pins
- direction of connection 90°
- wire protector
- color black
- with molded housing, screw brought down by hand (transport safety)
- Connection data

**c RI' US** V / A / AWG 50 / 15 / 22 - 14



# Data Sheet

## Type 360291

### Technical Data

#### General Data

Tightening torque SEV	0.5 Nm		
Tightening torque UL	7 lb-in		
Solder pin length	3.5 mm		
min. number of poles	1		
max. number of poles	1		
Insulating material class	CTI 600		
Overvoltage category	III	III	II
Pollution degree	3	2	2
Rated test voltage	0.8 kV	4 kV	2.5 kV

#### Connection data

 V / A / AWG	50 / 15 / 22 - 14
--	-------------------

#### Material

terminal body material	CuZn
terminal body surface	Ni + Sn
screw surface	Zn Cr(VI)-frei/free
wire protector material	CuNi18
screw thread	M3

#### Climatic properties

upper limit temperature	105 °C
lower limit temperature	-40 °C

#### General

solderability	For THR products acc. to IPC/JEDEC J-STD-020D-MSL 1   For THT products max. 260 °C / 10 s
Tolerance	ISO 2768 -mH



# Data Sheet

## Type 360291

### Illustration

Drawing

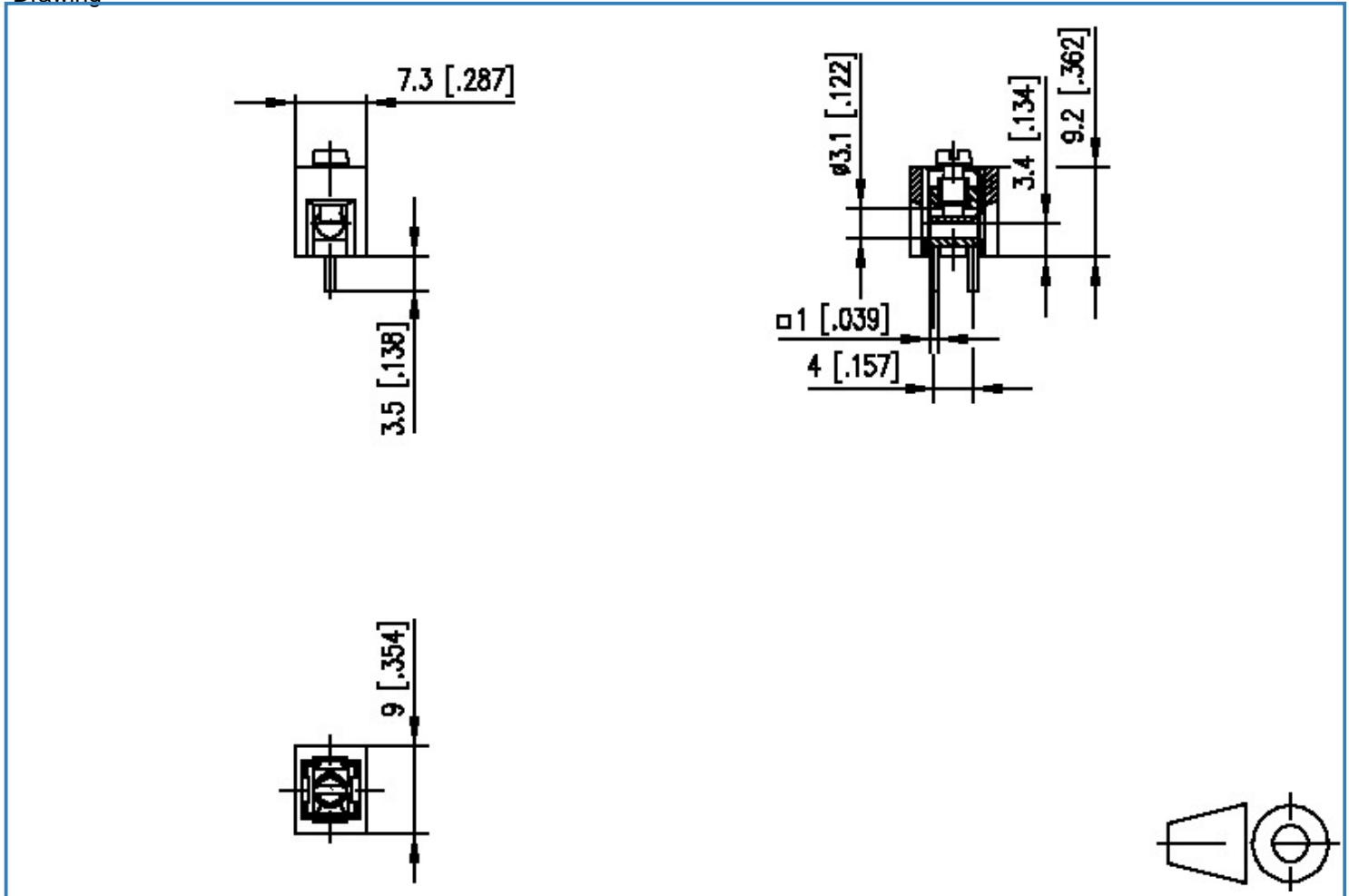

# Data Sheet

## Type 360291

### PCB Layout

