



ECG.2B.316.CLV

MECHANICAL DETAILS

Shell Style Model EC* : Fixed receptacle with two nuts with elbow contact for printed circuit (back panel mounting)

Keying 1 key (alpha=0, plug: male contacts, receptacle: female contacts)

Housing Material Brass (chrome plated) shell and collet nut, nickel plated brass latch sleeve and mid pieces

Cable Fixing 0 - 0 mm

Variant 2 :

	B	E	M	Nmax	S1	S3	e
Mm.	20	6.5	3.5	22.3	13.5	17	M15x1.0
In.	0.79	0.26	0.14	0.88	0.53	0.67	

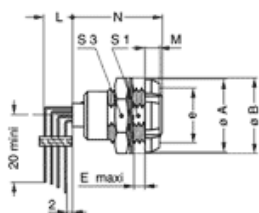

PERFORMANCE DETAIL

Insert 2B.316 : 16 Low Voltage

Insulator L: PEEK

Specifications

Contact Type: Print (elbow)

Max. Matings: 5000

Contact Dia.: 0.7 mm (0.028in)

R (max): 6.1 mOhm

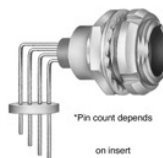

OTHER CHARACTERISTICS

Shell Style/Model Libellé

Temp (min) -55°C

Temp (max) +250°C

Humidity (max): <=95% [at 60 deg C /140 F]

Vibration: 15 g [10 Hz - 2000 Hz]

Shock Resistance: 100 g [6 ms]

Salt Spray >144 hr

Climatical 50/175/21

Shielding (min): 75 dB (10 MHz)

Shielding (min): 40 dB (1 GHz)

IP Rating 50

