

Long Life Fan □ 80mm San Ace 80L



General specifications

- Material ······Frame:Aluminum, Impeller:Plastics
- Life Expectancy ······Varies for each model (Survival rate: 90% at 60°C, rated voltage, and continuously run in a free air state)
- Motor Protection System ······Current blocking function (with reverse polarity protection)
- Dielectric Strength ······50/60 Hz, 500VAC, 1 minute (between lead conductor and frame)
- Noise Measurement Method ······Measured at 1m from the air inlet
- Operating Temperature Range ······Varies for each model (Non-condensing)
- Lead Wire ········S, H, F speeds ⊕red, ⊖black
M, L speeds ⊕red, ⊖black or blue
- Mass ···········150g

Long Life Fans

25mm thick Specifications

Model No.	Rated Voltage (V)	Operating Voltage range (V)	Rated Current (A)	Rated Input (W)	Rated Speed (min ⁻¹)	Air Flow (m ³ /min) (CFM)	Static Pressure (Pa) (inchH ₂ O)	Noise (dB [A])	Operating Temperature Range (°C)	Life Expectancy (h)
109L0812S402	12	10.2~13.8	0.26	3.12	3,400	1.2 42.4	50 0.2	37	-10 ~ +70	100,000
109L0812H402			0.18	2.16	3,000	1.06 37.4	39.2 0.157	32		
109L0812F402			0.14	1.68	2,700	0.93 32.8	32.3 0.130	29		
109L0812M402			0.1	1.2	2,400	0.83 29.3	26.5 0.106	26		
109L0812L402			0.08	0.96	1,900	0.63 22.2	16.7 0.067	22		
109L0824S402	24	20.4~27.6	0.11	2.64	3,400	1.2 42.4	50 0.2	37		
109L0824H402			0.09	2.16	3,000	1.06 37.4	39.2 0.157	32		
109L0824F402			0.08	1.92	2,700	0.93 32.8	32.3 0.130	29		
109L0824M402			0.07	1.68	2,400	0.83 29.3	26.5 0.106	26		
109L0824L402			0.05	1.2	1,900	0.63 22.2	16.7 0.067	22		
109L0848H402	48	40.8~55.2	0.06	2.88	3,150	1.1 38.8	43.1 0.173	34		

Air Flow and Static Pressure Characteristics

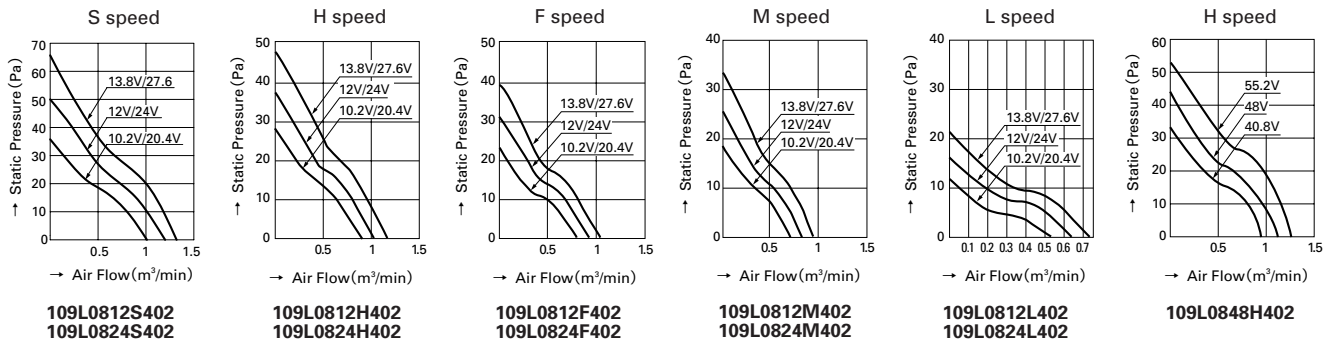

80mm

Dimensions (unit : mm)

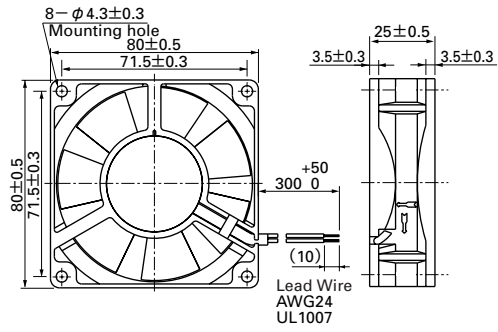

Reference dimension of mounting holes and vent opening (unit : mm)

