

8400 TELE-EASY STRIP

STRIPPING INSTRUCTIONS FOR TWISTED PAIR

STRIPPER FEATURES

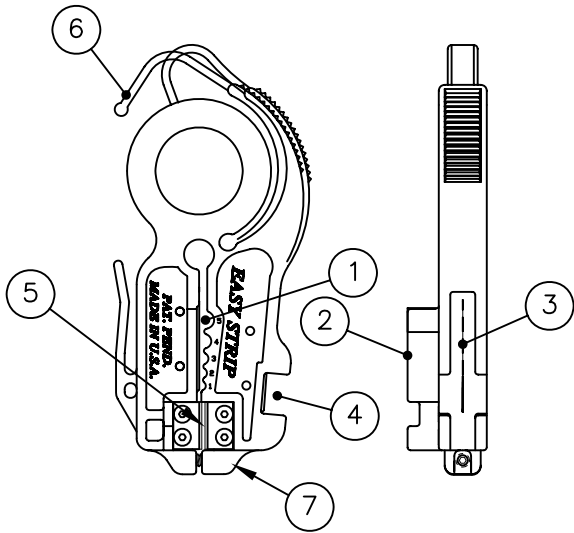

- ① OUTER JACKET STRIPPING BLADE FOR TWISTED PAIR CAVITIES (1 THRU 5).
- ② STRIP LENGTH GAGE.
- ③ SLITTING BLADE.
- ④ STRIPPING CAVITY FOR TWISTED, UNEVEN OR LARGE CABLE.
- ⑤ FLAT SATIN STRIPPING BLADES WITH PENETRATION STOPS.
- ⑥ TENSION LOOP TO CONTROL BLADE PENETRATION.
- ⑦ ADJUSTMENT SCREW TO CONTROL BLADE PENETRATION.

TWISTED PAIR CABLE PREPARATION PRIOR TO CONNECTORIZATION

STRIPPING OPERATION

- DETERMINE RECOMMENDED STRIP LENGTH.
- SELECT PROPER CAVITY ① BASED ON CABLE DIA.
- WITH THE TENSION LOOP ⑥ DIS-ENGAGED, SQUEEZE THE TOOL TO ALLOW ENTRY OF CABLE INTO THE APPROPRIATE CAVITY.
- FOR SHIELDED OR THICK JACKETED CABLE ENGAGE TENSION LOOP.
- POSITION THE CABLE END ON THE STRIP LENGTH GAGE ②. THIS WILL PROVIDE A .600 IN. MIN. LENGTH ONCE THE CONDUCTORS ARE UNTWISTED.
- ROTATE TOOL ONCE TO SCORE JACKET.
- IF BLADE PENETRATES CONDUCTOR INSULATION RELEASE TENSION LOOP AND ROTATE TOOL AROUND CABLE TWO OR THREE TIMES.
- CRACK JACKET BY BENDING AT SCORE AND REMOVE SCRAP.
- IF BLADE STILL PENETRATES CONDUCTOR INSULATION ADJUST SCREW ⑦ TO CONTROL BLADE PENETRATION.

SLITTING OPERATION

- TO SLIT A RUN OF TWISTED PAIR FOR PUNCH DOWN, PLACE THE CABLE IN THE LONGITUDINAL SLOT ③.
- PULL CABLE WHILE APPLYING SLIGHT DOWNWARD PRESSURE TO PROMOTE BLADE PENETRATION.
- TWIST THE SLIT PORTION OF THE CABLE TO ASSIST IN SCRAP REMOVAL.
- PLACE THE SLIT CABLE IN THE PERPENDICULAR SLOT ④ WITH THE BEGINNING OF THE SLIT EVEN WITH THE BLADE.
- WHILE APPLYING SLIGHT DOWNWARD PRESSURE TO PROMOTE BLADE PENETRATION, ROTATE CABLE. CRACK JACKET BY BENDING AT SCORE AND REMOVE SCRAP.

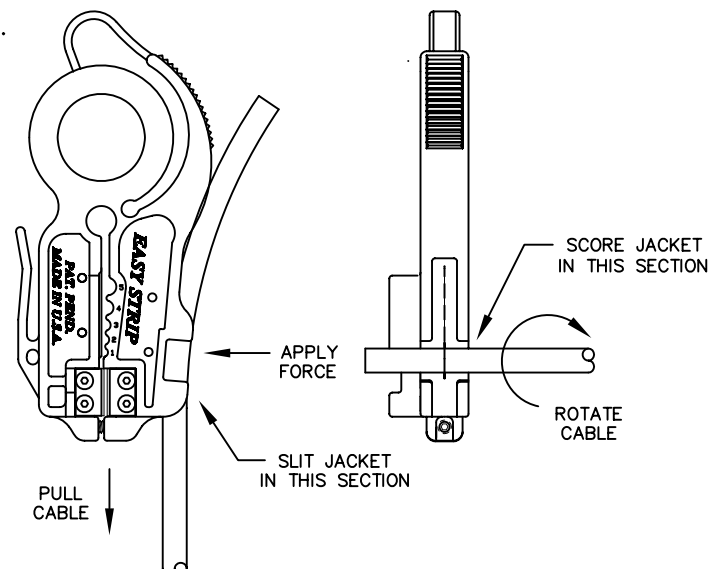
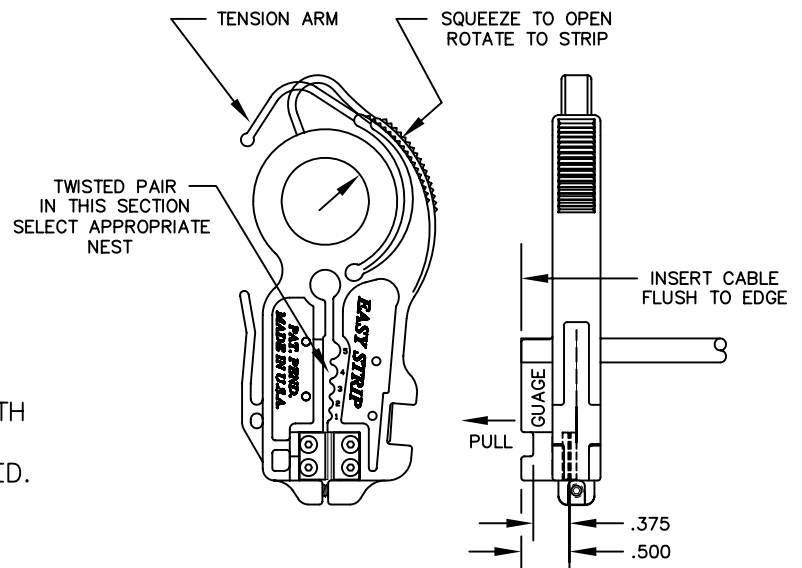

8400 TELE-EASY STRIP

STRIPPING INSTRUCTIONS FOR FLAT CABLE

STRIPPER FEATURES

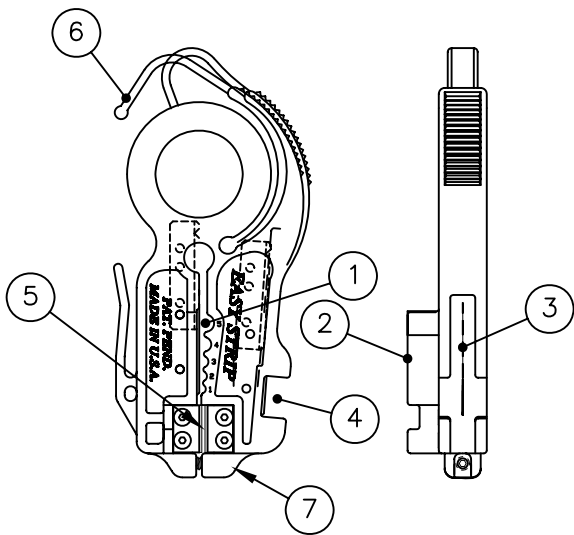

- ① OUTER JACKET STRIPPING BLADE FOR TWISTED PAIR CAVITIES (1-5).
- ② STRIP LENGTH GAGE.
- ③ SLITTING BLADE.
- ④ STRIPPING CAVITY FOR TWISTED, UNEVEN OR LARGE CABLE.
- ⑤ FLAT SATIN STRIPPING BLADES WITH PENETRATION STOPS.
- ⑥ TENSION LOOP TO CONTROL BLADE PENETRATION.
- ⑦ ADJUSTMENT SCREW TO CONTROL BLADE PENETRATION.

SATIN CABLE PREPARATION PRIOR TO CONNECTORIZATION

STRIPPING OPERATION

- WITH TENSION LOOP ENGAGED SQUEEZE TOOL TO ALLOW INSERTION OF FLAT CABLE.
- USE STRIP LENGTH GAGE (2) TO POSITION CABLE IN NEST (5). (3/8" FOR RJ11 CABLE OR 1/2" FOR RJ45 CABLE).
- SQUEEZE TOOL CLOSED TO PROMOTE BLADE PENETRATION. (CABLE STOPS PREVENT NICKING.)
- HOLDING TOOL CLOSED, ROCK CABLE 30° TO BOTH SIDES OF CENTERLINE OF TOOL AND PULL CABLE TO REMOVE SCRAP.
- TOOL IS FACTORY ADJUSTED TO THE INDUSTRY STANDARD .035" GAP. IF CONDUCTOR INSULATION JACKET IS NICKED, ADJUST SET-SCREW (7) TO INCREASE GAP.
- REPEAT PROCEDURE UNTIL SATISFACTORY RESULTS ARE ACHIEVED.

