

# EAO – Your Expert Partner for Human Machine Interfaces

82-6151.2143 - Illuminated pushbutton 22 mm stainless-steel, maintain

## 82-6151.2143 - Illuminated pushbutton 22 mm stainless-steel, maintain



*Attention: The preview is based on a sample product. This can differ from your current configuration.*

### Mounting

Design	flush
Mounting cut-out	Ø 22 mm

### Front

Front shape	round
Front ring shape	flush
Front dimension	Ø 25 mm

### Other Attributes

Operating voltage	12 V AC/DC
Weight	0.018 kg
Operation current	14 mA

### Operating-/Indication part

Lens optics	opaque
Lens material	Stainless steel
Lens profile	flat
Lens illumination	illuminative
Lens colour	Stainless steel

### IP-Rating

Front protection	IP 67
------------------	-------

### Connection Method

Terminal	Solder 2.8 x 0.5 mm
----------	---------------------

### Actuator

Switching action	Maintained
------------------	------------

### Switching element

Switching current	5 A
Contact material	Silver
Contacts	1 C
Switching system	Snap-action switching element
Switching voltage	250 V AC

### Illumination

Illumination	Ring with yellow LED
--------------	----------------------

### Function

Illuminated pushbutton
------------------------

# EAO – Your Expert Partner for Human Machine Interfaces

82-6151.2143 - Illuminated pushbutton 22 mm stainless-steel, maintain

## Dimensions

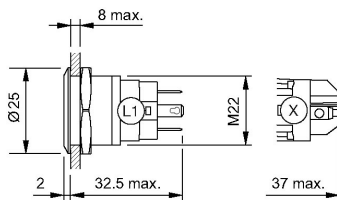

## Mounting cut-outs

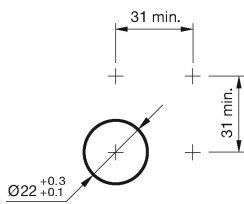

## Wiring diagram

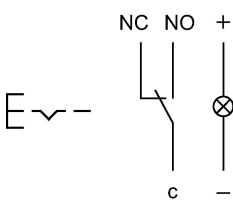

## Component layout



## Legend

Switching action: C = Maintained

Contacts: C = Changeover