

CONTACTS	DIMENSIONS		
	A	B	C
6	4.0	6.6	2.0
8	6.0	8.6	4.0
10	8.0	10.6	6.0
12	10.0	12.6	8.0
14	12.0	14.6	10.0
16	14.0	16.6	12.0
18	16.0	18.6	14.0
20	18.0	20.6	16.0
22	20.0	22.6	18.0
24	22.0	24.6	20.0
26	24.0	26.6	22.0
28	26.0	28.6	24.0
30	28.0	30.6	26.0
32	30.0	32.6	28.0
34	32.0	34.6	30.0
36	34.0	36.6	32.0
38	36.0	38.6	34.0
40	38.0	40.6	36.0
42	40.0	42.6	38.0
44	42.0	44.6	40.0
46	44.0	46.6	42.0
48	46.0	48.6	44.0
50	48.0	50.6	46.0
52	50.0	52.6	48.0
54	52.0	54.6	50.0
56	54.0	56.6	52.0
58	56.0	58.6	54.0
60	58.0	60.6	56.0
62	60.0	62.6	58.0
64	62.0	64.6	60.0
66	64.0	66.6	62.0
68	66.0	68.6	64.0
70	68.0	70.6	66.0
72	70.0	72.6	68.0
74	72.0	74.6	70.0
76	74.0	76.6	72.0
78	76.0	78.6	74.0
80	78.0	80.6	76.0

CAP NOTE:

DIM D	NO. OF PINS
4.00	06-16 PINS
8.05	18-80 PINS

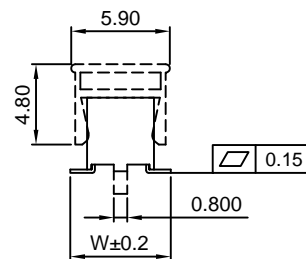
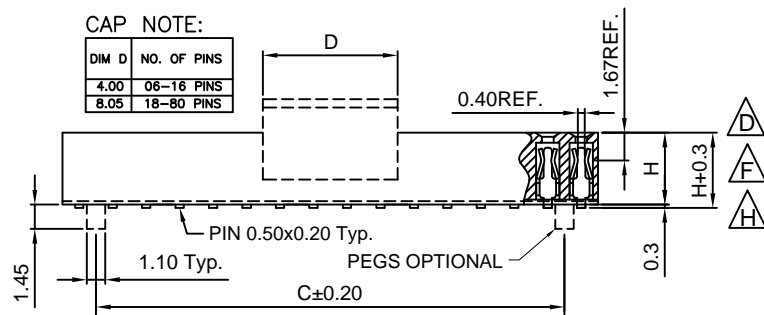

SPECIFICATIONS 规格

CURRENT RATING 电流额定值: 2 AMP  
 INSULATOR RESISTANCE 绝缘电阻值: 1000 MEGOHMS MIN.  
 CONTACT RESISTANCE 接触电阻值: 20mOHMS MAX.  
 DIELECTRIC WITHSTANDING 耐电压: AC 500 V  
 OPERATING TEMPERATURE 工作温度: -40°C TO +105°C  
 CONTACT MATERIAL 端子物料: PHOSPHOR BRONZE  
 INSULATOR MATERIAL 绝缘体物料:  
 STANDARD 标准物料: POLYAMIDE 聚酰胺, NYLON 6T, UL 94-V0  
 OPTIONS 可选物料: POLYESTER 聚酯, LCP, UL 94-V0  
 SOLDERING PROCESS 可焊性:  
 NYLON 6T (STANDARD 标准物料) -  
 IR REFLOW 回流焊: 260°C for 10 sec.  
 WAVE 波峰焊: 230°C for 5-10 sec.  
 MANUAL SOLDER 人工焊接: 350°C for 3-5 sec  
 LCP (OPTION 可选物料) -  
 IR REFLOW 回流焊: 260°C for 10 sec.  
 WAVE 波峰焊: 250°C for 5-10 sec.  
 MANUAL SOLDER 人工焊接: 350°C for 3-5 sec

MATES WITH 配套之母座 (SUBJECT TO PIN LENGTH 在端子长度适合的条件下):

BF030 BF045 BF050 BF055 BF060  
 BF135 BF140 BF145

Ordering Grid

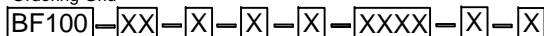

No. of Contacts  
06 to 80

Contact Plating  
**A = Gold Flash All Over (Standard)**  
 B = Selective Gold Flash Contact Area/  
 Tin On Tail  
 C = Tin All Over  
 G = 10µ" Gold Contact Area/Tin On Tail  
 I = 30µ" Gold Contact Area/Tin On Tail

Insulator Height 'H'  
**C = 4.00mm (Standard)**  
 D = 4.30mm

Locating Peg  
 0 = No Peg  
 1 = With Peg

Packing Options  
**C = Tape and Reel with Film (Standard)**  
 B = Tape and Reel with Cap  
 D = Tube  
 E = Tube with Cap  
 F = Tube with Film

Dimension W - Footprint Width (1/100mm)  
**'H' = 4.00mm: Standard - 6.25mm = 0625**  
 Alternative - 5.00mm = 0500  
**'H' = 4.30mm: Standard - 6.40mm = 0640**  
 Alternative - 5.60mm = 0560  
 - 6.25mm = 0625

By	LYH	DR	AE	AE	SA	SA	AJO
DETAIL	DRAWING RELEASE	CHANGE TO SOLDER TEMP. INFORMATION	MODIFICATION TO HEIGHT EFFECTING ORDER GRID	CHANGE TO DIMENSION W STANDARDS	CHANGE TO INSULATOR HEIGHTS	CHANGE TO DIM B VALUES	STANDARDS TIDY UP
REV DATE	A 31/10/07	C 05/08/09	D 25/08/09	E 25/11/09	F 28/01/10	G 02/06/10	H 19/11/12



Tolerances (Except as noted)	Part Number:-	Date:-
Dimensions in mm X. ± 0.30 X.* ± 5.0° X.X ± 0.25 X.* ± 3.0° X.XX ± 0.15 XX.* ± 2.0° X.XXX ± 0.10 XXX.* ± 1.0°	<b>BF100</b>	31 OCT 07
Third Angle Projection	Description:- 2.0mm PITCH SOCKET, DUAL ROW, SURFACE MOUNT, 4.3mm or 4.6mm PROFILE	
© THIS DRAWING IS CONFIDENTIAL AND MUST NOT BE COPIED OR DISCLOSED WITHOUT WRITTEN CONSENT		

**GCT**

www.globalconnectortechology.com

Scale	Revision	Material	Drawn by	Sheet No.
NTS	H	See Note	LYH	E & OE 1/1