

M-Series Circuit Breaker

The M-Series is a low cost, miniature hydraulic/magnetic circuit breakers ideally designed for demanding applications requiring space saving features, aesthetics and snap-in front panel mounting.

Its newest design features a compact, space saving, vertically mounted parallel pole configuration, which is UL489A listed up to 50 amps and is well suited for telecommunication equipment fitting in one rack unit. Furthermore, it features two uniquely designed terminals that provide the highest level of balanced circuit protection.

In addition, these circuit breakers feature various styling options allowing for design flexibility. They are available in choices of rocker actuator styles and colors, including paddle and baton style handle actuators, push-to-reset and push-pull pushbutton actuators, Visi-Rocker two color actuators as well as non-illuminated or illuminated rocker versions with LED or neon bulbs. The exclusive Rockerguard bezel helps prevent inadvertent actuation and wiping contact design insures long-term reliability. The M-Series circuit breakers are available in 1 & 2 poles or parallel poles, 0.02 to 50 amps, up to 250VAC or 80VDC with choices of time delays, terminals, panel hardware, actuator styles, colors, and imprinting.



Features:

- ♦ Parallel pole configuration well suited for One Rack Unit
- ♦ MIL-PRF-55629 and MIL STD 202 compliant
- ♦ MIL-PRF-39019F ingress protection
- ♦ Sealed toggle actuator
- ♦ Compact design

Applications:

- ♦ Communication equipment
- ♦ Vehicles
- ♦ Marine
- ♦ Generators
- ♦ Power supplies
- ♦ Medical Equipment



Carling Technologies™
Innovative Designs. Powerful Solutions.

Electrical

Maximum Voltage 125/250 VAC 50/60 Hz, 80 VDC (See Rating Tables.)

Current Ratings Standard current coils: 0.100, 0.250, 0.500, 0.750, 1.00 thru 15.0 in 1 amp increments, 18.0, 20.0, 25.0, 30.0. Other ratings available - see Ordering Scheme.

Auxiliary Switch Rating SPDT; 7A 250VAC, 7A (Res) 28VDC, 4A (Ind.) 28VDC, 0.25A 80VDC (Res) (silver contacts), 0.1A 125VAC (gold contacts).

Insulation Resistance Minimum of 100 Megohms at 500 VDC.

Dielectric Strength UL, CSA 1500V, 50/60 Hz for one minute between all electrically isolated terminals. M-Series Circuit Breakers comply with the 8mm spacing and 3750 V 50/60Hz dielectric requirements from hazardous voltage to operator accessible surfaces, per Publications IEC 380, 435, 950, EN 60950 and VDE 0805.

Resistance, Impedance Values from Line to Load Terminal - based on Series Trip Circuit Breaker.

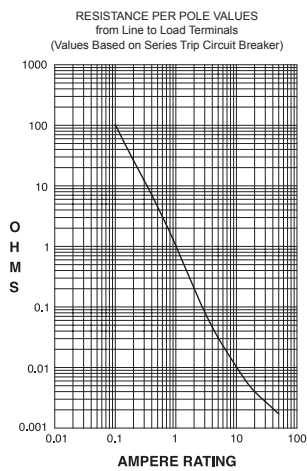

| CURRENT (AMPS) | TOLERANCE (%) |
|----------------|---------------|
| 0.10 - 20.0 | ±25 |
| 20.1 - 50.0 | ±35 |

Pulse Tolerance Curves

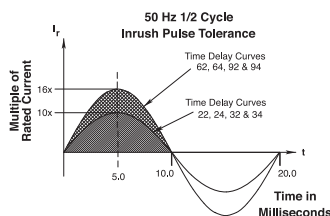
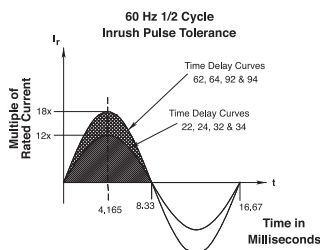

*Manufacturer reserves the right to change product specification without prior notice.

Mechanical

Endurance 10,000 ON-OFF operations @ 6 per minute with rated Current and Voltage.

Trip Free All M-Series Circuit Breakers will trip on overload, even when actuator is forcibly held in the ON position.

Trip Indication The actuator moves positively to the OFF position when an overload causes the circuit breaker to trip.

Physical

Number of Poles 1 or 2

Internal Circuit Configs. Series with or without Auxiliary Switch. Switch Only with or without Auxiliary Switch.

Weight Approximately 30 grams/pole (Approximately 1.07 ounces/pole)

Standard Colors See Ordering Scheme.a

Environmental

Designed in accordance with requirements of specification MIL PRF-55629 & MIL-STD-202G as follows:

Shock Withstands 100 Gs, 6ms, sawtooth while carrying rated current per Method 213, Cond. I. Instantaneous curves tested at 80% of rated current.

Vibration Withstands 0.060" excursion from 10-55 Hz, and 10 Gs 55-500 Hz, at rated current per Method 204C, Test Condition A. Instantaneous curves tested at 80% of rated current.

Moisture Resistance Method 106D, i.e., ten 24-hour cycles @ + 25°C to +65°C, 80-98% RH.

Salt Spray Method 101, Condition A (90-95% RH @ 5% NaCl Solution, 96 hrs).

Thermal Shock Method 107D, Condition A (Five cycles @ -55°C to +25°C to +85°C to +25°C).

Operating Temperature -40° C to +85° C

Chemical Resistance Only the outside surfaces of the case and the handles may be cleaned with detergents or alcohol. Organic (hydrocarbon based) solvents are not recommended because they attack plastics. Caution should be taken when solvents are used to clean and remove flux from terminals. Lubricants should not be introduced into the handle/bushing openings

Electrical Tables

Table A: Lists UL Recognized and CSA Accepted configurations & performance capabilities as a Component Supplementary Protector.

| M-SERIES TABLE A: COMPONENT SUPPLEMENTARY PROTECTORS | | | | | | | | | | |
|--|-------------------|-----------|-----------|----------------|----------------------|-------------------|-------------------------------|---------------------|-------------------|----------------|
| CIRCUIT CONFIGURATION | VOLTAGE | | | CURRENT RATING | | POLES BREAKING | SHORT CIRCUIT CAPACITY (AMPS) | | APPLICATION CODES | |
| | MAX. RATING | FREQUENCY | PHASE | FULL LOAD AMPS | GENERAL PURPOSE AMPS | | UL / CSA | | UL | CSA |
| | | | | | | | WITH BACKUP FUSE | WITHOUT BACKUP FUSE | | |
| SERIES | 32 | DC | --- | 0.02 - 15 | --- | 1 | --- | 1000 | TC1,2, OL1, U1 | TC1,2, OL1, U1 |
| | | | | --- | 15.1 - 25 | 1 | --- | 1000 | TC1,2, OL0, U1 | TC1,2, OL0, U1 |
| | 50 ² | DC | --- | 0.02 - 7.5 | --- | 1 | --- | 1000 | TC1,2, OL0, U1 | TC1,2, OL0, U1 |
| | | | | --- | 15.1 - 25 | 2 | --- | 1000 | TC1,2, OL1, U1 | TC1,2, OL1, U1 |
| | 65 | DC | --- | 0.02 - 15 | --- | 2 | --- | 1000 | TC1,2, OL1, U1 | TC1,2, OL1, U1 |
| | | | | --- | 15.1 - 25 | 2 | --- | 1000 | TC1,2, OL0, U1 | TC1,2, OL0, U1 |
| | 65 ^{1,2} | DC | --- | 0.02 - 15 | --- | 1 | --- | 1000 | TC1,2, OL1, U1 | TC1,2, OL1, U1 |
| | | | | --- | 15.1 - 30 | 1 | --- | 1000 | TC1,2, OL0, U1 | TC1,2, OL0, U1 |
| | 65 | DC | --- | 0.02 - 15 | --- | 2 | 5000 ³ | --- | TC1,2, OL1, C1 | TC1,2, OL1, C1 |
| | | | | --- | 15.1 - 25 | 2 | 5000 ³ | --- | TC1,2, OL0, C1 | TC1,2, OL0, C1 |
| | 80 ¹ | DC | --- | 0.02 - 15 | --- | 1 | --- | 600 | TC1,2, OL1, U1 | TC1,2, OL1, U1 |
| | | | | --- | 15.1 - 30 | 1 | --- | 600 | TC1,2, OL0, U1 | TC1,2, OL0, U1 |
| | 125 | 50 / 60 | 1 | 0.02 - 15 | --- | 1 | --- | 1000 | TC1,2, OL1, U1 | TC1,2, OL1, U1 |
| | | | | --- | 15.1 - 30 | 1 | --- | 1000 | TC1,2, OL0, U1 | TC1,2, OL0, U1 |
| | | | | 1 - 30 | --- | 1 | --- | 360 | TC1,OL1,U2 | TC3, OL1, U3 |
| 250 ² | 50 / 60 | 1 | 0.02 - 12 | --- | 1 | --- | 1000 | TC1,2, OL1, U1 | TC1,2, OL1, U1 | |
| 250 | 50 / 60 | 1 | --- | 12.1 - 18 | 1 | 1000 ⁴ | --- | TC1,2, OL0, C1 | TC1,2, OL0, C1 | |
| 250 | 50 / 60 | 1 | 0.02 - 15 | --- | 2 | --- | 1000 | TC1,2, OL1, U1 | TC1,2, OL1, U1 | |
| | | | --- | 15.1 - 30 | 2 | --- | 1000 | TC1,2, OL0, U1 | TC1,2, OL0, U1 | |
| | | | 1 - 30 | --- | 2 | --- | 360 | TC1,OL1,U2 | TC3, OL1, U3 | |

Table A Notes:

- 1 Polarity Sensitive
- 2 Available only with Special Catalog Number. Consult Factory.
- 3 Requires Branch Circuit Backup with a UL Listed type K-5 or RK-5 fuse rated 30 Amps maximum
- 4 Requires Branch Circuit Backup with a UL Listed type K-5 or RK-5 fuse rated 60 Amps maximum

Table B: Lists UL Recognized, CSA Accepted and TUV and VDE Certified configurations and performance capabilities as a Component Supplementary Protector.

| M-SERIES TABLE B: COMPONENT SUPPLEMENTARY PROTECTORS | | | | | | | | | | | | |
|--|-----------------|-----------|-------|----------------|------------------------|----------------|-------------------------------|---------------------|-------------------------------|---------------------|-------------------|----------------|
| CIRCUIT CONFIGURATION | VOLTAGE | | | CURRENT RATING | | POLES BREAKING | SHORT CIRCUIT CAPACITY (AMPS) | | | | APPLICATION CODES | |
| | MAX. RATING | FREQUENCY | PHASE | FULL LOAD AMPS | GENERAL PURPOSE AMPS | | UL / CSA | | VDE / TUV | | UL | CSA |
| | | | | | | | WITH BACKUP FUSE | WITHOUT BACKUP FUSE | WITH BACKUP FUSE ⁵ | WITHOUT BACKUP FUSE | | |
| SERIES | 32 | DC | --- | 0.02 - 15 | --- | 1 | --- | 1000 | 3000 | 500 | TC1,2, OL1, U1 | TC1,2, OL1, U1 |
| | | | | --- | 15.1 - 20 ⁴ | 1 | --- | 1000 | 3000 | 500 | TC1,2, OL0, U1 | TC1,2, OL0, U1 |
| | 50 ² | DC | --- | 0.02 - 7.5 | --- | 1 | --- | 1000 | 3000 | 500 | TC1,2, OL0, U1 | TC1,2, OL0, U1 |
| | | | | --- | 15.1 - 20 ⁴ | 2 | --- | 1000 | 3000 | 500 | TC1,2, OL1, U1 | TC1,2, OL1, U1 |
| | 65 | DC | --- | 0.02 - 15 | --- | 2 | --- | 1000 | 3000 | 500 | TC1,2, OL1, U1 | TC1,2, OL1, U1 |
| | | | | --- | 15.1 - 20 ⁴ | 2 | --- | 1000 | 3000 | 500 | TC1,2, OL0, U1 | TC1,2, OL0, U1 |
| | 65 ³ | DC | --- | 0.02 - 15 | --- | 2 | 5000 | --- | 3000 | 500 | TC1,2, OL1, C1 | TC1,2, OL1, C1 |
| | | | | --- | 15.1 - 20 ⁴ | 2 | 5000 | --- | 3000 | 500 | TC1,2, OL0, C1 | TC1,2, OL0, C1 |
| | 80 ¹ | DC | --- | 0.02 - 15 | --- | 1 | --- | 600 ⁴ | --- | 600 | TC1,2, OL1, U1 | TC1,2, OL1, U1 |
| | | | | --- | 15.1 - 20 ⁴ | 1 | --- | 600 ⁴ | --- | 600 | TC1,2, OL0, U1 | TC1,2, OL0, U1 |
| | 125 | 50 / 60 | 1 | 0.02 - 15 | --- | 1 | --- | 1000 | 3000 | 500 | TC1,2, OL1, U1 | TC1,2, OL1, U1 |
| | | | | 1 - 15 | --- | 1 | --- | 360 | 3000 | 500 | TC1,OL1,U2 | TC3, OL1, U3 |
| | | | | 0.02 - 12 | --- | 1 | --- | 1000 | 3000 | 500 | TC1,2, OL1, U1 | TC1,2, OL1, U1 |
| | 250 | 50 / 60 | 1 | 0.02 - 20 | --- | 2 | --- | 1000 | 3000 | 500 | TC1,2, OL1, U1 | TC1,2, OL1, U1 |
| | | | | 1 - 12 | --- | 1 | --- | 360 | 3000 | 500 | TC1,OL1,U2 | TC3, OL1, U3 |

Table B Notes:

- 1 Polarity Sensitive
- 2 Available only with Special Catalog Number. Consult Factory.
- 3 Requires Branch Circuit Backup with a UL Listed type K-5 or RK-5 fuse rated 30 Amps maximum
- 4 TUV only, not VDE
- 5 Requires backup protection with a thermal magnetic circuit breaker rated 32 amps and having a Type C trip characteristic per EN60898/DIN VDE 0641 (C32A) for ratings greater than 15amps, and a thermal magnetic circuit breaker rated 16 amps and having a Type C trip characteristic per EN60898/DIN VDE 0641 (C16A) for ratings 15 amps and less

Electrical Tables

Table C: Lists UL489A Listed and TUV Certified configurations and performance capabilities for use in Communications Equipment.

| M-SERIES TABLE C: UL489A Listed (COMMUNICATIONS EQUIPMENT - POLARITY SENSITIVE) | | | | | | |
|--|-----------------|-----------|-------------------------------------|----------------|------------------------------|-----|
| CIRCUIT CONFIGURATION | VOLTAGE | | CURRENT RATING GENERAL PURPOSE AMPS | POLES BREAKING | INTERRUPTING CAPACITY (AMPS) | |
| | MAX. RATING | FREQUENCY | | | WITHOUT BACKUP FUSE | |
| | | | | | UL489A | TUV |
| SERIES | 80 | DC | 0.02 - 30 | 1 | 600 | --- |
| | 65 ¹ | DC | 0.02 - 30 | 1 | 1000 | --- |
| | 80 | DC | 0.10 - 25 | 1 | 600 | 600 |

Table C Notes:
 1 Available only with Special Catalog Number

Table D: Lists UL489A Listed configurations and performance capabilities for use in Communications Equipment.

| M-SERIES TABLE D: Parallel Pole Construction UL489A Listed (COMMUNICATIONS EQUIPMENT - POLARITY SENSITIVE) | | | | | |
|---|-----------------|-----------|-------------------------------------|----------------|------------------------------|
| CIRCUIT CONFIGURATION | VOLTAGE | | CURRENT RATING GENERAL PURPOSE AMPS | POLES BREAKING | INTERRUPTING CAPACITY (AMPS) |
| | MAX. RATING | FREQUENCY | | | WITHOUT BACKUP FUSE |
| | | | | | UL489A |
| SERIES | 80 | DC | 31-50 | 2 | 600 |
| | 65 ¹ | DC | 31-50 | 2 | 1000 |

Table D Notes:
 1 Available only with Special Catalog Number

Agency Certifications

UL Recognized

UL Standard 1077



Component Recognition Program as Protectors, Supplementary (Guide CCN/QVNU2, File E75596)

CSA Accepted



Component Supplementary Protector (Class 3215 30, File 047848 0 000) CSA Standard C22.2 No. 235

UL Listed

UL Standard 489A



Communications Equipment (Guide CCN/DITT, File E189195)

VDE Certified



EN60934, VDE 0642 under File 10537

TUV Certified



EN60934, under License No. R9671109



1 SERIES
M

2 ACTUATOR
Single Color Rocker **Two Color Visi-Rocker** **Single Color Translucent Rocker**
A Angled **D** Indicate ON **F** Angled
B Flat **E** Indicate OFF **G** Flat

3 POLES
2 Two

4 CIRCUIT/AUXILIARY SWITCH²
P Series Trip Current (Parallel Pole)
with Auxiliary Switch, Silver Contacts
Q Series Trip Current (Parallel Pole) .110 x 0.20 Q.C
with Auxiliary Switch, Gold Contacts
R Series Trip Current (Parallel Pole) .110 x 0.20 Q.C

5 FREQUENCY & TIME DELAY
D2 DC Short
D4 DC Medium

6 CURRENT RATING (AMPERES)

| CODE | AMPERES |
|------|---------|
| 631 | 31,000 |
| 635 | 35,000 |
| 640 | 40,000 |
| 645 | 45,000 |
| 650 | 50,000 |

7 TERMINAL
A Push in Stud
5 10-32 Screw (Bus Type)

8 ILLUMINATION
Non-Illuminated
A Non-Illuminated

9 ACTUATOR COLOR & LEGEND

| | Actuator Visi ¹ | Legend |
|---|----------------------------|--------|
| 1 | White | Black |
| 2 | Black | White |
| 3 | Red | White |
| 4 | Green | White |
| 5 | Blue | White |
| 6 | Yellow | Black |
| 7 | Gray | Black |
| 8 | Orange | Black |

10 LEGEND
2 ON - OFF Vertical
3 ON - OFF Horizontal
6 Dual Vertical
7 Dual Horizontal

11 BEZEL COLOR
A White without Rockerguard
B Black without Rockerguard
G Gray without Rockerguard
1 White with Rockerguard
2 Black with Rockerguard
7 Gray with Rockerguard

12 AGENCY APPROVAL
T UL 489A Listed

Notes:
 1 Reminder of Rocker same color as Visi
 2 Aux Switch only available with screw terminals



1 SERIES
M

2 ACTUATOR
M Paddle
T Push-Pull

3 POLES
2 Two

4 CIRCUIT/AUXILIARY SWITCH¹
P Series Trip Current (Parallel Pole) with Auxiliary Switch, Silver Contacts
Q Series Trip Current (Parallel Pole) with Auxiliary Switch, Gold Contacts
R Series Trip Current (Parallel Pole) .110 x 0.20 Q.C

5 FREQUENCY & TIME DELAY
D2 DC Short
D4 DC Medium

6 CURRENT RATING (AMPERES)

| CODE | AMPERES |
|------|---------|
| 631 | 31.000 |
| 635 | 35.000 |
| 640 | 40.000 |
| 645 | 45.000 |
| 650 | 50.000 |

7 TERMINAL
A Push in Stud
5 10-32 Screw (Bus Type)

8 ACTUATOR COLOR & LEGEND

| Handle | | Push Button | |
|--------|--------|-------------|--------|
| 1 | White | A | White |
| 2 | Black | B | Black |
| 3 | Red | C | Red |
| 4 | Green | D | Green |
| 5 | Blue | E | Blue |
| 6 | Yellow | F | Yellow |
| 7 | Gray | G | Gray |
| 8 | Orange | H | Orange |

9 FRONT PANEL HARDWARE

Handle
A No outer Panel Hardware
B Knurled Nut, Bright Nickel
C Knurled Nut, Bright Nickel w/Locking Ring
D Knurled Nut, Black
E Knurled Nut, Black w/Locking Ring
F Panel Dress, Bright Nickel
G Panel Dress, Bright Nickel w/Locking Ring
H Panel Dress, Black
J Panel Dress, Black w/Locking Ring

Push Button
1 No outer Panel Hardware
2 Knurled Nut, Bright Nickel

10 LEGEND PLATE / BUTTON MARKING

Handle Actuator Legend Plate
B ON - OFF Vertical
C ON - OFF Horizontal

Push-Pull Actuator Legend Plate
2 Rated Amps Horizontal
3 Rated Amps Line Side Down
4 Rated Amps Line Side Up

11 BUSHING COLOR
B Black

12 AGENCY APPROVAL
T UL 489A Listed

Notes:
1 Aux Switch only available with screw terminals

PARALLEL POLE TERMINAL OPTIONS

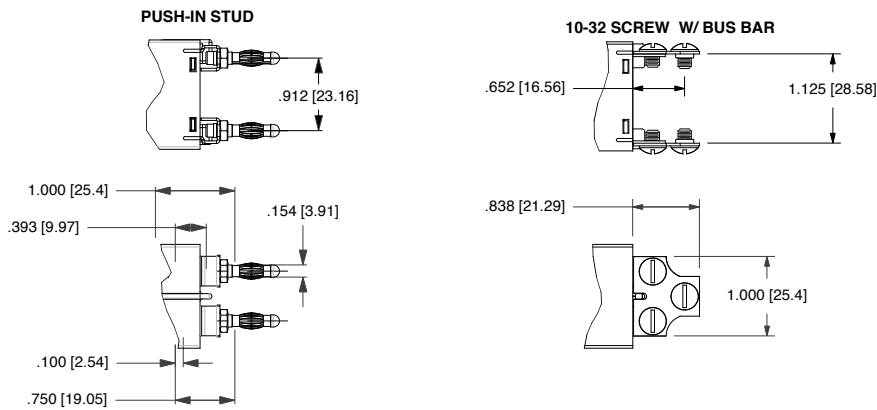

ROCKER ACTUATOR DETAIL

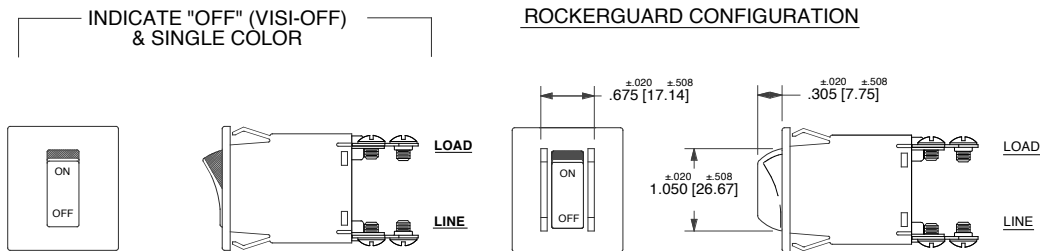
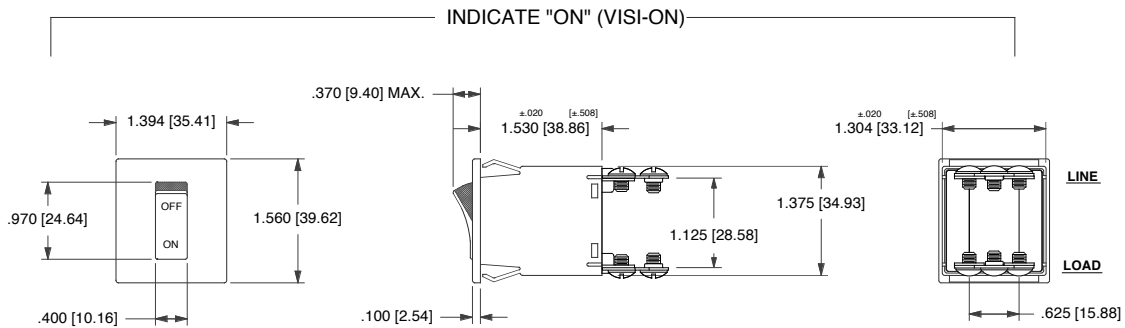

PANEL CUT - OUT DETAIL (ROCKER)

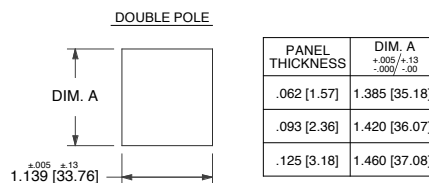

Notes:

- 1 ALL DIMENSIONS ARE IN INCHES (MILLIMETERS).
- 2 TOLERANCE ± 0.10 [2.5] UNLESS OTHERWISE SPECIFIED.
- 3 DIMENSIONS APPLY TO BOTH ROCKER STYLES.
- 4 I-O, ON-OFF OR DUAL LEGENDS AVAILABLE FOR VERTICAL OR HORIZONTAL MOUNTING.
- 5 NOTICE THAT CIRCUIT BREAKER LINE AND LOAD TERMINAL ORIENTATION ON INDICATE "OFF" IS OPPOSITE THAT OF INDICATE "ON".

-PADDLE ACTUATOR STYLE-

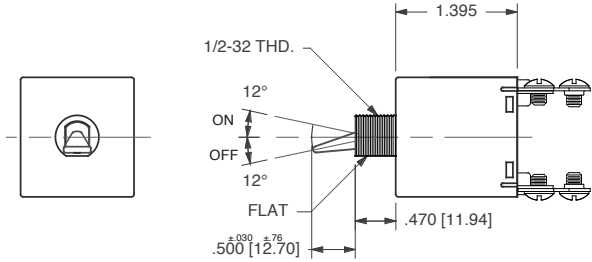

PUSH-PULL ACTUATOR STYLE

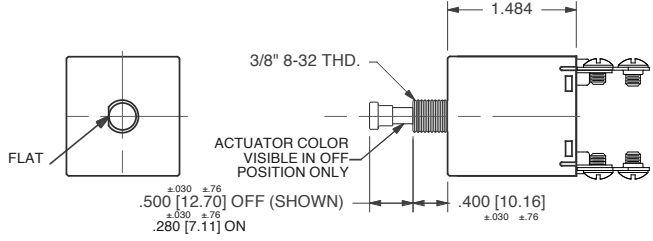

- MOUNTING DETAILS

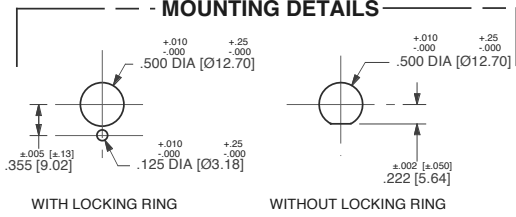

MOUNTING DETAILS

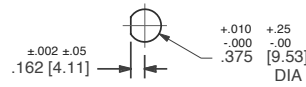

PANEL HARDWARE

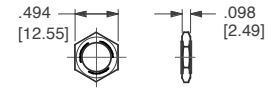

PUSH-PULL, PUSH TO RESET



HEX NUT

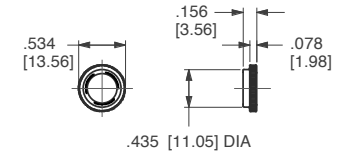

LEGEND PLATES

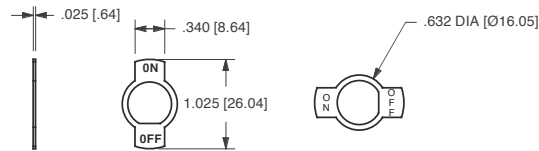

LEGEND CODE:

B

C

PANEL HARDWARE

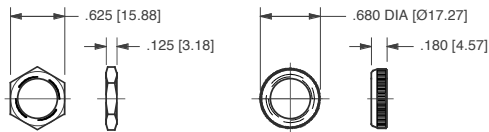

HEX NUT

PANEL DRESS NUT

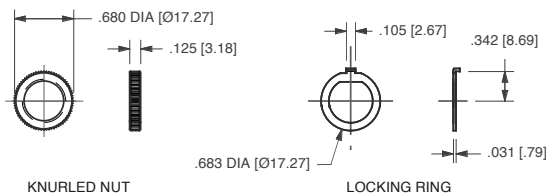

KNURLED NUT

LOCKING RING

BUTTON MARKING ORIENTATION

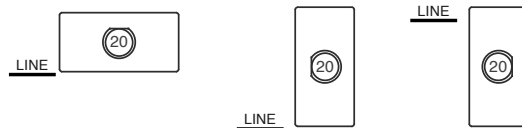

MARKING CODE:

2

3

4

.110QC AUXILIARY SWITCH TERMINALS

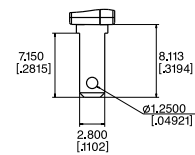

Notes:



- 1 ALL DIMENSIONS ARE IN INCHES [MILLIMETERS].
- 2 TOLERANCE ±.010 [.25] UNLESS OTHERWISE SPECIFIED.
- 3 DIMENSIONS APPLY TO BOTH ROCKER STYLES.
- 4 I-O, ON-OFF OR DUAL LEGENDS AVAILABLE FOR VERTICAL OR HORIZONTAL MOUNTING.
- 5 NOTICE THAT CIRCUIT BREAKER LINE AND LOAD TERMINAL ORIENTATION ON INDICATE "OFF" IS OPPOSITE THAT OF INDICATE "ON".



M M 1 - B 34 - 260 - 1 - 1 B B - C - B



1 Series 2 Actuator 3 Poles 4 Circuit 5 Frequency & Delay 6 Current Rating 7 Terminal 8 Actuator Color 9 Front Panel Hardware 10 Legend Plate 11 Bushing Color 12 Agency Approval

1 SERIES
M

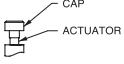
2 ACTUATOR¹

Handle
M Paddle  N Baton 

Push Button
T Push-Pull  U Push To Reset 

Push Button w/ Snap-In Mounting
V Push-Pull  W Push To Reset 

3 POLES
1 One 2 Two

4 CIRCUIT²

without Auxiliary Switch
A Switch Only (no coil) , Maintained Contacts
B Series Trip (Current)

with Auxiliary Switch, Silver Contacts
M Series Trip (Current) Aux Switch
P³ Switch Only, Maintained Contacts
Q^{3,4} Switch Only, Maintained Contacts
R^{3,13} Switch Only, Maintained Contacts
S³ Series Trip (Current)
T^{3,4} Series Trip (Current)
U^{3,13} Series Trip, Maintained Contacts

with Auxiliary Switch, Gold Contacts
2^{3,4} Switch Only, Maintained Contacts
3^{3,13} Switch Only, Maintained Contacts
4^{3,4} Series Trip (Current)
5^{3,13} Series Trip, Maintained Contacts
9 Series Trip (Current) Aux Switch

Terminal Type:
.110 QC x .020 QC
.060 Dia, Round Solder Turret
.058 Dia, Round Q.C.
.080 Dia x .020 Flat Q.C.
.060 Dia, Round Solder Turret
.058 Dia, Round Q.C.
.080 Dia x .020 Flat Q.C.
.058 Dia, Round Q.C.
.080 Dia x .020 Flat Q.C.
.058 Dia, Round Q.C.
.080 Dia x .020 Flat Q.C.
.110 QC x .020 QC

5 FREQUENCY & DELAY

| | | | |
|----|---------------------------|----|-------------------------------|
| 03 | DC 50/60Hz, Switch Only | 32 | DC, 50/60Hz Short |
| 10 | DC Instantaneous | 34 | DC, 50/60Hz Medium |
| 12 | DC Short | 62 | 50/60Hz Short, Hi-Inrush |
| 14 | DC Medium | 64 | 50/60Hz Medium, Hi-Inrush |
| 20 | 50/60Hz Instantaneous | 72 | DC, Short, Hi-Inrush |
| 22 | 50/60Hz Short | 74 | DC, Medium, Hi-Inrush |
| 24 | 50/60Hz Medium | 92 | DC, 50/60Hz Short, Hi-Inrush |
| 30 | DC, 50/60Hz Instantaneous | 94 | DC, 50/60Hz Medium, Hi-Inrush |

| VOLTAGE | | | FULL LOAD AMP RATING | | GENERAL PURPOSE AMP RATING | | TUNGSTEN LAMP RATING | | POLES BREAKING |
|-------------|-----------|-------|----------------------|--|----------------------------|--|----------------------|--|----------------|
| MAX. RATING | FREQUENCY | PHASE | MAX. AMPS | CHOOSE CURRENT COIL RATING CODE ¹ | MAX. AMPS | CHOOSE CURRENT COIL RATING CODE ¹ | MAX. AMPS | CHOOSE CURRENT COIL RATING CODE ¹ | |
| 32 | DC | - | 15 | 615 | 25 | 625 | - | - | 1 |
| 50 | DC | - | - | - | 7.5 | Consult Factory | - | - | 1 |
| 65 | DC | - | 15 | 615 | 25 | 625 | - | - | 2 |
| 125 | 50/60HZ | 1 | 15 | 615 | 25 | 625 | 15 | 615 | 1 |
| 250 | 50/60HZ | 1 | 12 | 612 | - | - | - | - | 1 |
| 250 | 50/60HZ | 1 | 15 | 615 | 25 | 625 | - | - | 2 |

- Notes:
- One actuator is located in the center of each multi-pole breaker. Actuator codes V & W limited to single pole breakers only.
 - Switch Only circuits are not available with Push-To-Reset actuators. For Switch Only circuits, select Current Coil Rating from the above chart.
 - One Auxiliary Switch is supplied per breaker. On two-pole breakers, standard Auxiliary Switch mounting is in pole one. Auxiliary Switch option limited to Series Trip and Switching Only circuits. Not available with back connect screw or push-in stud terminals.
 - Mates with AMP .058" diameter pin receptacles including 60983-1 (gold plated) and 60983-2 (tin plated).
 - Actuator color is only visible in the OFF position on Push-Pull actuators.
 - All units except snap-in mounting have one hex nut installed on bushing for use behind the panel.
 - Other colors available. Consult factory.
 - TUV and VDE Certification above 15 amps is for 2-pole only and is limited to a max. of 20 amps. Screw Terminal or Push-In Stud recommended above 20 amps.
 - 30 amp rating not available with delay's 30, 32, 34, 92 or 94.
 - Screw Terminals are VDE certified only with use of ring terminal attached to wire.
 - Terminal code A available with circuit codes A & B only.
 - Printed circuit board available with UL recognized approval only.
 - Auxiliary switch (flat Q.C.) available with UL recognized approvals only.

6 CURRENT RATING (AMPERES)⁶

| CODE | AMPERES | 225 | 0.250 | 420 | 2.000 | 710 | 10.500 |
|------|---------|-----|-------|-----|--------|-----|--------|
| 025 | 0.025 | 230 | 0.300 | 522 | 2.250 | 611 | 11.000 |
| 030 | 0.030 | 235 | 0.350 | 425 | 2.500 | 711 | 11.500 |
| 035 | 0.035 | 240 | 0.400 | 527 | 2.750 | 612 | 12.000 |
| 040 | 0.040 | 245 | 0.450 | 430 | 3.000 | 712 | 12.500 |
| 045 | 0.045 | 250 | 0.500 | 435 | 3.500 | 613 | 13.000 |
| 050 | 0.050 | 255 | 0.550 | 440 | 4.000 | 614 | 14.000 |
| 055 | 0.055 | 260 | 0.600 | 445 | 4.500 | 615 | 15.000 |
| 060 | 0.060 | 265 | 0.650 | 450 | 5.000 | 616 | 16.000 |
| 065 | 0.065 | 270 | 0.700 | 455 | 5.500 | 617 | 17.000 |
| 070 | 0.070 | 275 | 0.750 | 460 | 6.000 | 618 | 18.000 |
| 075 | 0.075 | 280 | 0.800 | 465 | 6.500 | 620 | 20.000 |
| 080 | 0.080 | 285 | 0.850 | 470 | 7.000 | 622 | 22.000 |
| 085 | 0.085 | 290 | 0.900 | 475 | 7.500 | 624 | 24.000 |
| 090 | 0.090 | 295 | 0.950 | 480 | 8.000 | 625 | 25.000 |
| 090 | 0.095 | 410 | 1.000 | 485 | 8.500 | 630 | 30.000 |
| 210 | 1.100 | 512 | 1.250 | 490 | 9.000 | | |
| 215 | 1.150 | 415 | 1.500 | 495 | 9.500 | | |
| 220 | 0.200 | 517 | 1.750 | 610 | 10.000 | | |

7 TERMINAL⁸

| | | | |
|-----------------|----------------------------|-----------------|-----------------------|
| 1 | Push-On 0.250 Tab (Q.C.) | A ¹¹ | Push-In Stud |
| 2 ¹⁰ | Screw 8-32 w/upturned lugs | P ¹² | Printed Circuit Board |
| 3 ¹⁰ | Screw 8-32 (Bus Type) | | |

8 ACTUATOR COLOR & LEGEND⁵

| Gloss Handle | Push-Button | Actuator Color |
|--------------|-------------|----------------|
| 1 | A | White |
| 2 | B | Black |
| 3 | C | Red |
| 4 | D | Green |
| 5 | E | Blue |
| 6 | F | Yellow |
| 8 | H | Orange |

9 FRONT PANEL HARDWARE⁹

| | Handle | Push-Button |
|---------------------------------|--------|-------------|
| No outer Panel Hardware | A | 1 |
| Knurled Nut | | |
| Bright nickel | B | 2 |
| Bright nickel with locking ring | C | |
| Black | D | |
| Black with locking ring | E | |
| Panel Dress Nut | | |
| Bright nickel | F | |
| Bright nickel with locking ring | G | |
| Black | H | |
| Black with locking ring | J | |

10 LEGEND PLATE / BUTTON MARKING

Handle Actuator Legend Plate (Actuator Styles M & N)

- A No Legend Plate
- B ON - OFF Vertical
- C ON - OFF Horizontal
- D I - O Vertical
- E I - O Horizontal

Push-Pull Actuator Button Cap (Actuator Styles T & V)

- 1 No Marking
- 2 Rated Amps Horizontal
- 3 Rated Amps Line Side Down
- 4 Rated Amps Line Side Up

Push-to-Reset Actuator Button (Actuator Styles U & W)

- 1 No Marking

11 BUSHING COLOR⁷
B Black

12 AGENCY APPROVAL⁹

- C UL Recognized & CSA Accepted
- D VDE Certified, UL Recognized & CSA Accepted
- E TUV Certified, UL Recognized & CSA Accepted



1 SERIES
M

2 ACTUATOR¹

Handle
M Paddle **N** Baton

Push Button
T Push-Pull **U⁸** Push To Reset

Push Button w/ Snap-In Mounting
V Push-Pull **W⁸** Push To Reset

3 POLES
1 One

4 CIRCUIT
without Auxiliary Switch
B Series Trip (Current)
with Auxiliary Switch, Silver Contacts
M Series Trip (Current) Aux Switch
S² Series Trip (Current)
T^{2,3} Series Trip (Current)
U^{3,12} Series Trip, Maintained Contacts
with Auxiliary Switch, Gold Contacts
4^{2,3} Series Trip (Current)
5^{3,12} Series Trip, Maintained Contacts
9 Series Trip (Current) Aux Switch

Terminal Type:
.110 QC x .020 QC
.060 Dia, Round Solder Turret
.058 Dia, Round Q.C.
.080 Dia x .020 Flat Q.C.
.058 Dia, Round Q.C.
.080 Dia x .020 Flat Q.C.
.110 QC x .020 QC

5 FREQUENCY & DELAY

| | |
|----------------------------|---------------------------------|
| 10 DC Instantaneous | 14 DC Medium |
| 12 DC Short | 72 DC, Short, Hi-Inrush |
| | 74 DC, Medium, Hi-Inrush |

6 CURRENT RATING (AMPERES)

| CODE | AMPERES | | | | |
|------|---------|-----|-------|-----|--------|
| 020 | 0.020 | 225 | 0.250 | 420 | 2.000 |
| 025 | 0.025 | 230 | 0.300 | 522 | 2.250 |
| 030 | 0.030 | 235 | 0.350 | 425 | 2.500 |
| 035 | 0.035 | 240 | 0.400 | 527 | 2.750 |
| 040 | 0.040 | 245 | 0.450 | 430 | 3.000 |
| 045 | 0.045 | 250 | 0.500 | 435 | 3.500 |
| 050 | 0.050 | 255 | 0.550 | 440 | 4.000 |
| 055 | 0.055 | 260 | 0.600 | 445 | 4.500 |
| 060 | 0.060 | 265 | 0.650 | 450 | 5.000 |
| 065 | 0.065 | 270 | 0.700 | 455 | 5.500 |
| 070 | 0.070 | 275 | 0.750 | 460 | 6.000 |
| 075 | 0.075 | 280 | 0.800 | 465 | 6.500 |
| 080 | 0.080 | 285 | 0.850 | 470 | 7.000 |
| 085 | 0.085 | 290 | 0.900 | 475 | 7.500 |
| 090 | 0.090 | 295 | 0.950 | 480 | 8.000 |
| 090 | 0.095 | 410 | 1.000 | 485 | 8.500 |
| 210 | 0.100 | 512 | 1.250 | 490 | 9.000 |
| 215 | 0.150 | 415 | 1.500 | 495 | 9.500 |
| 220 | 0.200 | 517 | 1.750 | 610 | 10.000 |

7 TERMINAL⁴

| | |
|-------------------------------------|---|
| 1 Push-On 0.250 Tab (Q.C.) | A¹⁰ Push-In Stud |
| 2 Screw 8-32 w/upturned lugs | P¹¹ Printed Circuit Board |
| 3 Screw 8-32 (Bus Type) | |

8 ACTUATOR COLOR & LEGEND⁵

| Gloss Handle | Push-Button | Actuator Color |
|--------------|-------------|----------------|
| 1 | A | White |
| 2 | B | Black |
| 3 | C | Red |
| 4 | D | Green |
| 5 | E | Blue |
| 6 | F | Yellow |
| 8 | H | Orange |

9 FRONT PANEL HARDWARE⁶

| | Handle | Push-Button |
|---------------------------------|----------|-------------|
| No outer Panel Hardware | A | 1 |
| Knurled Nut | | |
| Bright nickel | B | 2 |
| Bright nickel with locking ring | C | |
| Black | D | |
| Black with locking ring | E | |
| Panel Dress Nut | | |
| Bright nickel | F | |
| Bright nickel with locking ring | G | |
| Black | H | |
| Black with locking ring | J | |

10 LEGEND PLATE / BUTTON MARKING

Handle Actuator Legend Plate (Actuator Styles M & N)

A No Legend Plate
B ON - OFF Vertical
C ON - OFF Horizontal
D I - O Vertical
E I - O Horizontal

Push-Pull Actuator Button Cap (Actuator Styles T & V)

1⁹ No Marking
2 Rated Amps Horizontal
3 Rated Amps Line Side Down
4 Rated Amps Line Side Up

Push-to-Reset Actuator Button (Actuator Styles U & W)

1⁸ No Marking

11 BUSHING COLOR⁷

B Black

12 AGENCY APPROVAL⁸

J UL489A Listed, TUV Certified
M UL Recognized, CSA Accepted
N UL Recognized, TUV Certified
T UL489A Listed

Notes:

- 1 One actuator is located in the center of each multi-pole breaker. Actuator codes V & W limited to single pole breakers only.
- 2 One Auxiliary Switch is supplied per breaker. On two-pole breakers, standard Auxiliary Switch mounting is in pole one. Auxiliary Switch option limited to Series Trip and Switch Only circuits. Not available with Back Connected Screw or Push-in Stud terminals.
- 3 Mates with AMP .058" diameter pin receptacles including 60983-1 (gold plated) and 60983-3 (tin plated).
- 4 Screw terminals or Push-in Stud recommended above 20 amps.
- 5 Actuator color is only visible in the OFF position on Push-Pull actuators.
- 6 All units have one hex nut installed on bushing for use behind the panel.
- 7 Other colors available. Consult factory.
- 8 Not available with UL489A Listed breakers.
- 9 TUV certified to 25 amps. UL Recognized, CSA Accepted and UL Listed to 30 amps.
- 10 Terminal code A available with circuit codes A & B only.
- 11 Printed circuit board available with UL recognized approval only.
- 12 Auxiliary switch (flat Q.C.) available with UL recognized approvals only.

SERIES TRIP

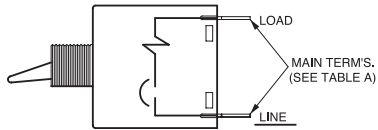

SWITCH ONLY

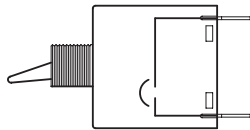

**SERIES TRIP W/
AUXILIARY SWITCH**

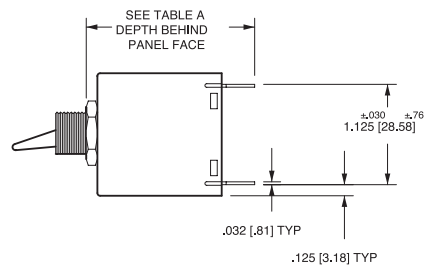
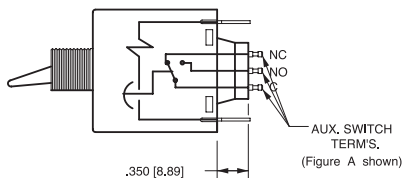

| TABLE A | | |
|----------------------|---------------------------|---------------------------|
| TERMINAL DESCRIPTION | | DEPTH BEHIND PANEL FACE * |
| MAIN | TAB (Q.C.) | 1.890 [48.00] |
| | SCREW (#8-32) | 1.930 [49.03] |
| | PUSH-IN STUD | 2.520 [64.00] |
| AUX. ** SWITCH | DOUBLE SOLDER TURRET TYPE | 2.035 [51.69] |
| | ROUND Q.C. TYPE | 2.025 [51.44] |
| | FLAT QUICK-CONNECT | 2.129 [54.08] |
| | FLAT SOLDER LUG | 2.012 [51.10] |

*DEPTH INCLUDES BEHIND PANEL HEX NUT AS SUPPLIED ON ALL UNITS.

**WHEN CALLED FOR ON MULTI-POLE UNITS, ONLY ONE AUX. SWITCH IS NORMALLY SUPPLIED, MOUNTED AS SHOWN IN FIG. A

MULTI-POLE IDENTIFICATION SCHEME

SOLDER TURRET AND ROUND QC AUX SWITCH TERMINALS

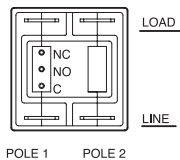

FIG. A

FLAT QC AND SOLDER LUG AUX SWITCH TERMINALS

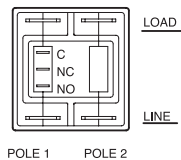
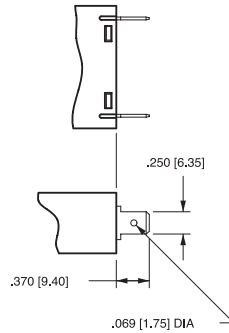

FIG. B

- Notes:
 1 All dimensions are in inches [millimeters].
 2 Tolerance ±.020 [.51] unless otherwise specified.

TERMINAL DIMENSIONAL DETAIL

**TAB (Q.C.)
TERMINAL**



**SCREW TERMINAL
#8-32 WITH
UPTURNED LUGS**

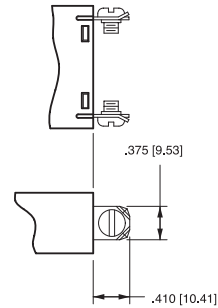

**SCREW TERMINAL
#8-32
BUS**

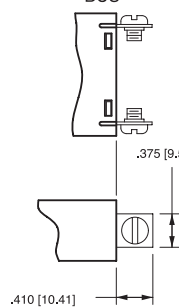

**PUSH-IN STUD
TERMINAL**

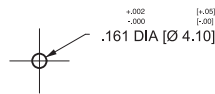
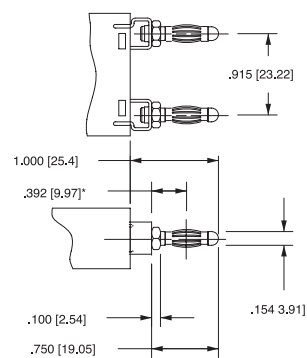

PUSH-IN STUD
MATING HOLE

*CENTERLINE OF
PUSH-IN STUD
CONTACT AREA

AUXILIARY SWITCH TERMINALS

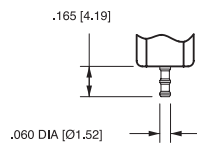

**DOUBLE SOLDER
TURRET TYPE**

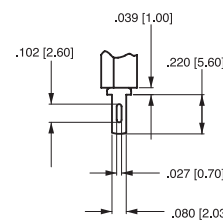

**.080 [2.03] X .020 [.51] FLAT
QUICK-CONNECT
TYPE**

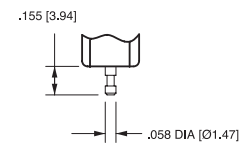

**ROUND
QUICK-CONNECT
TYPE**

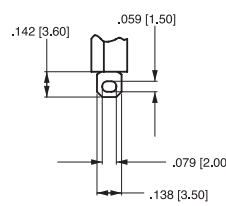

**FLAT
SOLDER LUG
TYPE**

*AVAILABLE THROUGH SPECIAL
CATALOG PART NUMBER

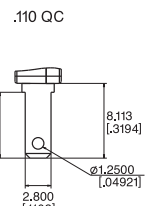

HANDLE TYPE SHOWN WITHOUT AUX. SWITCH

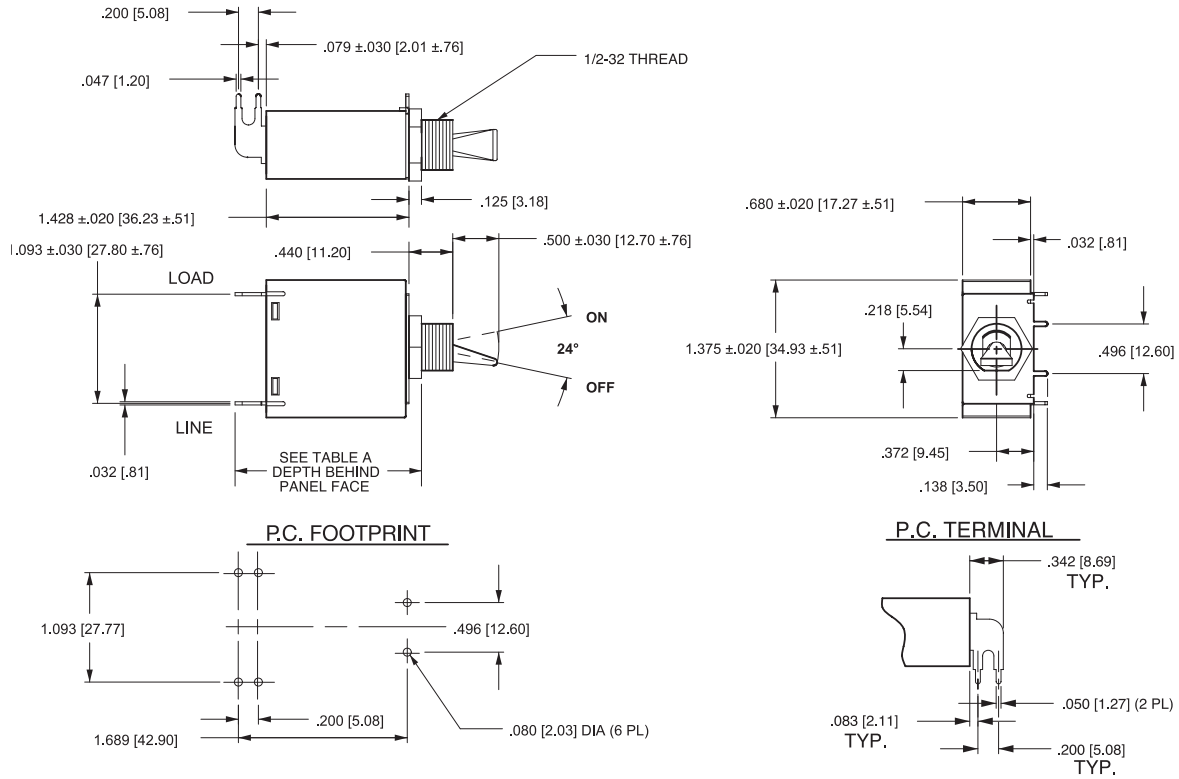

HANDLE TYPE SHOWN WITH AUX. SWITCH

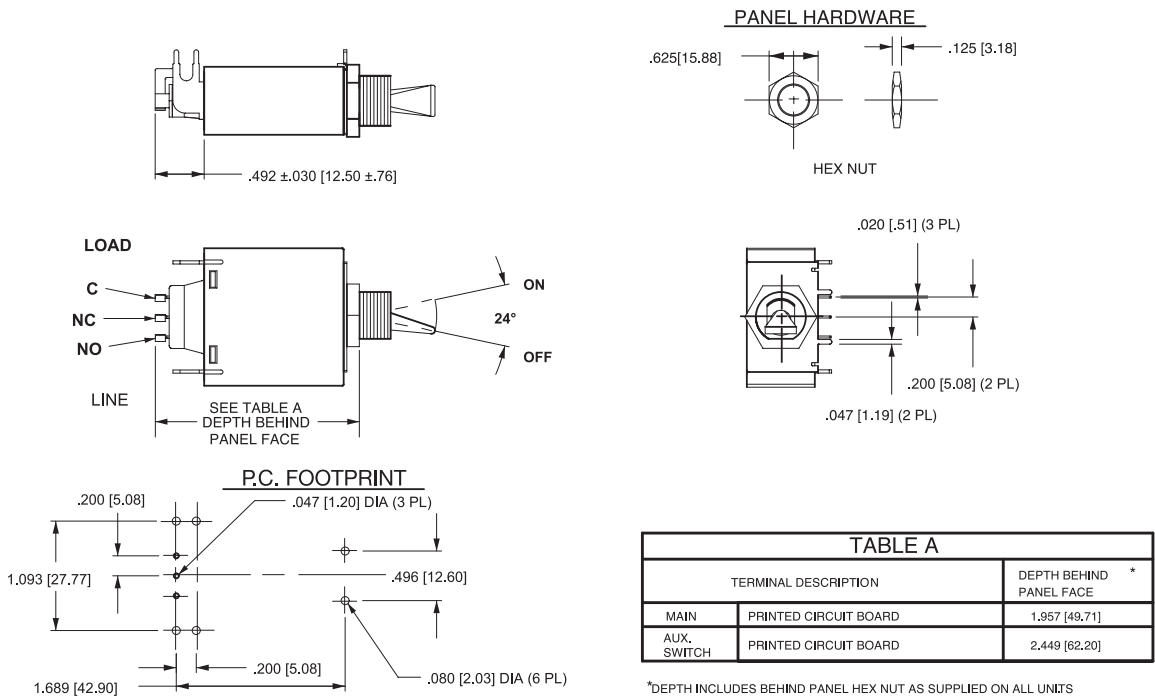

| TABLE A | | DEPTH BEHIND PANEL FACE * |
|----------------------|-----------------------|---------------------------|
| TERMINAL DESCRIPTION | | |
| MAIN | PRINTED CIRCUIT BOARD | 1.957 [49.71] |
| AUX. SWITCH | PRINTED CIRCUIT BOARD | 2.449 [62.20] |

*DEPTH INCLUDES BEHIND PANEL HEX NUT AS SUPPLIED ON ALL UNITS

- Notes:
 1 All dimensions are in inches [millimeters].
 2 Tolerance ± 0.020 [.51] unless otherwise specified.

PADDLE ACTUATOR STYLE

SINGLE POLE

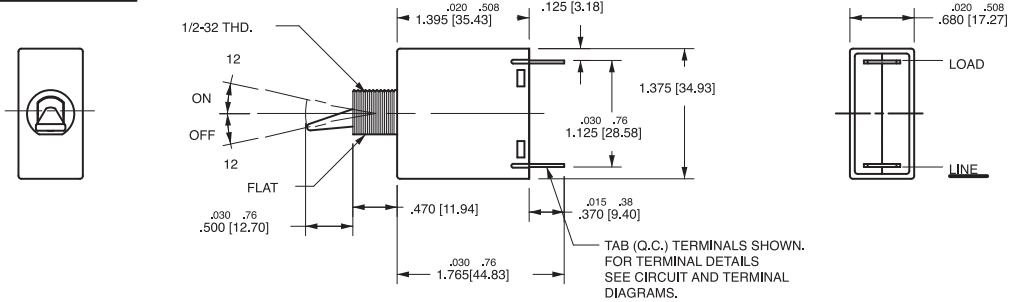

DOUBLE POLE

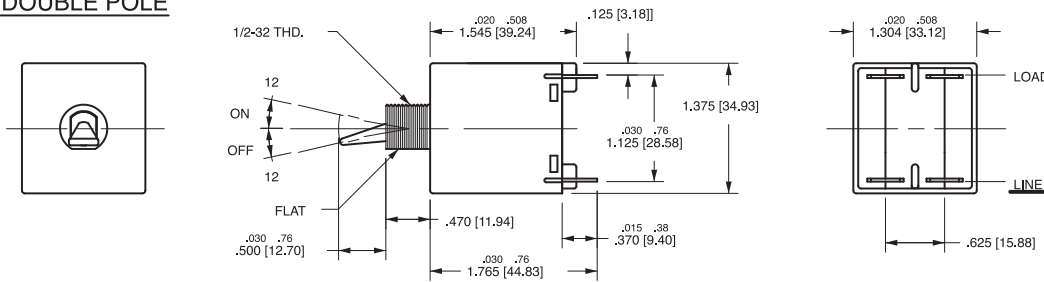

BATON ACTUATOR STYLE

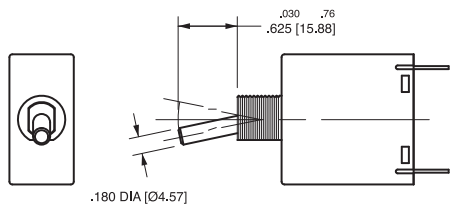

MOUNTING DETAILS

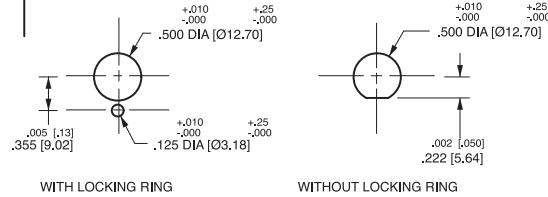

LEGEND PLATES

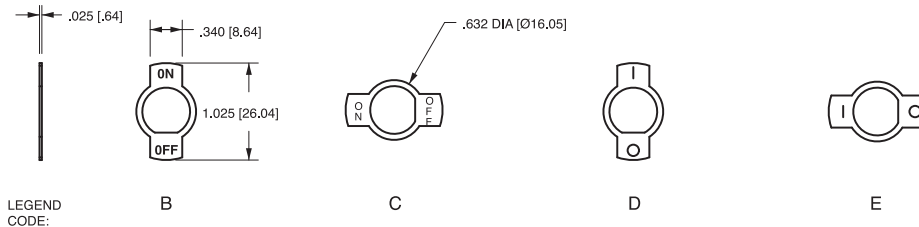

PANEL HARDWARE

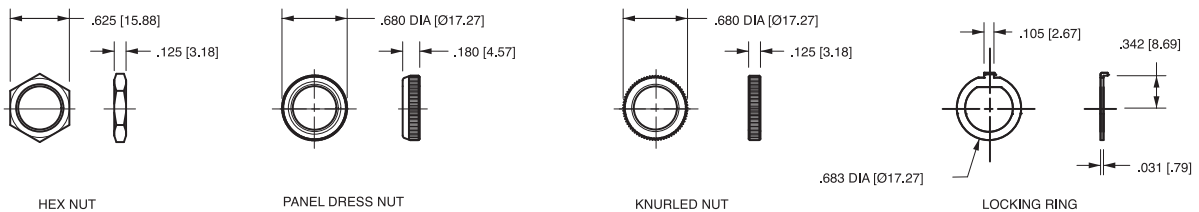

- Notes:
 1 All dimensions are in inches [millimeters].
 2 Tolerance $\pm .020$ [.51] unless otherwise specified.

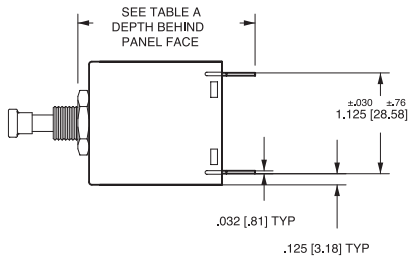
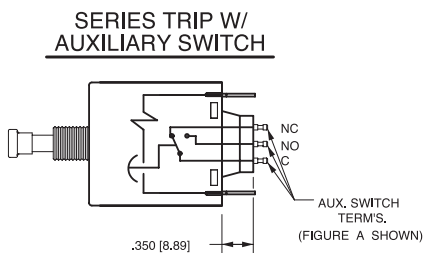
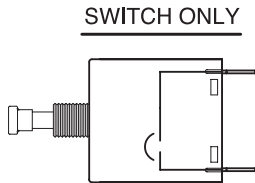
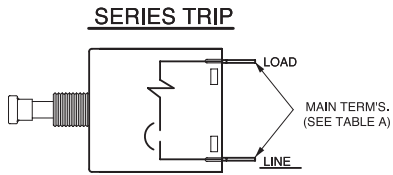

| TERMINAL DESCRIPTION | | DEPTH BEHIND PANEL FACE * |
|----------------------|---------------------------|---------------------------|
| MAIN | TAB (Q.C) | 1.952 [49.57] |
| | SCREW (#8-32) | 1.992 [50.60] |
| | PUSH-IN STUD | 2.582 [65.58] |
| AUX. ** SWITCH | DOUBLE SOLDER TURRET TYPE | 2.097 [53.26] |
| | ROUND Q.C TYPE | 2.087 [53.01] |
| | FLAT QUICK-CONNECT | 2.191 [55.65] |
| | FLAT SOLDER LUG | 2.074 [52.68] |

*DEPTH INCLUDES BEHIND PANEL HEX NUT AS SUPPLIED ON ALL UNITS.

** WHEN CALLED FOR ON MULTI-POLE UNITS, ONLY ONE AUX. SWITCH IS NORMALLY SUPPLIED, MOUNTED AS SHOWN IN FIG. A

MULTI-POLE IDENTIFICATION SCHEME

SOLDER TURRET AND ROUND QC AUX SWITCH TERMINALS

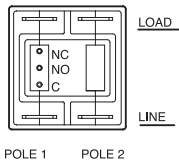

FIG. A

FLAT QC AND SOLDER LUG AUX SWITCH TERMINALS

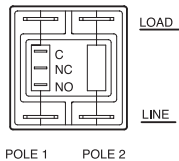
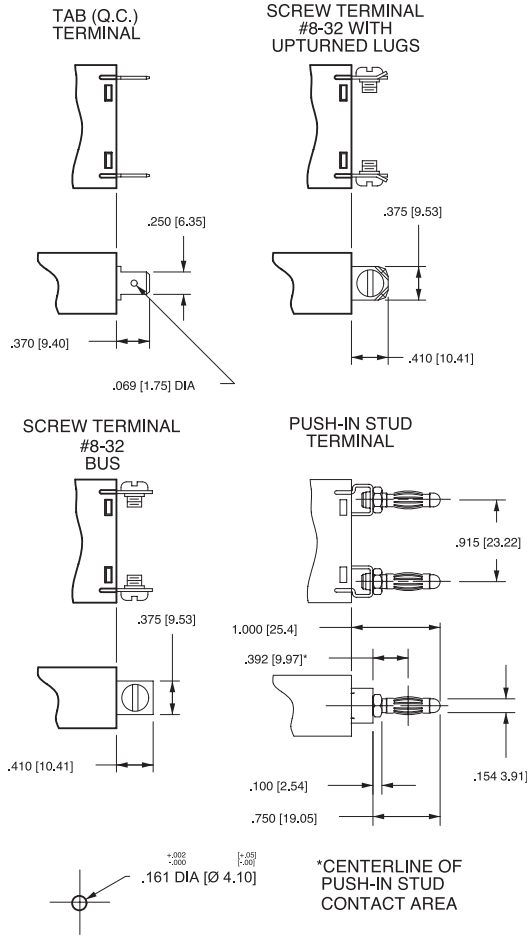

FIG. B

- Notes:
- All dimensions are in inches [millimeters].
 - Tolerance $\pm .020$ [.51] unless otherwise specified.

TERMINAL DIMENSIONAL DETAIL



PUSH-IN STUD MATING HOLE

AUXILIARY SWITCH TERMINALS

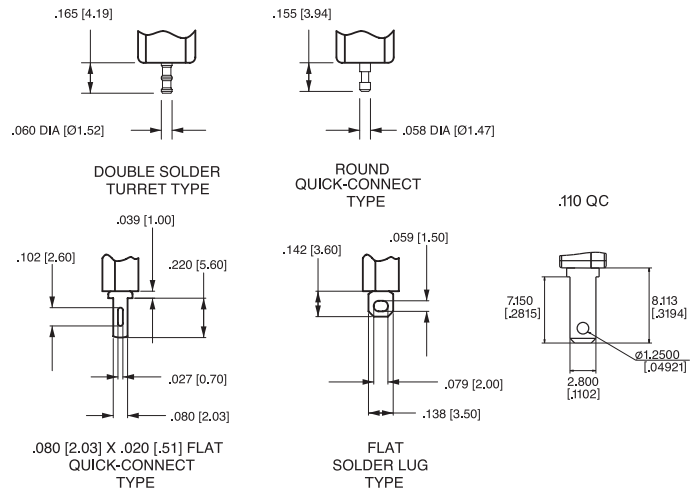

*AVAILABLE THROUGH SPECIAL CATALOG PART NUMBER

PUSH-PULL ACTUATOR STYLE

SINGLE POLE

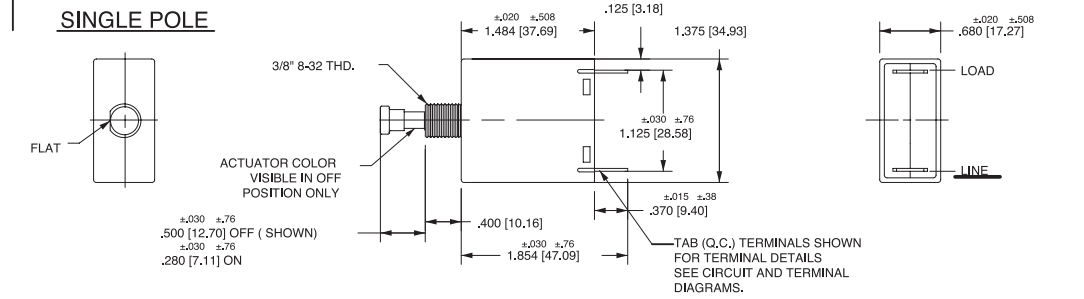

DOUBLE POLE

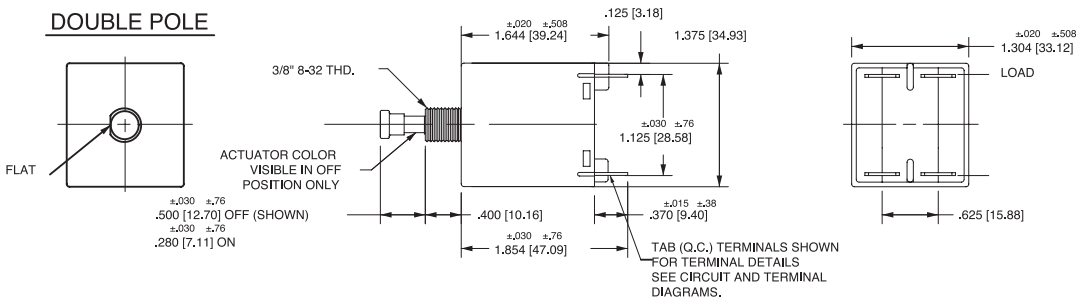

PUSH-TO-RESET ACTUATOR STYLE

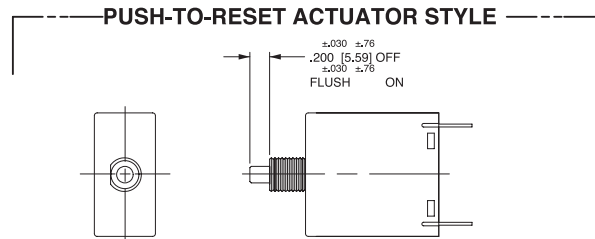

MOUNTING DETAILS

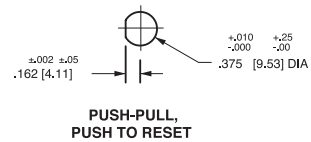

SNAP-IN BUSHING ACTUATOR STYLE

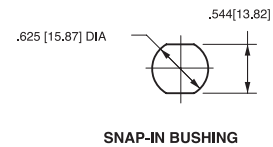
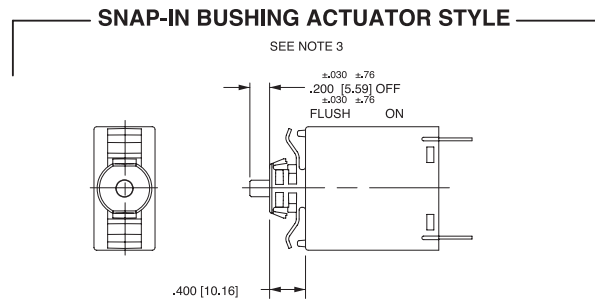

PANEL HARDWARE



BUTTON MARKING ORIENTATION (PUSH-PULL ONLY)

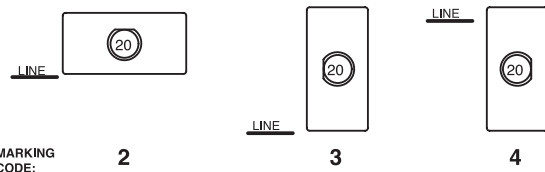

MARKING CODE:

Notes:

- 1 All dimensions are in inches [millimeters].
- 2 Tolerance ± 0.20 [5.1] unless otherwise specified.
- 3 Available with Push-Pull or Push-to-Reset Actuators

HEX NUT

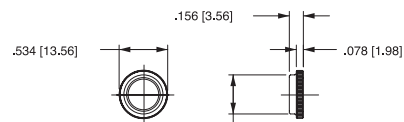

PANEL DRESS NUT

PUSH-PULLTYPE SHOWN WITHOUT AUX. SWITCH

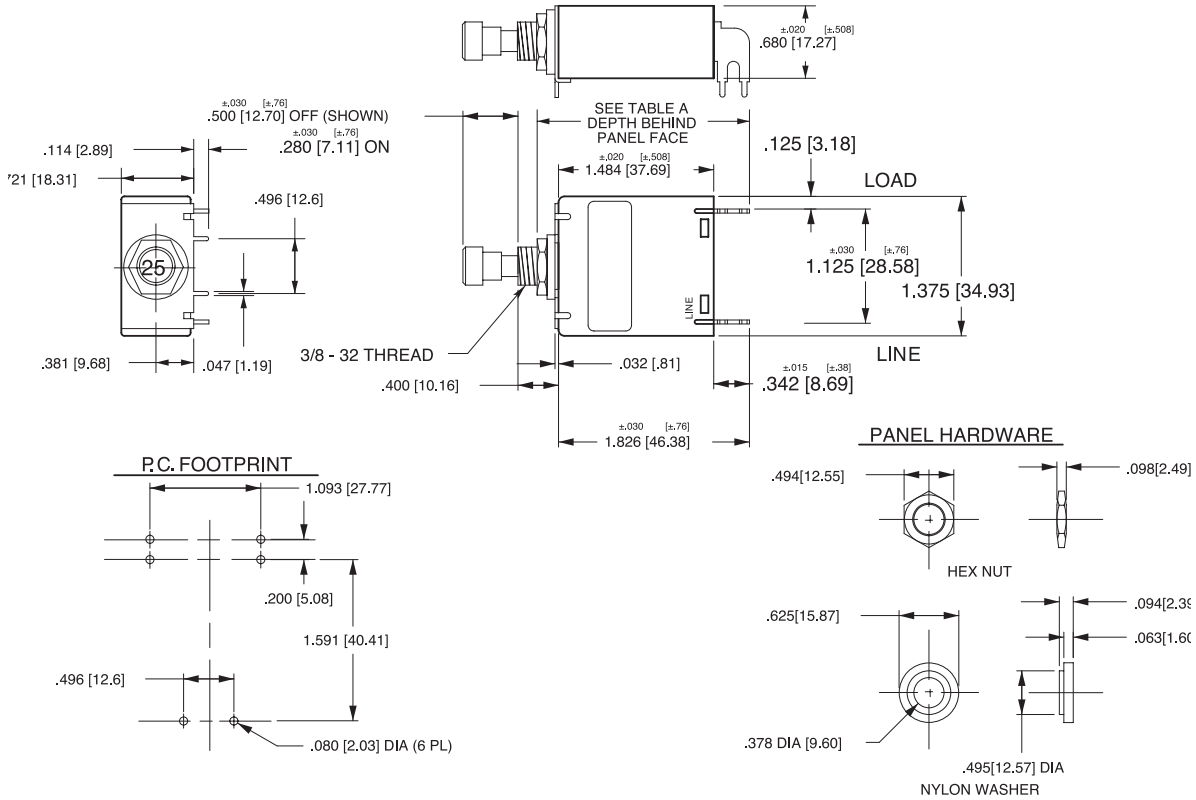

PUSH-PULL TYPE SHOWN WITH AUX. SWITCH

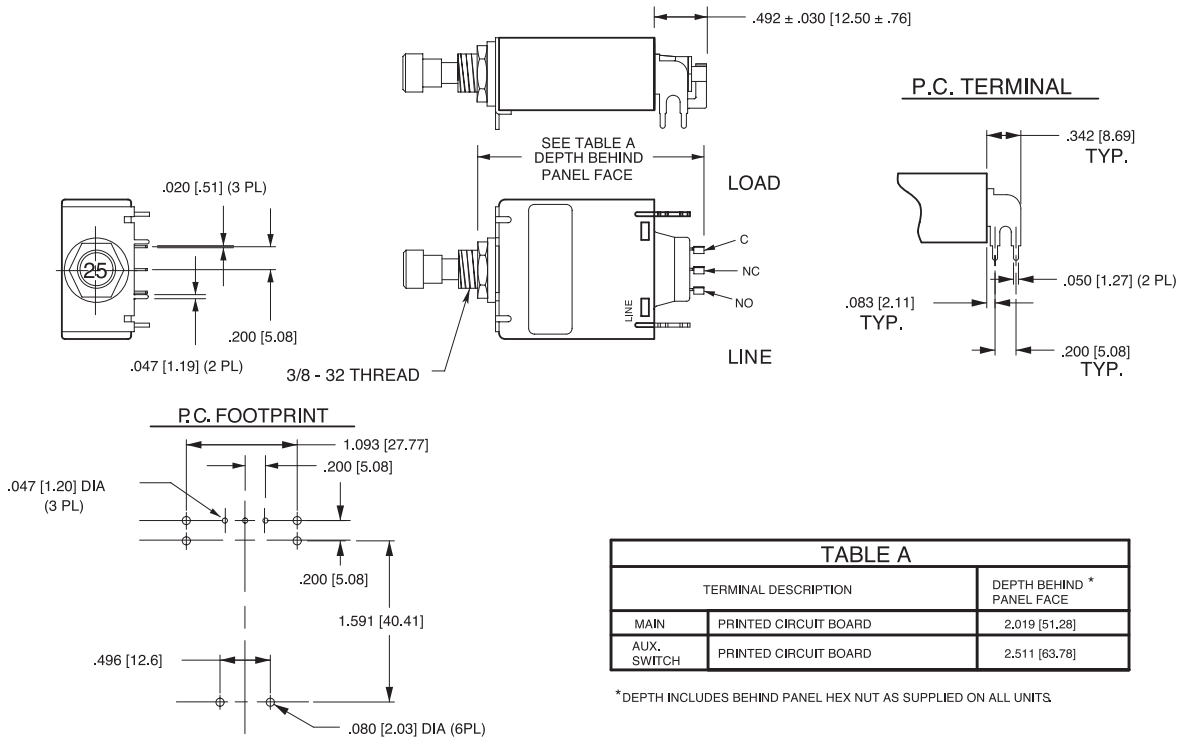

Notes:

- All dimensions are in inches [millimeters].
- Tolerance ± 0.020 [51] unless otherwise specified.

M **G** **2** - **B** **34** - **620** - **1** - **H** **C** **6** - **7** - **C**

1 Series 2 Actuator 3 Poles 4 Circuit 5 Frequency & Delay 6 Current Rating 7 Terminal 8 Illumination 9 Actuator Color 10 Legend 11 Bezel Color 12 Agency Approval

1 SERIES
M

2 ACTUATOR¹

Non-Illuminated single color
A Angled
B Flat

Two Color Visi-Rocker
D Indicate ON
E Indicate OFF

illuminated single color
F Angled
G Flat

ROCKER STYLE DESCRIPTION
(SEE LEGEND PAGES)

| STYLE | ROCKERS "ON" | ROCKERS "OFF" | FLAT | ANGLED |
|------------|--------------|---------------|------|--------|
| VERTICAL | | | | |
| HORIZONTAL | | | | |

3 POLES
1 One **2** Two

4 CIRCUIT²

without Auxiliary Switch
A Switch Only (no coil) , Maintained Contacts
B Series Trip (Current)

with Auxiliary Switch, Silver Contacts
M Series Trip (Current) Aux Switch
P³ Switch Only, Maintained Contacts
Q^{3,4} Switch Only, Maintained Contacts
R^{3,16} Switch Only, Maintained Contacts
S³ Series Trip (Current)
T^{3,4} Series Trip (Current)
U^{3,16} Series Trip, Maintained Contacts

with Auxiliary Switch, Gold Contacts
2^{3,4} Switch Only, Maintained Contacts
3^{3,16} Switch Only, Maintained Contacts
4^{3,4} Series Trip (Current)
5^{3,16} Series Trip, Maintained Contacts
9 Series Trip (Current) Aux Switch

Terminal Type:
.110 QC x .020 QC
.060 Dia, Round Solder Turret
.058 Dia, Round Q.C.
.080 Dia x .020 Flat Q.C.
.060 Dia, Round Solder Turret
.058 Dia, Round Q.C.
.080 Dia x .020 Flat Q.C.

5 FREQUENCY & DELAY

| | |
|-------------------------------------|---|
| 03 DC 50/60Hz, Switch Only | 32 DC, 50/60Hz Short |
| 10 DC Instantaneous | 34 DC, 50/60Hz Medium |
| 12 DC Short | 62 50/60Hz Short, Hi-Inrush |
| 14 DC Medium | 64 50/60Hz Medium, Hi-Inrush |
| 20 50/60Hz Instantaneous | 72 DC, Short, Hi-Inrush |
| 22 50/60Hz Short | 74 DC, Medium, Hi-Inrush |
| 24 50/60Hz Medium | 92 DC, 50/60Hz Short, Hi-Inrush |
| 30 DC, 50/60Hz Instantaneous | 94 DC, 50/60Hz Medium, Hi-Inrush |

| VOLTAGE | | | FULL LOAD AMP RATING | | GENERAL PURPOSE AMP RATING | | TUNGSTEN LAMP RATING | |
|-------------|-----------|-------|----------------------|----------------------------------|----------------------------|----------------------------------|----------------------|----------------------------------|
| MAX. RATING | FREQUENCY | PHASE | MAX. AMPS | CHOOSE CURRENT COIL RATING CODE: | MAX. AMPS | CHOOSE CURRENT COIL RATING CODE: | MAX. AMPS | CHOOSE CURRENT COIL RATING CODE: |
| 32 | DC | - | 15 | 615 | 25 | 625 | - | - |
| 50 | DC | - | - | - | 7.5 | Consult Factory | - | - |
| 65 | DC | - | 15 | 615 | 25 | 625 | - | 2 |
| 125 | 50/60HZ | 1 | 15 | 615 | 25 | 625 | 15 | 615 |
| 250 | 50/60HZ | 1 | 12 | 612 | - | - | - | 1 |
| 250 | 50/60HZ | 1 | 15 | 615 | 25 | 625 | - | 2 |

- Notes:
- One actuator is located in the center of each multi-pole breaker.
 - For Switch Only circuits, select Current Coil Rating from the above chart.
 - One Auxiliary Switch is supplied per breaker. On two-pole breakers, standard Auxiliary Switch mounting is in pole one. Auxiliary Switch option limited to Series Trip & Switch Only circuits, & is not available in single pole illuminated breakers, or Back Connected Screw or Push-in Stud terminals.
 - Mates with AMP .058" diameter pin receptacles: 60983-1 (gold plated) & 60983-2 (tin plated).
 - For neon bulb applications at 120VAC @ 47K, 1/4 WATT and for 250VAC applications @ 150K, 1/4 WATT, external resistors must be supplied by customer.
 - On Visi-Rocker breakers, Visi portion of rocker cannot be the same color as the bezel.
 - For LED (DC or rectified AC) applications, LED is mounted in the center of the rocker actuator with electrical characteristics: 100 millicandela at 20mA; Maximum power dissipation = 75mW at 25°C; Maximum forward current = 25mA; Typical forward voltage = 2.1V at 20mA; Typical reverse current = 100uA at 3V. Customer supplies the proper external resistor limiting current to these values.
 - Rocker color for LED's and green neon lamp must be clear, smoke gray, white translucent or match color of LED or neon lamp.
 - Other colors available. Consult factory.
 - TUV 20A, VDE 15A, UL Recognized and CSA Accepted to 30 amps.
 - Screw Terminals or Push-in Stud recommended above 20 amps.
 - TUV or VDE Certified must have I-O or Dual Legends. Legend required on Visi-Rocker breakers.
 - 30 amp rating not available with delay's 30, 32, 34, 92 or 94.
 - Screw Terminals are VDE certified only with use of ring terminal attached to wire.
 - Terminal code A available with circuit codes A & B only.
 - Printed circuit board available with UL recognized approval only.
 - Auxiliary switch (flat Q.C.) available with UL recognized approvals only.

6 CURRENT RATING (AMPERES)

| CODE | AMPERES | | | | |
|------|---------|-----|-------|-----|--------|
| 020 | 0.020 | 225 | 0.250 | 420 | 2.000 |
| 025 | 0.025 | 230 | 0.300 | 522 | 2.250 |
| 030 | 0.030 | 235 | 0.350 | 425 | 2.500 |
| 035 | 0.035 | 240 | 0.400 | 527 | 2.750 |
| 040 | 0.040 | 245 | 0.450 | 430 | 3.000 |
| 045 | 0.045 | 250 | 0.500 | 435 | 3.500 |
| 050 | 0.050 | 255 | 0.550 | 440 | 4.000 |
| 055 | 0.055 | 260 | 0.600 | 445 | 4.500 |
| 060 | 0.060 | 265 | 0.650 | 450 | 5.000 |
| 065 | 0.065 | 270 | 0.700 | 455 | 5.500 |
| 070 | 0.070 | 275 | 0.750 | 460 | 6.000 |
| 075 | 0.075 | 280 | 0.800 | 465 | 6.500 |
| 080 | 0.080 | 285 | 0.850 | 470 | 7.000 |
| 085 | 0.085 | 290 | 0.900 | 475 | 7.500 |
| 090 | 0.090 | 295 | 0.950 | 480 | 8.000 |
| 090 | 0.095 | 410 | 1.000 | 485 | 8.500 |
| 210 | 0.100 | 512 | 1.250 | 490 | 9.000 |
| 215 | 0.150 | 415 | 1.500 | 495 | 9.500 |
| 220 | 0.200 | 517 | 1.750 | 610 | 10.000 |

7 TERMINAL

| | |
|--|---|
| 1 Push-On 0.250 Tab (Q.C.) | A¹⁴ Push-In Stud |
| 2¹⁰ Screw 8-32 w/upturned lugs | P¹⁵ Printed Circuit Board |
| 3¹⁰ Screw 8-32 (Bus Type) | |

8 ROCKER ILLUMINATION

Non-illuminated
Neon⁵
 without resistor, 120VAC/250VAC
LED^{7,8}
 without resistor
 with resistor, 4-8 VDC
 with resistor, 9-16 VDC

| | |
|----------------|-------------------------|
| A Neon | Green Glow ⁸ |
| B Red | Green |
| C Amber | Amber |
| D White | White |
| E Black | Black |
| F Gray | Gray |

9 ACTUATOR & LEGEND COLOR

| Solid Color | Actuator | Legend |
|-------------|----------|--------|
| 1 | White | Black |
| 2 | Black | White |
| 3 | Red | White |
| 4 | Green | White |
| 5 | Blue | White |
| 6 | Yellow | Black |
| 7 | Gray | Black |
| 8 | Orange | Black |

Visi-Rocker⁶
 Visi & Legend (remainder of rocker same color as bezel)

| | | |
|---|--------|--|
| 1 | White | |
| 2 | Black | |
| 3 | Red | |
| 4 | Green | |
| 5 | Blue | |
| 6 | Yellow | |
| 7 | Gray | |
| 8 | Orange | |

Illuminated⁸

| | |
|---------------------------------|--------|
| A Clear | Legend |
| B Red Transparent | White |
| C Green Transparent | White |
| D Amber Transparent | White |
| E Smoke Gray Transparent | White |
| F White Translucent | Black |

10 LEGEND¹¹

| | |
|------------------------------|---------------------------|
| 1 No Legend | 4 I - O Vertical |
| 2 ON - OFF Vertical | 5 I - O Horizontal |
| 3 ON - OFF Horizontal | 6 Dual Vertical |
| | 7 Dual Horizontal |

11 BEZEL COLOR / STYLE⁹

| Color | without Rockerguard | with Rockerguard |
|-------|---------------------|------------------|
| White | A | 1 |
| Black | B | 2 |
| Gray | G | 7 |

12 AGENCY APPROVAL¹⁰

| |
|--|
| C UL Recognized & CSA Accepted |
| D VDE Certified, UL Recognized & CSA Accepted |
| E TUV Certified, UL Recognized & CSA Accepted |



1 SERIES
M

2 ACTUATOR¹
Non-Illuminated single color
A Angled
B Flat

Two Color Visi-Rocker
D Indicate ON
E Indicate OFF

Illuminated single color
F Angled
G Flat

ROCKER STYLE DESCRIPTION
ON - OFF POSITION

| STYLE | INDICATE "ON" | INDICATE "OFF" | FLAT | ANGLED |
|------------|---------------|----------------|------|--------|
| VERTICAL | | | | |
| HORIZONTAL | | | | |

3 POLES
1 One

4 CIRCUIT²
without Auxiliary Switch
B Series Trip (Current)
with Auxiliary Switch, Silver Contacts
M Series Trip (Current) Aux Switch
S Series Trip (Current)
T³ Series Trip (Current)
U^{3,13} Series Trip, Maintained Contacts
with Auxiliary Switch, Gold Contacts
4³ Series Trip (Current)
5^{3,13} Series Trip, Maintained Contacts
9 Series Trip (Current) Aux Switch

Terminal Type:
 .110 QC x .020 QC
 .060 Dia, Round Solder Turret
 .058 Dia, Round Q.C.
 .080 Dia x .020 Flat Q.C.

5 FREQUENCY & DELAY

| | |
|----------------------------|---------------------------------|
| 10 DC Instantaneous | 14 DC Medium |
| 12 DC Short | 72 DC, Short, Hi-Inrush |
| | 74 DC, Medium, Hi-Inrush |

6 CURRENT RATING (AMPERES)⁸

| CODE | AMPERES | | | | |
|------|---------|-----|-------|-----|--------|
| 020 | 0.020 | 225 | 0.250 | 420 | 2.000 |
| 025 | 0.025 | 230 | 0.300 | 522 | 2.250 |
| 030 | 0.030 | 235 | 0.350 | 425 | 2.500 |
| 035 | 0.035 | 240 | 0.400 | 527 | 2.750 |
| 040 | 0.040 | 245 | 0.450 | 430 | 3.000 |
| 045 | 0.045 | 250 | 0.500 | 435 | 3.500 |
| 050 | 0.050 | 255 | 0.550 | 440 | 4.000 |
| 055 | 0.055 | 260 | 0.600 | 445 | 4.500 |
| 060 | 0.060 | 265 | 0.650 | 450 | 5.000 |
| 065 | 0.065 | 270 | 0.700 | 455 | 5.500 |
| 070 | 0.070 | 275 | 0.750 | 460 | 6.000 |
| 075 | 0.075 | 280 | 0.800 | 465 | 6.500 |
| 080 | 0.080 | 285 | 0.850 | 470 | 7.000 |
| 085 | 0.085 | 290 | 0.900 | 475 | 7.500 |
| 090 | 0.090 | 295 | 0.950 | 480 | 8.000 |
| 090 | 0.095 | 410 | 1.000 | 485 | 8.500 |
| 210 | 0.100 | 512 | 1.250 | 490 | 9.000 |
| 215 | 0.150 | 415 | 1.500 | 495 | 9.500 |
| 220 | 0.200 | 517 | 1.750 | 610 | 10.000 |

- Notes:
- One actuator is located in the center of each multi-pole breaker.
 - One Auxiliary Switch is supplied per breaker. Auxiliary Switch option limited to Series Trip & Switch Only circuits, and is not available in single pole illuminated breakers, or with Back Connected Screw or Push-in Stud terminals.
 - Mates with AMP .058" diameter pin receptacles: 60983-1 (gold plated) & 60983-1 (tin plated).
 - For neon bulb applications at 120VAC @ 47K, 1/4 WATT and for 250VAC applications @ 150K, 1/4 WATT, external resistors must be supplied by customer.
 - For LED (DC or rectified AC) applications, LED is mounted in the center of the rocker actuator with electrical characteristics as follows: 100 millicandela at 20mA; Maximum power dissipation = 75mW at 25°C; Maximum forward current = 25mA; Typical forward voltage = 2.1V at 20mA; Typical reverse current = 100uA at 3V. Customer supplies the proper external resistor limiting current to these values.
 - On Visi-Rocker breakers, Visi portion of rocker cannot be the same color as the bezel.
 - Rocker color for LED's and green neon lamp must be clear, smoke gray, white translucent or match color of LED or neon lamp.
 - Other colors available. Consult factory.
 - TUV Certified to 25 amps. UL Recognized, CSA Accepted and UL489A Listed to 30 amps. Screw Terminals recommended above 20 amps.
 - UL489A Listed must have ON-OFF or Dual legends. TUV Certified approvals must have I - O or Dual legends.
 - Terminal code A available with circuit codes A & B only.
 - Printed circuit board available with UL recognized approval only.
 - Auxiliary switch (flat Q.C.) available with UL recognized approvals only.

7 TERMINAL⁹

| | |
|-------------------------------------|---|
| 1 Push-On 0.250 Tab (Q.C.) | A¹¹ Push-In Stud |
| 2 Screw 8-32 w/upturned lugs | P¹² Printed Circuit Board |
| 3 Screw 8-32 (Bus Type) | |

8 ILLUMINATION
Non-illuminated
Neon⁴
 without resistor, 120VAC/250VAC
LED^{7,8}
 without resistor
 with resistor, 4-8 VDC
 with resistor, 9-16 VDC

| | |
|---------------------|-------------------------|
| A Neon | Green Glow ⁸ |
| B Red | Green |
| C Green | Amber |
| D Amber | White |
| E Smoke Gray | White |
| F White | Black |

9 ACTUATOR & LEGEND COLOR

Solid Color

| Actuator | Legend |
|----------------|--------|
| 1 White | Black |
| 2 Black | White |
| 3 Red | White |
| 4 Green | White |
| 5 Blue | White |
| 6 Yellow Black | |
| 7 Gray Black | |
| 8 Orange Black | |

Visi-Rocker⁶
 Visi & Legend (remainder of rocker same color as bezel)

| Actuator | Legend |
|----------|--------|
| 1 White | White |
| 2 Black | White |
| 3 Red | White |
| 4 Green | White |
| 5 Blue | White |
| 6 Yellow | White |
| 7 Gray | White |
| 8 Orange | White |

Illuminated⁷

| Actuator | Legend |
|--------------------------|--------|
| A Clear | White |
| B Red Transparent | White |
| C Green Transparent | White |
| D Amber Transparent | White |
| E Smoke Gray Transparent | White |
| F White Translucent | Black |

10 LEGEND¹⁰

| |
|--|
| 1 No Legend (Single Color or Illuminated Rocker Options Only) |
| 2 ON - OFF Vertical |
| 3 ON - OFF Horizontal |
| 4 I - O Vertical |
| 5 I - O Horizontal |
| 6 Dual Vertical |
| 7 Dual Horizontal |

11 BEZEL COLOR / STYLE⁸

| Color | without Rockerguard | with Rockerguard |
|-------|---------------------|------------------|
| White | A | 1 |
| Black | B | 2 |
| Gray | G | 7 |

12 AGENCY APPROVAL⁹

| |
|--|
| J UL489A Listed & TUV Certified |
| M UL Recognized & CSA Accepted |
| N TUV Certified, UL Recognized & CSA Accepted |
| T UL489A Listed |

SERIES TRIP

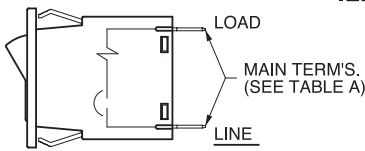

SERIES TRIP W/ ILLUMINATED ROCKER

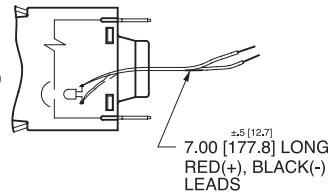

SWITCH ONLY

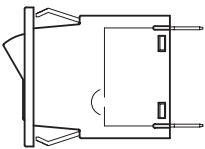

SWITCH ONLY W/ ILLUMINATED ROCKER

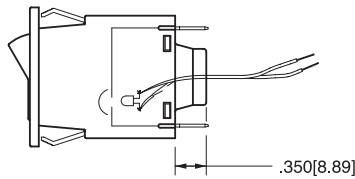

SERIES TRIP W/ AUXILIARY SWITCH

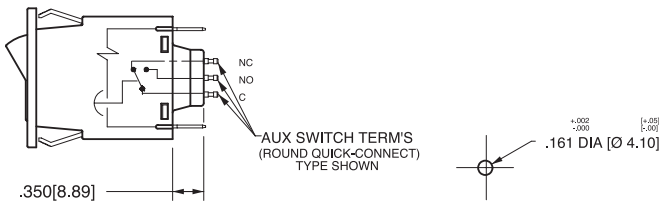

PUSH-IN STUD MATING HOLE

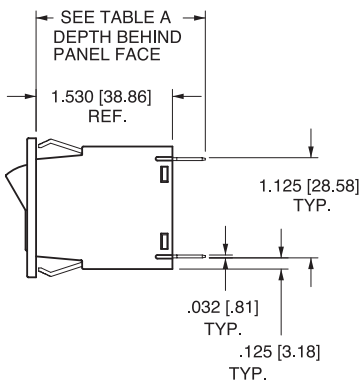

TERMINAL DIMENSIONAL DETAIL

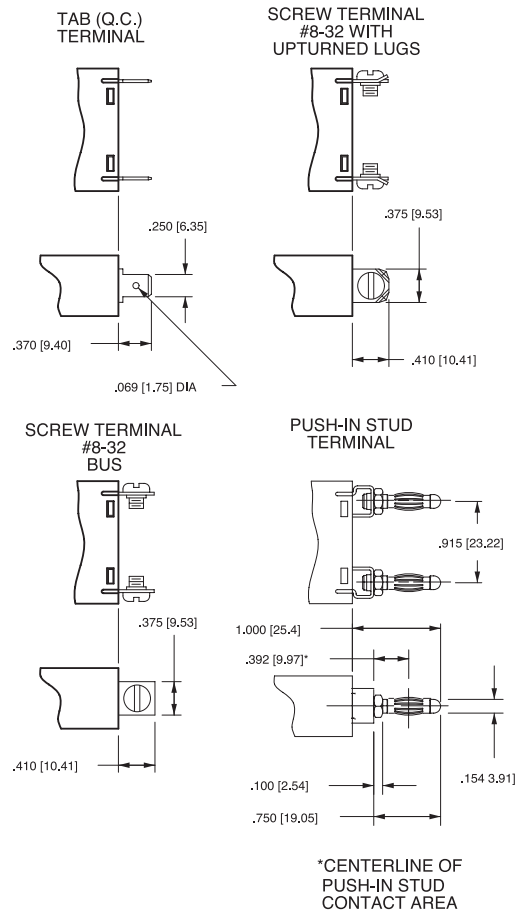

* CENTERLINE OF PUSH-IN STUD CONTACT AREA

AUXILIARY SWITCH TERMINALS

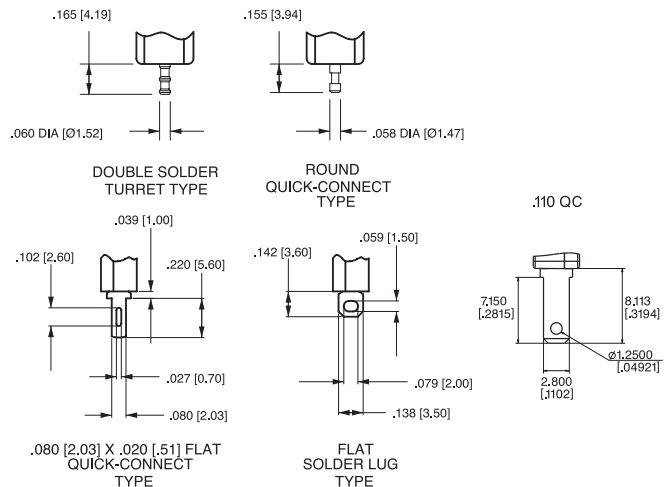

* AVAILABLE THROUGH SPECIAL CATALOG PART NUMBER

| TABLE - A | | |
|----------------------|---------------------------|-------------------------|
| TERMINAL DESCRIPTION | | DEPTH BEHIND PANEL FACE |
| MAIN | TAB (Q.C.) | 1.900 [48.26] |
| | SCREW (#8-32)** | 1.940 [49.28] |
| | PUSH-IN STUD | 2.530 [64.26] |
| *AUX. SWITCH | DOUBLE SOLDER TURRET TYPE | 2.045 [51.94] |
| | ROUND Q.C. TYPE | 2.035 [51.69] |
| | FLAT QUICK CONNECT | 2.139 [54.33] |
| | FLAT SOLDER LUG | 2.022 [51.36] |

* AUX. SWITCH IS NOT AVAILABLE ON SINGLE POLE ILLUMINATED UNITS. WHEN CALLED FOR ON MULTI-POLE UNITS, ONLY ONE AUX. SWITCH IS NORMALLY SUPPLIED, MOUNTED AS SHOWN ON CLA-8003.

** RECOMMENDED TIGHTENING TORQUE 12-15 IN LBS [1.4-2.7 NM]

Notes:

- 1 All dimensions are in inches [millimeters].
- 2 Tolerance ±.020 [.51] unless otherwise specified.
- 3 Schematic shown represents current trip circuit.

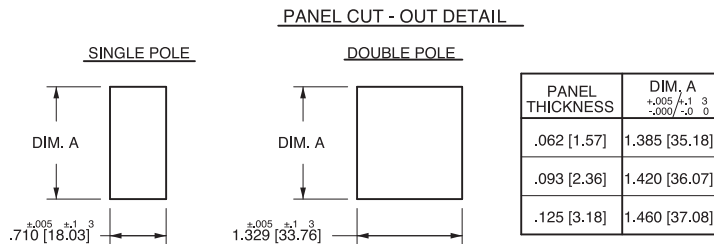
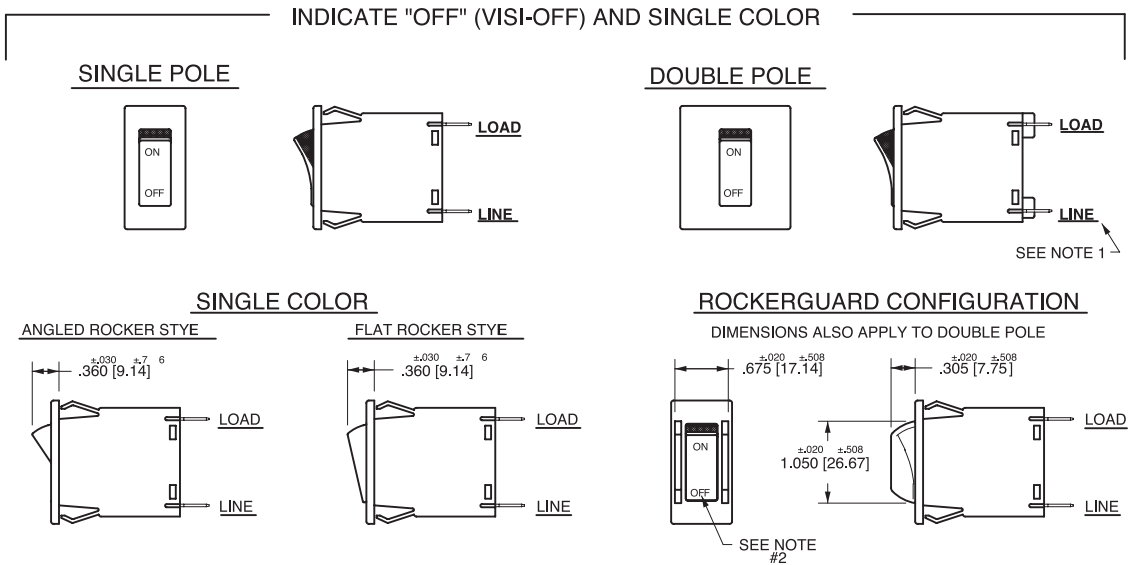
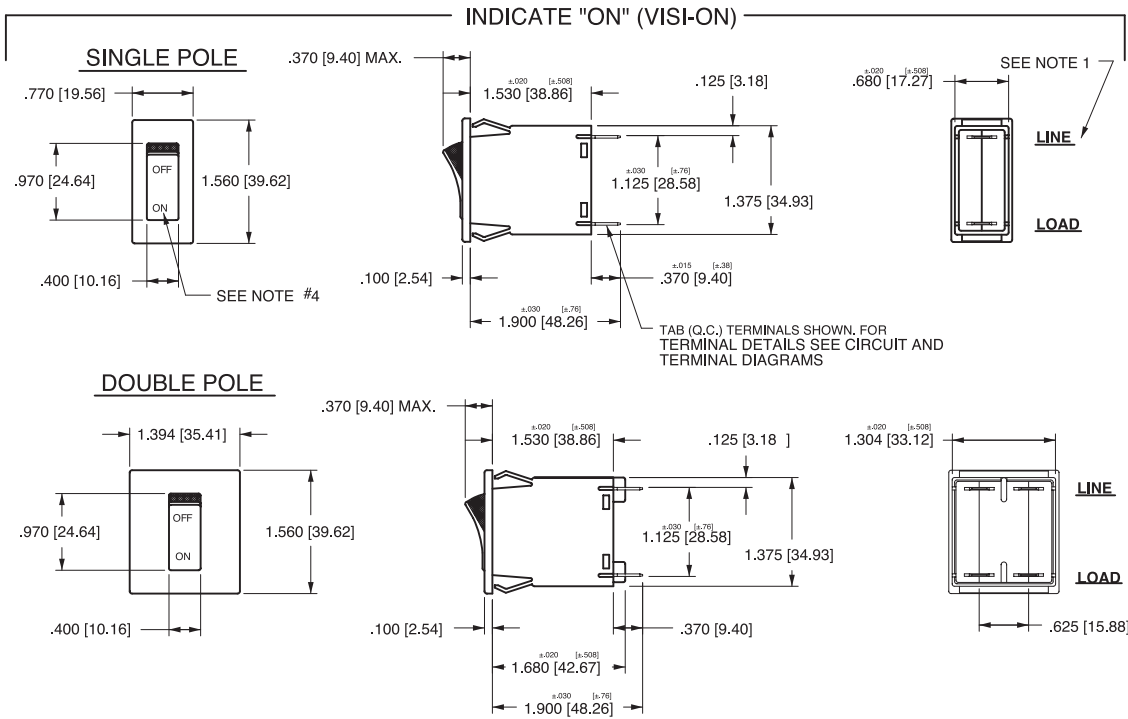

- Notes:
- 1 Dimensions apply to all variations shown. Notice that circuit breaker line & load terminal orientation on indicate OFF is opposite of indicate ON.
 - 2 I-O, ON-OFF or dual legends available for vertical or horizontal mounting. For pole orientation with horizontal legend, rotate front view clockwise 90°.
 - 3 All dimensions are in inches [millimeters].
 - 4 Tolerance ± 0.20 [5.1] unless otherwise specified.

ONE POLE

SINGLE POLE / ROCKER BREAKERS SHOWN WITH DOUBLE SOLDER TURRET AND ROUND QC AUX. SWITCH TERMINALS

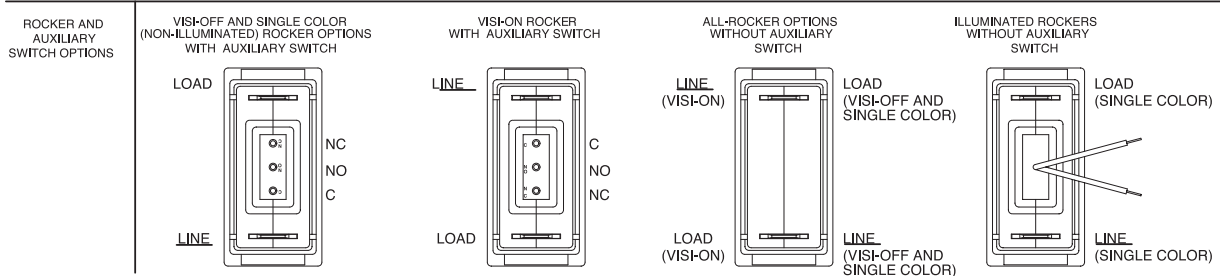

SINGLE POLE / ROCKER BREAKERS SHOWN WITH FLAT QC AND FLAT SOLDER LUG AUX. SWITCH TERMINALS

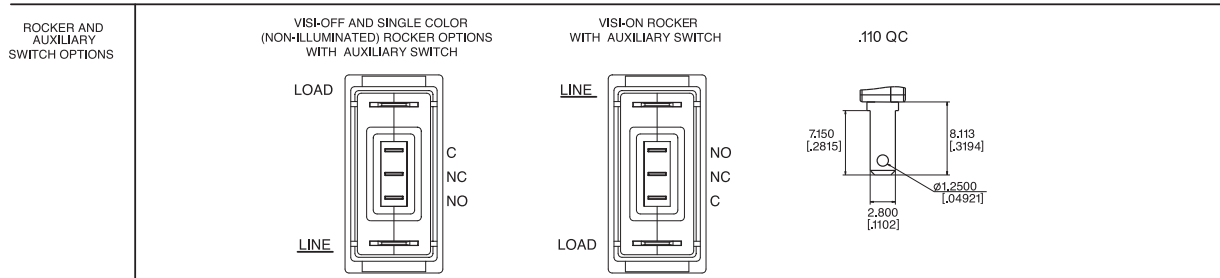

TWO POLE

DOUBLE POLE / ROCKER BREAKERS SHOWN WITH DOUBLE SOLDER TURRET AND ROUND QC AUX. SWITCH TERMINALS

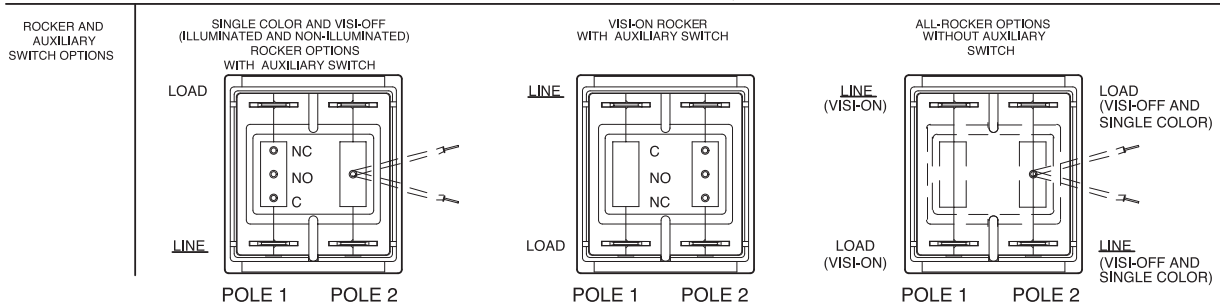

DOUBLE POLE / ROCKER BREAKERS SHOWN WITH FLAT QC AND FLAT SOLDER LUG AUX. SWITCH TERMINALS

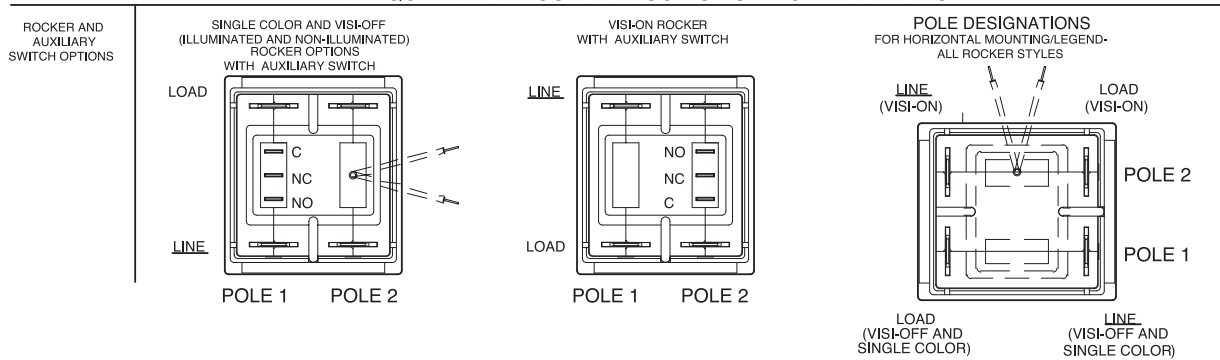

| M-SERIES TIME DELAY VALUES | | | | | | | | | | |
|----------------------------|--------------------------|-------------|-------------|-------------|-------------|-------------|-------------|-------------|-------------|-------------|
| TRIP TIME SECONDS | PERCENT OF RATED CURRENT | | | | | | | | | |
| | Delay | 100% | 135% | 150% | 200% | 400% | 600% | 800% | 1000% | 1200% |
| | 10, 20, 30 | No Trip | May Trip | .100 Max | .100 Max | .100 Max | .100 Max | .100 Max | .100 Max | .100 Max |
| 12, 22, 32, 62, 72, 92 | No Trip | .300 - 7.00 | .200 - 5.00 | .100 - 2.00 | .030 - .500 | .008 - .300 | .006 - .150 | .005 - .100 | .005 - .100 | .005 - .100 |
| 14, 24, 34, 64, 74, 94 | No Trip | 3.00 - 70.0 | 2.00 - 40.0 | 1.00 - 15.0 | .100 - 4.00 | .008 - 2.00 | .006 - .800 | .005 - .350 | .005 - .160 | .005 - .160 |

- Notes:
- 1 Delay Curves 12,14, 22, 24, 32, 34, 62, 64, 72, 74, 92, 94: Breakers to hold 100% and must trip at 135% of rated current and greater within the time limit shown in this curve.
 - 2 Delay Curves 10, 20, 30: Breakers to hold 100% and must trip at 150% of rated current and greater within the time limit shown in this curve.
 - 3 All Curves: Curve data shown represents breaker response at ambient temperature of 77°F (25°C) with no preloading. Breakers are mounted in standard wall-mount position.
 - 4 The minimum inrush pulse tolerance handling capability is 12 times the rated current on standard delays and 18 times the rated current on high inrush delays. These values are based on a 60 Hz 1/2 cycle, 8.33 ms pulse. High inrush delays should be specified for applications with high initial surge currents of short duration, such as switching power supplies, highly capacitive loads and transformer loads.

Dual Rated AC/DC

Instantaneous

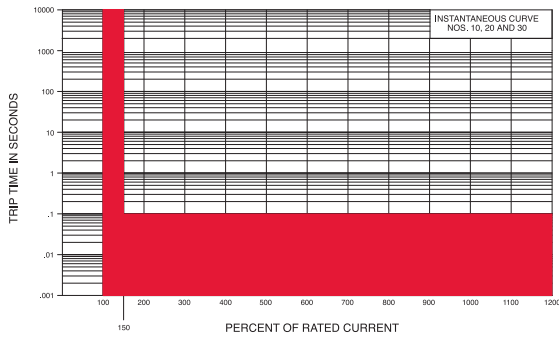

Short

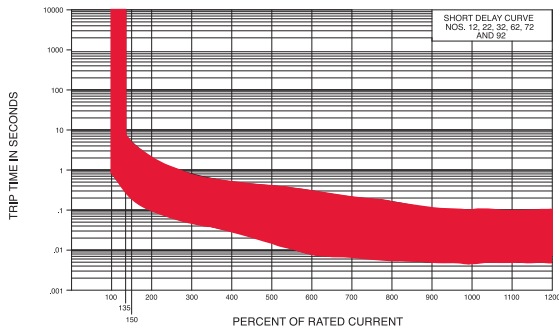

Short D2

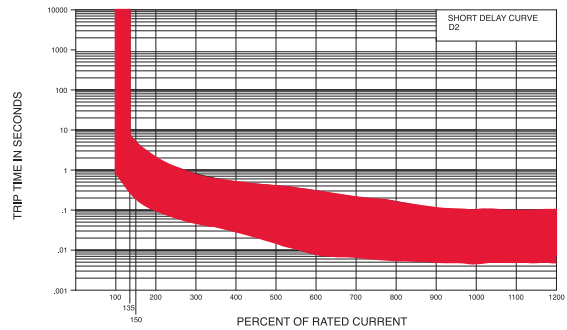

Medium

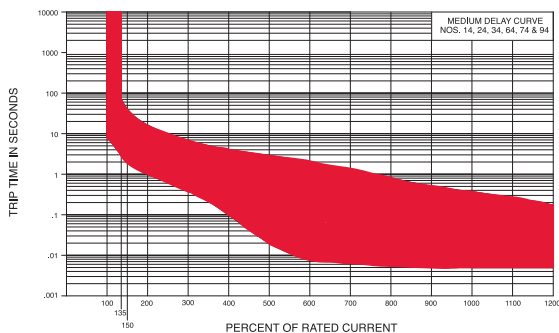

Medium D4

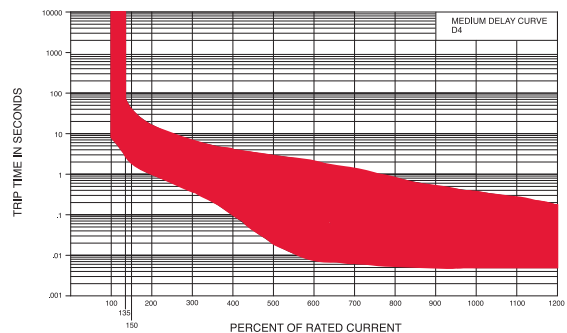

* Intentionally left blank

Worldwide Headquarters

Carling Technologies, Inc.
60 Johnson Avenue • Plainville, CT 06062
Phone: (860) 793-9281 • Fax: (860) 793-9231
Email: sales@carlingtech.com • www.carlingtech.com

East Region Sales Office, CT • ersm@carlingtech.com
Midwest Region Sales Office, IL • mrsm@carlingtech.com
West Region Sales Office, CA • wrsm@carlingtech.com

Asia-Pacific Headquarters

Carling Technologies, Asia-Pacific Ltd.,
Kowloon, Hong Kong
Int + 852-2737-2277 • Fax: Int + 852-2736-9332
Email: sales@carlingtech.com.hk

Shenzhen, China • shenzhen@carlingtech.com
Shanghai, China • shanghai@carlingtech.com
Pune, India • india@carlingtech.com
Kaohsiung, Taiwan • taiwan@carlingtech.com
Yokohama, Japan • japan@carlingtech.com

Europe / Middle East / Africa Headquarters

Carling Technologies LTD
4 Airport Business Park, Exeter Airport,
Clyst Honiton, Exeter, Devon, EX5 2UL, UK
Int + 44 1392-364422 • Fax: Int + 44 1392-364477
Email: ltd.sales@carlingtech.com

GmbH, Germany • gmbh@carlingtech.com
SAS, France • sas@carlingtech.com

REV_CB_M_05_2014



Carling Technologies™

Innovative Designs. Powerful Solutions.