

Part Number : ALC10G103KP200

Customer :

Customer p/n :

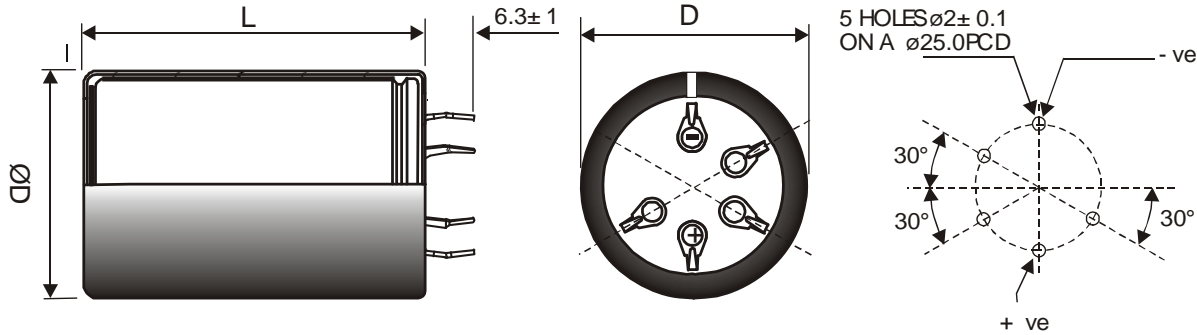

Diameter (mm) 50 -0/+1  
 Length (L or L2) (mm) 105 +/-2  
 Terminals 5 Pin Snap-in  
 Other Dimensions

Capacitance: 10000 uF  
 Lower Cap Tolerance: 20 %  
 Upper Cap Tolerance: 20 %  
 Working Voltage: 200 V DC  
 Surge Test Voltage: 230 V DC

ESR 28 m'Ohms MAX @ 100 HZ,20°C  
 IMPEDANCE 25 m'Ohms MAX @ 10 KHZ,20°C

DC LEAKAGE 6.00 mA max @ Test Volts  
 Test Voltage 200.0V DC

Rated ripple current 9.11 A rms at 100 Hz and 85 °C  
 Temperature range -40 °C to 85 °C

Life (Ur, Ir, +85°C) = 18khrs

Approved \_\_\_\_\_ Date \_\_\_\_\_

Form : FM003.DES Iss : 3 Date :30/06/1