

Part Number : PEH532VDG3680M2

Customer :

Customer p/n :

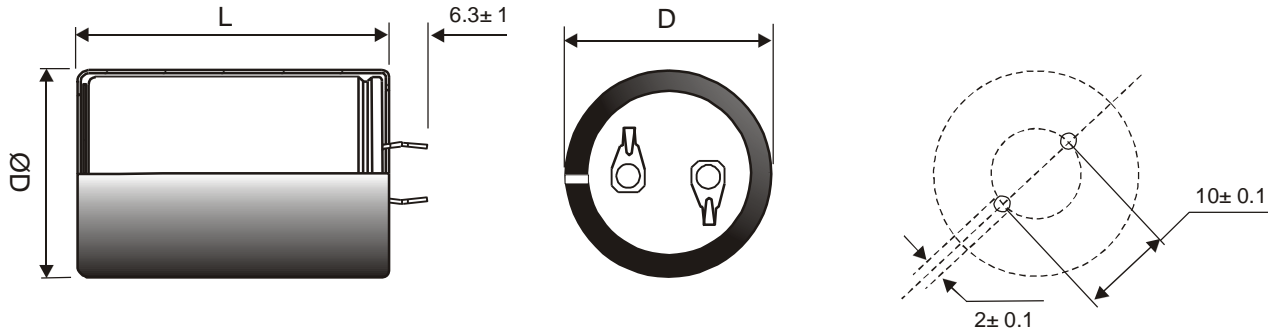

Diameter (mm) 35.5 +/-0.5
 Length (L or L2) (mm) 51 +/-1
 Terminals 2 Pin Snap-in
 Other Dimensions

Capacitance: 680 uF
 Lower Cap Tolerance: 20 %
 Upper Cap Tolerance: 20 %
 Working Voltage: 400 V DC
 Surge Test Voltage: 440 V DC

ESR 190 m'Ohms MAX @ 100 HZ,20°C
 IMPEDANCE 110 m'Ohms MAX @ 10 KHZ,20°C
 0
 DC LEAKAGE 0.82 mA max @ Test Volts
 Test Voltage 400.0V DC

Rated ripple current 2.3 A rms at 100 Hz and 105 °C
 Temperature range -40 °C to 105 °C

Expected life = 1500h (Ur, Ir, 105°C, 100Hz) considering EOL at 2x Initial Typical ESR

Approved _____ Date _____

Form : FM003.DES Iss : 3 Date :30/06/1