

# Flush-type connector - SACC-DSI-M8MS-8CON-M8-L180 - 1424238

Please be informed that the data shown in this PDF Document is generated from our Online Catalog. Please find the complete data in the user's documentation. Our General Terms of Use for Downloads are valid (<http://phoenixcontact.com/download>)



Sensor/actuator flush-type connector, plug, 8-pos., M8, rear/screw mounting with M8 fastening thread, with straight solder connection



## Key commercial data

Packing unit	20 pc
GTIN	 4 046356 712507
Weight per Piece (excluding packing)	5.83 g
Custom tariff number	85366990
Country of origin	Germany
Product key	ABQBAA
Note	Made to Order (non-returnable)

## Technical data

### Ambient conditions

Degree of protection	IP67
----------------------	------

### General

Rated current at 40°C	1.5 A
Rated voltage	30 V
Number of positions	8
Contact resistance	≤ 3 mΩ
Insulation resistance	≥ 100 MΩ
Coding	A - standard
Standards/regulations	M8 connector IEC 61076-2-104
Status display	No
Surge voltage category	II
Pollution degree	3
Connection method	Solder pins
Mounting type	Rear mounting M8 x 1 With flat nut

# Flush-type connector - SACC-DSI-M8MS-8CON-M8-L180 - 1424238

## Technical data

### Material

Inflammability class according to UL 94	HB
Contact material	CuSn
Contact surface material	Au
Contact carrier material	PUR
Material, knurls	Zinc die-cast, nickel-plated

## Classifications

### eCl@ss

eCl@ss 4.0	27250313
eCl@ss 4.1	27250313
eCl@ss 5.0	27260701
eCl@ss 5.1	27143423
eCl@ss 6.0	27143423
eCl@ss 7.0	27449001
eCl@ss 8.0	27440103

### ETIM

ETIM 3.0	EC002061
ETIM 4.0	EC002635
ETIM 5.0	EC002061

### UNSPSC

UNSPSC 6.01	31251501
UNSPSC 7.0901	31251501
UNSPSC 11	31251501
UNSPSC 12.01	31251501
UNSPSC 13.2	31251501

## Approvals

### Approvals

---

#### Approvals

EAC

---

Ex Approvals

---

Approvals submitted

# Flush-type connector - SACC-DSI-M8MS-8CON-M8-L180 - 1424238

## Approvals

### Approval details

EAC

## Drawings

Dimensioned drawing

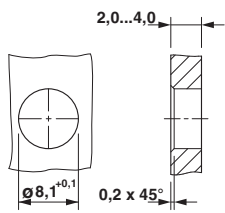

Schematic diagram

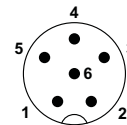

Pin assignment M8 plug, 6-pos., view male side

Housing cutout for M8 flush-type connector, connector, one-section

Drilling diagram

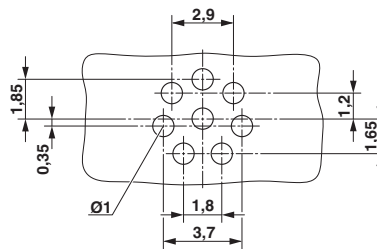

Plug drilling diagram