

# EAO – Your Expert Partner for Human Machine Interfaces

## 45-2234.31H0.000 - Illuminated pushbutton actuator, Maintain

### 45-2234.31H0.000 - Illuminated pushbutton actuator, Maintain



*Attention: The preview is based on a sample product. This can differ from your current configuration.*

#### Mounting

Design	raised
Mounting cut-out	∅ 22.5 mm

#### Front

Front shape	round
Front dimension	∅ 29.45 mm
Front ring material	Metal mat
Front ring colour	sandgrey

#### Other Attributes

Weight	0.020 kg
--------	----------

#### Operating-/Indication part

Lens optics	opaque
Lens material	Plastic
Lens colour	green transparent
Lens profile	flat / level with front ring

#### IP-Rating

Front protection	IP66, IP67, IP69K
------------------	-------------------

#### Actuator

Switching action	Maintained
Housing material	Plastic

#### Switching element

6

#### Function

Illuminated pushbutton

# EAO – Your Expert Partner for Human Machine Interfaces

45-2234.31H0.000 - Illuminated pushbutton actuator, Maintain

## Dimensions

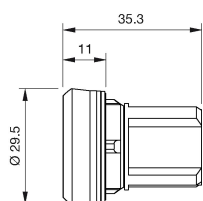

## Mounting cut-outs

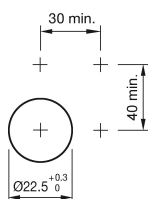

## Wiring diagram



## Additional information

Push to unlatch

## Legend

Switching action: C = Maintained