

EAO – Your Expert Partner for Human Machine Interfaces

704.066.2 - Emergency-stop switch actuator, foolproof EN IEC 60947-5-5

704.066.2 - Emergency-stop switch actuator, foolproof EN IEC 60947-5-5

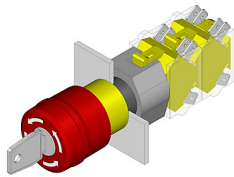

Attention: The preview is based on a sample product. This can differ from your current configuration.

Mounting

Mounting cut-out Ø 22.5 mm
Design raised

Front

Front shape round
Front dimension Ø 37 mm

Other Attributes

Marking Arrows
Weight 0.300 kg

Operating-/Indication part

Lens material Plastic
Lens optics opaque
Lens profile Mushroom
Lens colour red

IP-Rating

Front protection IP 65

Actuator

Switching action Maintained

Function

Emergency stop switch

EAO – Your Expert Partner for Human Machine Interfaces

704.066.2 - Emergency-stop switch actuator, foolproof EN IEC 60947-5-5

Dimensions

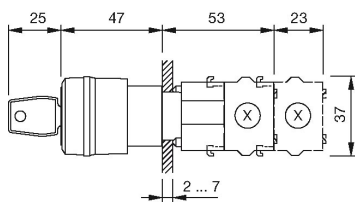

X = Screw terminal

Mounting cut-outs

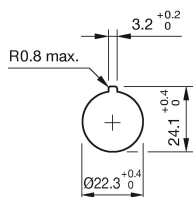

Wiring diagram



Additional information

Shaft yellow
Key to unlock anti-clockwise
Lock type Euro-Locks 9500
Two keys are supplied with each key lock switch
Optional lock numbers on request
Max. 3 slow-make elements can be clipped on
Application as per DIN EN ISO 13850 and EN 60204-1

Legend

Switching action: C = Maintained