

SIZE	Part Num.	Threading	Jaxkscrew colour
25	86303639B	UNC 4.40	black

NOTES:

Material: Nylon (UL94V-2)
 Cable strain relief: Cable clamp with Self-taping screws
 Temperature range: -35°C to 95°C
 Cable diameter: 4.0 to 11.0mm
 Jackscrew colour: black for 4.40 UNC)
 grey for M3.0
 Packaging: Box of 100 individual sets
 Cable clamp screwing force (max): 70 Ncm
 Jack screws screwing force (max): 50 Ncm

See table for colour coding

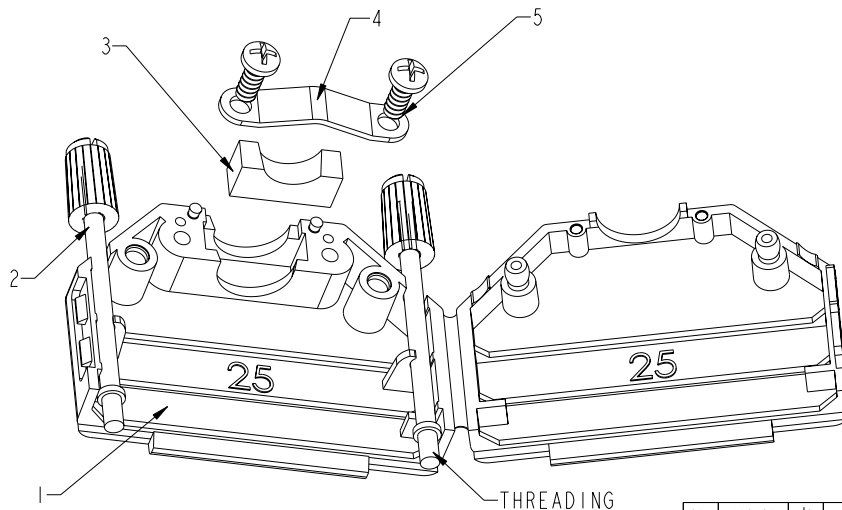
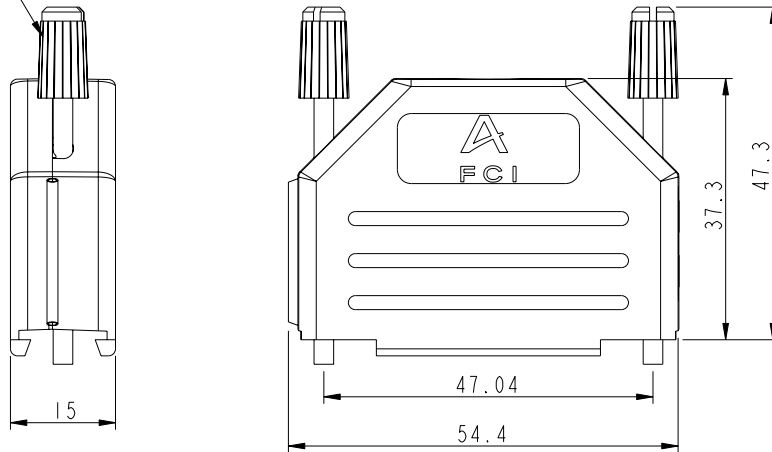

DESIGNATION	REP	Qte
BACKSHELL	1	1
JACKSCREWS	2	2
GROMMET	3	1
CABLECLAMP	4	1
SCREWS POZIDRIVE	5	2

www.fciconnect.com		surface ISO 1302	tolerance std ISO 406 ISO 1101	projection mm
		TOLERANCES UNLESS OTHERWISE SPECIFIED		mm
Dr	BART.S	2004.03.22	ANGULAR	0.X ±0.3
Eng	LENOIR.M	2004.03.22	LINEAR	0.XX ±0.1
Chr	LEGARE.P	2004.03.22	0° ±2°	0.XXX ±0.05
Appr	-	2004.03.22	Product family	D-SUB
		size		A3
		ECN		LS06-0084
		Spec ref		-
FCJ		title		D-SUB PLASTIC SHELLS
				STRAIGHT SNAP-TOGETHER
		catalog no		see tables
		dwg no		10039955C
		Rev.		B
		CUSTOMER		sheet 1 of 3

rev	ecn no	dr	date
A	LS4045	SBA	2004/04/27
B	LS06-0084	LGO	2006/06/25
-	-	-	-
-	-	-	-
-	-	-	-
-	-	-	-



Copyright FCI.

REV F - 2006-04-17

SIZE	Part Num.	Threading	Jackscrew colour
9	86303637B	UNC 4.40	Black
	86553329B	M3	Grey

SIZE	Part Num.	Threading	Jackscrew colour
15	86303638B	UNC 4.40	Black
	86553330B	M3	Grey

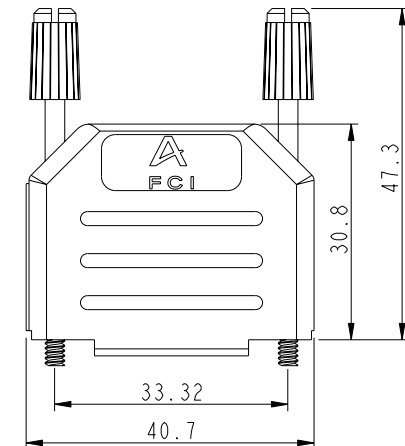
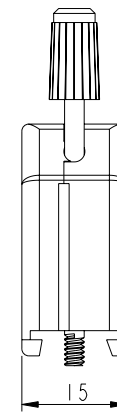
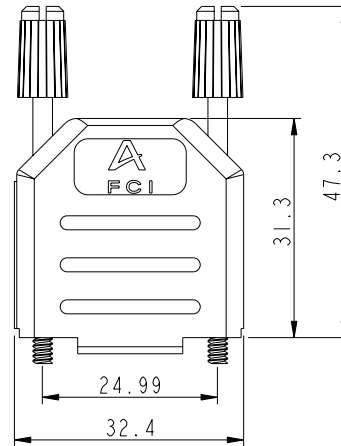
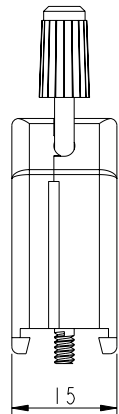

SIZE	Part Num.	Threading	Jackscrew colour
37	86303640B	UNC 4.40	black

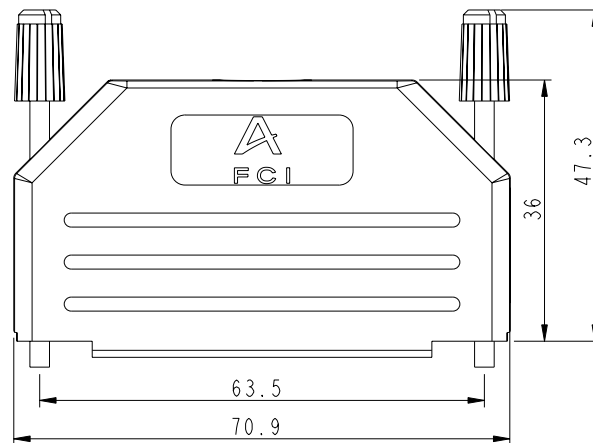
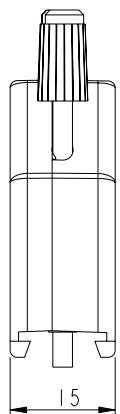

www.fciconnect.com		surface ISO 1302	-	tolerance std ISO 406 ISO 1101	projection ISO 1101	mm
		TOLERANCES UNLESS OTHERWISE SPECIFIED				
Dr	BART.S	2004.03.22	ANGULAR	0.X	±0.3	size A3
Eng	LENOIR.M	2004.03.22	LINEAR	0.XX	±0.1	Scale 1:1
Chr	LEGARE.P	2004.03.22	0° ±2°	0.XXX	±0.05	ECN LS06-0084
Appr	-	2004.03.22	Product family	D-SUB		Spec ref -
		Title D-SUB PLASTIC SHELLS			dwg no 10039955C	Rev. B
		STRAIGHT SNAP-TOGETHER			see tables	CUSTOMER
		catalog no			sheet 2 of 3	

Copyright FCI

REV F - 2006-04-17

CABLING INSTRUCTIONS

1- Choose grommet position

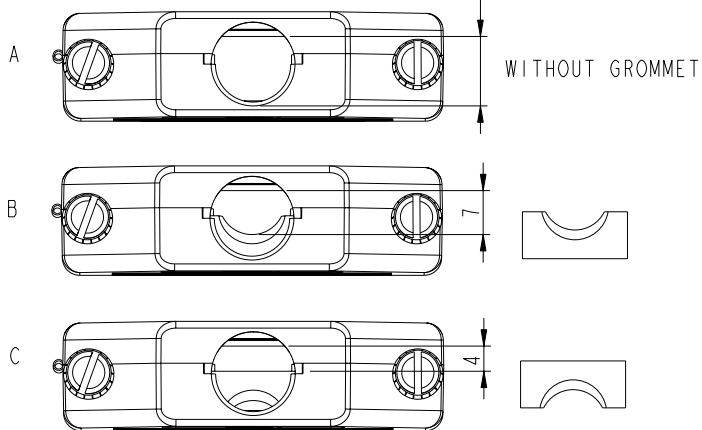

2- Mount connector and cable inside

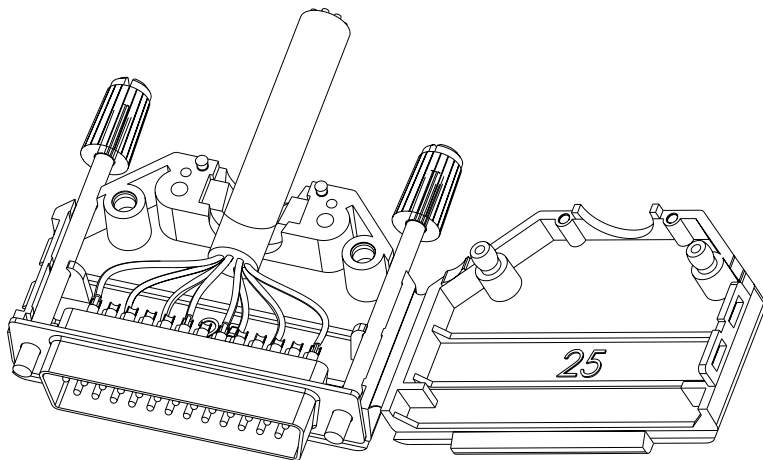

3- Mount cableclamp and screws

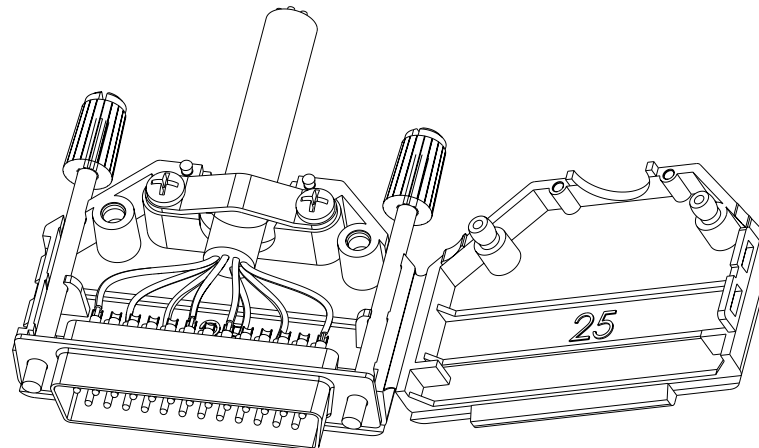

4- Close the backshell and click together

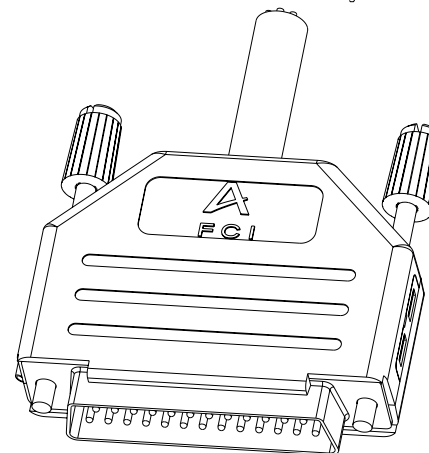

Copyright FCI.

www.fciconnect.com		surface - ISO 1302	tolerance std ISO 406 ISO 1101	projection mm	
		TOLERANCES UNLESS OTHERWISE SPECIFIED			
Dr	BART.S	2004.03.22	ANGULAR	0.X ±0.3	size A3
Eng	LENOIR.M	2004.03.22	LINEAR	0.XX ±0.1	Scale 1:1
Chr	LEGARE.P	2004.03.22	0° ±2°	0.XXX ±0.05	ECN LS06-0084
Appr	-	2004.03.22	Product family	D-SUB	Spec ref -
		title D-SUB PLASTIC SHELLS		dwg no 10039955C	Rev. B
		STRAIGHT SNAP-TOGETHER			
		catalog no	see tables	CUSTOMER	sheet 3 of 3

REV F - 2006-04-17