

RIGHT ANGLE MALE MMS - 200 MM

R285.001.021

2/50 S-BR CABLE

Series : **CORD-SPECIF**

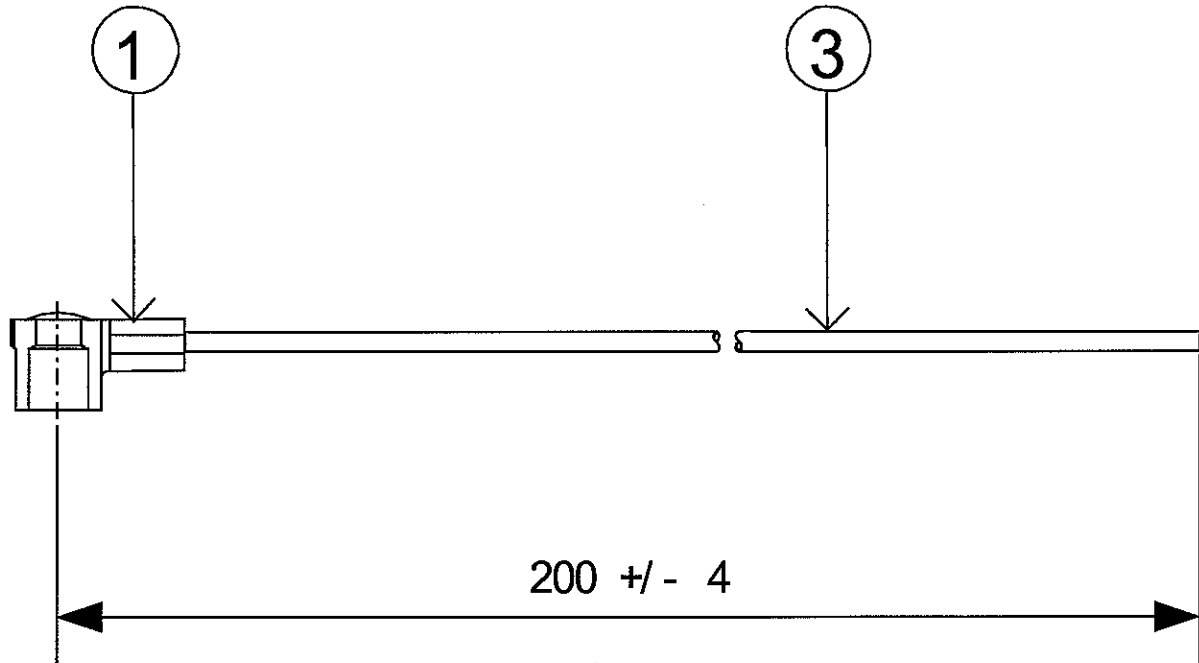

All dimensions are in mm.

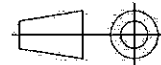

- * 1 * Connector A : **R209.353.000**
 - * 2 * Connector B : **-**
 - * 3 * Cable : **C291.145.007**
- Type : **CAB HF 2/50 RG 178 BROWN**

ELECTRICAL CHARACTERISTICS

SPECIFICATION

Impedance		50 Ω
Frequency		0-6 GHz
Operating temperature		-40/+90 ° C
VSWR	NA +	0.000 x F(GHz) Maxi
Insertion loss		NA √F(GHz) dB Maxi
Voltage rating		50 Veff Maxi
Dielectric withstanding voltage		250 Veff mini
Insulation resistance		500 MΩ mini

Weight	1.900 g
Cable	20 N mini
Others :	-

