

## Base strip - DFK-MC 1,5/ 2-GF-3,81 - 1829345

Please be informed that the data shown in this PDF Document is generated from our Online Catalog. Please find the complete data in the user's documentation. Our General Terms of Use for Downloads are valid (<http://phoenixcontact.com/download>)



Header, Nominal current: 8 A, Rated voltage (III/2): 160 V, Number of positions: 2, Pitch: 3.81 mm, Connection method: Solder/Slip-on connection, Color: green, Contact surface: Tin, Mounting: Direct mounting

The figure shows a 10-position version of the product

### Why buy this product

- Free choice – permanent solder connection or standardized slip-on connection
- Cable connection on the inside of the device enables flexible positioning of the panel feed-through



### Key Commercial Data

|                                      |   |
|--------------------------------------|---|
| Packing unit                         | 50 STK  |
| Minimum order quantity               | 50 STK  |
| GTIN                                 | <br>4 017918 051020 |
| GTIN                                 | 4017918051020   |
| Weight per Piece (excluding packing) | 2.490 g   |
| Custom tariff number                 | 85366990  |
| Country of origin                    | Poland  |

### Technical data

#### Dimensions

|                                  |              |
|----------------------------------|--------------|
| Length                           | 16.2 mm      |
| Height                           | 20.4 mm      |
| Width                            | 22.01 mm     |
| Pitch                            | 3.81 mm      |
| Dimension a                      | 3.81 mm      |
| Dimensions of slip-on connection | 2,8 x 0,8 mm |

#### General

|                   |                  |
|-------------------|------------------|
| Range of articles | DFK-MC 1,5/..-GF |
|-------------------|------------------|

# Base strip - DFK-MC 1,5/ 2-GF-3,81 - 1829345

## Technical data

### General

|  |                           |
|--|---------------------------|
| Type of contact                        | Male connector            |
| Number of positions                    | 2                         |
| Connection method                      | Solder/Slip-on connection |
| Insulating material group              | I                         |
| Rated surge voltage (III/3)            | 2.5 kV                    |
| Rated surge voltage (III/2)            | 2.5 kV                    |
| Rated surge voltage (II/2)             | 2.5 kV                    |
| Rated voltage (III/3)                  | 160 V                     |
| Rated voltage (III/2)                  | 160 V                     |
| Rated voltage (II/2)                   | 320 V                     |
| Connection in acc. with standard       | EN-VDE                    |
| Nominal current I <sub>N</sub>         | 8 A                       |
| Nominal cross section                  | 1.5 mm <sup>2</sup>       |
| Maximum load current                   | 8 A                       |
| Insulating material                    | PA                        |
| Flammability rating according to UL 94 | V0                        |

### Connection data

|                                       |                      |
|---------------------------------------|----------------------|
| Conductor cross section solid min.    | 0.14 mm <sup>2</sup> |
| Conductor cross section solid max.    | 1.5 mm <sup>2</sup>  |
| Conductor cross section flexible min. | 0.14 mm <sup>2</sup> |
| Conductor cross section flexible max. | 1.5 mm <sup>2</sup>  |
| Conductor cross section AWG min.      | 28                   |
| Conductor cross section AWG max.      | 16                   |

### Standards and Regulations

|  |        |
|--|--------|
| Connection in acc. with standard       | EN-VDE |
|  | CSA    |
| Flammability rating according to UL 94 | V0     |

### Environmental Product Compliance

|            |   |
|------------|---|
| China RoHS | Environmentally Friendly Use Period = 50  |
|            | For details about hazardous substances go to tab "Downloads", Category "Manufacturer's declaration" |

## Drawings

# Base strip - DFK-MC 1,5/ 2-GF-3,81 - 1829345

Drilling diagram

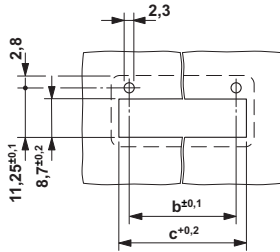

Diagram

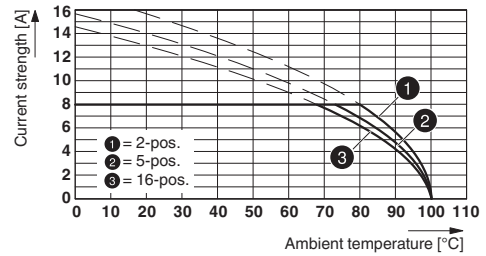

Dimension b: 6.19 mm + (no. of pos. x 3.81 mm)  
Dimension c: Dim. b + 4.7 mm

Type: MC 1,5/...-STF-3,81 with DFK-MC 1,5/...-GF-3,81 (with flat plug)

Diagram

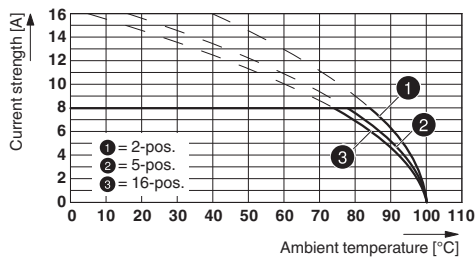

Dimensional drawing

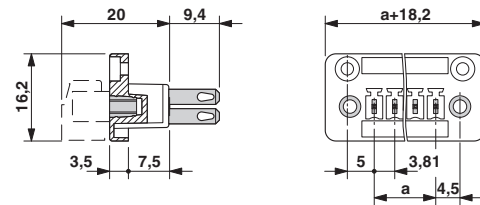

Type: MC 1,5/...-STF-3,81 with DFK-MC 1,5/...-GF-3,81 (with solder connection)

## Classifications

eCl@ss

|            |          |
|------------|----------|
| eCl@ss 4.0 | 272607xx |
| eCl@ss 4.1 | 27260701 |
| eCl@ss 5.0 | 27260701 |
| eCl@ss 5.1 | 27141190 |
| eCl@ss 6.0 | 27260704 |
| eCl@ss 7.0 | 27440402 |
| eCl@ss 8.0 | 27141134 |
| eCl@ss 9.0 | 27141134 |

ETIM

|          |          |
|----------|----------|
| ETIM 3.0 | EC001283 |
| ETIM 4.0 | EC001283 |
| ETIM 5.0 | EC001283 |
| ETIM 6.0 | EC001283 |

UNSPSC

|               |          |
|---------------|----------|
| UNSPSC 6.01   | 30211810 |
| UNSPSC 7.0901 | 39121409 |
| UNSPSC 11     | 39121409 |

# Base strip - DFK-MC 1,5/ 2-GF-3,81 - 1829345

## Classifications

### UNSPSC

|              |          |
|--------------|----------|
| UNSPSC 12.01 | 39121409 |
| UNSPSC 13.2  | 39121410 |

## Approvals

### Approvals

---

### Approvals

CSA / VDE Gutachten mit Fertigungsüberwachung / IECEE CB Scheme / CCA / cULus Recognized / EAC

---

### Ex Approvals

---

## Approval details

|                    |  |   |       |
|--------------------|--|---|-------|
| CSA                |  | <a href="http://www.csagroup.org/services/testing-and-certification/certified-product-listing/">http://www.csagroup.org/services/testing-and-certification/certified-product-listing/</a> | 13631 |
| Nominal current IN |  | 8 A   |       |
| Nominal voltage UN |  | 150 V   |       |

|   |  |   |          |
|---|--|---|----------|
| VDE Gutachten mit Fertigungsüberwachung |  | <a href="http://www.vde.com/en/Institute/OnlineService/VDE-approved-products/Pages/Online-Search.aspx">http://www.vde.com/en/Institute/OnlineService/VDE-approved-products/Pages/Online-Search.aspx</a> | 40011723 |
| mm <sup>2</sup> /AWG/kcmil              |  | 0.2-1.5   |          |
| Nominal current IN                      |  | 8 A   |          |
| Nominal voltage UN                      |  | 160 V   |          |

|                            |  |   |                |
|----------------------------|--|---|----------------|
| IECEE CB Scheme            |  | <a href="http://www.iecee.org/">http://www.iecee.org/</a> | DE1-56063-B1B2 |
| mm <sup>2</sup> /AWG/kcmil |  | 0.2-1.5   |                |
| Nominal current IN         |  | 8 A   |                |
| Nominal voltage UN         |  | 160 V   |                |

|                            |  |         |                |
|----------------------------|--|---------|----------------|
| CCA                        |  |         | CCA/ DE1 34219 |
| mm <sup>2</sup> /AWG/kcmil |  | 0.2-1.5 |                |

# Base strip - DFK-MC 1,5/ 2-GF-3,81 - 1829345

## Approvals

|                    |       |
|--------------------|-------|
| Nominal current IN | 8 A   |
| Nominal voltage UN | 160 V |

|  |       |       |
|--|-------|-------|
| cULus Recognized  <a href="http://database.ul.com/cgi-bin/XYV/template/LISEXT/1FRAME/index.htm">http://database.ul.com/cgi-bin/XYV/template/LISEXT/1FRAME/index.htm</a> E60425-20110128 |       |       |
|  | B     | D     |
| Nominal current IN   | 8 A   | 8 A   |
| Nominal voltage UN   | 300 V | 300 V |

|     |   |         |
|-----|---|---------|
| EAC |  | B.01742 |
|-----|---|---------|

## Accessories

### Accessories

#### Coding element

Coding profile - CP-MSTB - 1734634

Coding profile, is inserted into the slot on the plug or inverted header, red insulating material



## Labeled terminal marker

Marker card - SK 3,81/2,8:FORTL.ZAHLEN - 0804109



Marker card, Card, white, labeled, Horizontal: Consecutive numbers 1 - 10, 11 - 20, etc. up to 91 - (99)100, Mounting type: Adhesive, for terminal block width: 3.81 mm, Lettering field: 3.81 x 2.8 mm

## Mounting material

Screw set - DFK-MC SS - 0710015



Screw set, for securing the header to the housing wall, consists of M2 x 8 screw, spring washer and nut, 1 piece each

## Base strip - DFK-MC 1,5/ 2-GF-3,81 - 1829345

### Accessories

---

#### Screwdriver tools

Screwdriver - SZS 0,4X2,5 VDE - 1205037



Screwdriver, slot-headed, VDE insulated, size: 0.4 x 2.5 x 80 mm, 2-component grip, with non-slip grip

---

#### Additional products

Printed-circuit board connector - MCVR 1,5/ 2-STF-3,81 - 1828346



Plug component, Nominal current: 8 A, Rated voltage (III/2): 160 V, Number of positions: 2, Pitch: 3.81 mm, Connection method: Screw connection with tension sleeve, Color: green, Contact surface: Tin

---

Printed-circuit board connector - QC 0,5/ 2-STF-3,81 - 1897542

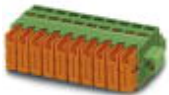

Plug component, Nominal current: 6 A, Rated voltage (III/2): 200 V, Number of positions: 2, Pitch: 3.81 mm, Connection method: Displacement connection, Color: green, Contact surface: Tin

---

Printed-circuit board connector - FK-MCP 1,5/ 2-STF-3,81 - 1851232

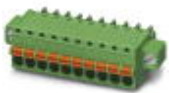

Plug component, Nominal current: 8 A, Rated voltage (III/2): 160 V, Number of positions: 2, Pitch: 3.81 mm, Connection method: Push-in spring connection, Color: green, Contact surface: Tin

---

Printed-circuit board connector - MCVW 1,5/ 2-STF-3,81 - 1828498



Plug component, Nominal current: 8 A, Rated voltage (III/2): 160 V, Number of positions: 2, Pitch: 3.81 mm, Connection method: Screw connection with tension sleeve, Color: green, Contact surface: Tin

---

## Base strip - DFK-MC 1,5/ 2-GF-3,81 - 1829345

### Accessories

Printed-circuit board connector - MC 1,5/ 2-STF-3,81 - 1827703



Plug component, Nominal current: 8 A, Rated voltage (III/2): 160 V, Number of positions: 2, Pitch: 3.81 mm, Connection method: Screw connection with tension sleeve, Color: green, Contact surface: Tin

Printed-circuit board connector - MCC 1/ 2-STZF-3,81 - 1852367



Plug component, Nominal current: 8 A, Rated voltage (III/2): 160 V, Number of positions: 2, Pitch: 3.81 mm, Connection method: Crimp connection, Color: green, Corresponding female crimp contacts with current [A] and conductor cross section range [mm<sup>2</sup>] data: 5A/MCC-MT 0,2-0,35 (1859988); 8A/MCC-MT 0,5-1,0 (1859991)

Printed-circuit board connector - FRONT-MC 1,5/ 2-STF-3,81 - 1850851



Plug component, Nominal current: 8 A, Rated voltage (III/2): 160 V, Number of positions: 2, Pitch: 3.81 mm, Connection method: Front screw connection, Color: green, Contact surface: Tin