

# Flush-type connector - SACC-CI-M12FS-12CON-L180 THR - 1441970

Please be informed that the data shown in this PDF Document is generated from our Online Catalog. Please find the complete data in the user's documentation. Our General Terms of Use for Downloads are valid (<http://phoenixcontact.com/download>)



Sensor/actuator flush-type socket, 12-pos., with straight THR solder connection

## Why buy this product

- Reduced mounting costs thanks to two-piece device connector
- Packaging available for automated pick and place assembly
- All common pin assignments and codings available
- Easy device integration thanks to mechanical port screw connections with threaded attachment, press-in contour or direct integration in the front plate
- Additional gasket for the device when not plugged in

## Key Commercial Data

|                                      |                                |
|--------------------------------------|--------------------------------|
| Packing unit                         | 60 STK                         |
| Minimum order quantity               | 60 STK                         |
| GTIN                                 |                                |
| GTIN                                 | 4046356533089                  |
| Weight per Piece (excluding packing) | 5.380 g                        |
| Custom tariff number                 | 85366990                       |
| Country of origin                    | Germany                        |
| Note                                 | Made to Order (non-returnable) |

## Technical data

### Ambient conditions

|                                 |   |
|---------------------------------|---|
| Ambient temperature (operation) | -25 °C ... 85 °C (Plug / socket)                |
|                                 | -40 °C ... 85 °C (without mechanical actuation) |
| Degree of protection            | IP67 (correctly plugged in and locked)          |

### General

|      |  |
|------|--|
| Note | The electrical and mechanical data specified assume that the connector pair is correctly locked and mounted. If the connector is unlocked and if |
|------|--|

# Flush-type connector - SACC-CI-M12FS-12CON-L180 THR - 1441970

## Technical data

### General

|                             |   |
|-----------------------------|---|
|                             | there is a danger of contamination, the connector must be sealed using a protective cap > IP54. Influences arising from litz wires, cables or PCB assembly must also be taken into consideration. |
| Rated current at 40°C       | 1.5 A   |
| Rated voltage               | 30 V  |
| Rated surge voltage         | 0.8 kV  |
| Number of positions         | 12  |
| Insulation resistance       | ≥ 100 MΩ  |
| Coding                      | A - standard  |
| Standards/regulations       | M12 connector IEC 61076-2-101   |
| Status display              | No  |
| Overvoltage category        | III   |
| Degree of pollution         | 3   |
| Connection method           | THR solder connection   |
| Insertion/withdrawal cycles | > 100   |
| Torque                      | 3 Nm ... 4 Nm (Installation-side)   |
| Mounting type               | PCB mounting  |
| Type of packaging           | Tray  |
| Delivery state              | with assembly pad   |

### Material

|  |            |
|--|------------|
| Flammability rating according to UL 94 | V0         |
| Contact material                       | CuZn       |
| Contact surface material               | Au         |
| Contact carrier material               | PPA        |
| Sealing material                       | FKM / EPDM |

### Cable

|                                 |   |
|---------------------------------|---|
| Standards/specifications        | M12 connector IEC 61076-2-101                   |
| Ambient temperature (operation) | -40 °C ... 85 °C (cable, fixed installation)    |
|                                 | -25 °C ... 85 °C (cable, flexible installation) |

### Standards and Regulations

|  |                 |
|--|-----------------|
| Standard designation                   | M12 connector   |
| Standards/regulations                  | IEC 61076-2-101 |
| Flammability rating according to UL 94 | V0              |

### Environmental Product Compliance

|            |   |
|------------|---|
| China RoHS | Environmentally Friendly Use Period = 50  |
|            | For details about hazardous substances go to tab "Downloads", Category "Manufacturer's declaration" |

## Drawings

# Flush-type connector - SACC-CI-M12FS-12CON-L180 THR - 1441970

Schematic diagram

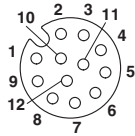

Pin assignment M12, 12-pos., female side view

Drilling diagram

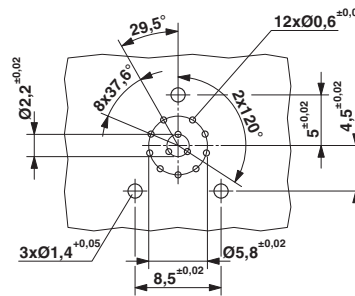

Drilling diagram

Dimensional drawing

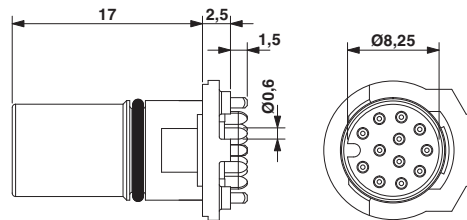

M12 flush-type connector

Dimensional drawing

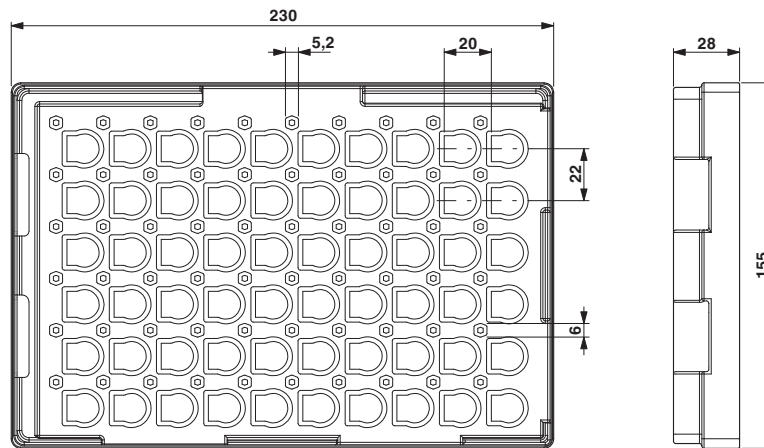

THR tray packaging

## Classifications

eCI@ss

|            |          |
|------------|----------|
| eCI@ss 4.0 | 27060306 |
| eCI@ss 4.1 | 27060306 |
| eCI@ss 5.0 | 27061801 |
| eCI@ss 5.1 | 27260701 |

# Flush-type connector - SACC-CI-M12FS-12CON-L180 THR - 1441970

## Classifications

### eCl@ss

|            |          |
|------------|----------|
| eCl@ss 6.0 | 27279220 |
| eCl@ss 7.0 | 27440103 |
| eCl@ss 8.0 | 27440103 |
| eCl@ss 9.0 | 27440102 |

### ETIM

|          |          |
|----------|----------|
| ETIM 2.0 | EC001297 |
| ETIM 3.0 | EC002061 |
| ETIM 4.0 | EC002061 |
| ETIM 5.0 | EC002061 |
| ETIM 6.0 | EC002061 |

### UNSPSC

|               |          |
|---------------|----------|
| UNSPSC 6.01   | 31251501 |
| UNSPSC 7.0901 | 31251501 |
| UNSPSC 11     | 31251501 |
| UNSPSC 12.01  | 31251501 |
| UNSPSC 13.2   | 39121413 |

## Approvals

### Approvals

Approvals

UL Recognized / EAC

Ex Approvals

### Approval details

|                                |   |   |               |
|--------------------------------|---|---|---------------|
| UL Recognized                  |  | <a href="http://database.ul.com/cgi-bin/XYV/template/LISEXT/1FRAME/index.htm">http://database.ul.com/cgi-bin/XYV/template/LISEXT/1FRAME/index.htm</a> | FILE E 118976 |
| mm <sup>2</sup> /AWG/kcmil     | 26-20   |   |               |
| Nominal current I <sub>N</sub> | 1.5 A   |   |               |
| Nominal voltage U <sub>N</sub> | 30 V  |   |               |

# Flush-type connector - SACC-CI-M12FS-12CON-L180 THR - 1441970

## Approvals

EAC



B.01742

## Accessories

### Accessories

#### Contact insert

Sample set - SACC-CIM12FS12PL180THRSHSAMPLE - 1413562



Sensor/actuator flush-type socket, 12-pos. with shroud, A-coded, with straight THR solder connection, contact insert only

## Panel mounting base

Housing screw connection - SACC-M12-SCO NUT - 1552243



M12 SPEEDCON housing screw connection for M12 female inserts, with O-ring, for all SPEEDCON-capable THR and wave soldering contact carriers

Housing screw connection - SACC-DSIV-M12-NUT - 1416144



Housing screw connection with M12 standard thread, with O-ring, for the two-piece straight M12 THR contact carrier and for the two-piece angled M12 contact carrier

Housing screw connection - SACC-M12-SCO NUT L 90 - 1432460



M12-SPEEDCON housing screw connection for M12 female inserts, with flat gasket, for all Speedcon-compatible THR and wave soldering contact carriers

## Flush-type connector - SACC-CI-M12FS-12CON-L180 THR - 1441970

### Accessories

Housing screw connection - SACC-BP-F-M12/M15-6-THR - 1414004



Housing screw connection, SocketLink:M12, Rear mounting, M15 x 1

---

Housing screw connection - SACC-BP-F-M12/M15-7-THR - 1414003



Housing screw connection, SocketLink:M12, Rear mounting, M15 x 1

---

Housing screw connection - SACC-BP-F-M12/M15-6-THR SCO - 1414020



Housing screw connection, SocketLink:M12-SPEEDCON, Rear mounting, M15 x 1

---

Housing screw connection - SACC-BP-F-M12/M15-7-THR SCO - 1414005



Housing screw connection, SocketLink:M12-SPEEDCON, Rear mounting, M15 x 1

---

Housing screw connection - SACC-BP-F-M12/THR-1,0/1,8-9TIP - 1419630



M12 threaded sleeve with tolerance-compensating function, for straight, THR solderable M12 socket contact inserts. Suitable for 1.0 mm ... 1.8 mm thick front plates.

---

## Flush-type connector - SACC-CI-M12FS-12CON-L180 THR - 1441970

### Accessories

Housing screw connection - SACC-BP-F-M12/THR-1,7/2,5-9TIP - 1419631



M12 threaded sleeve with tolerance-compensating function, for straight, THR solderable M12 socket contact inserts. Suitable for 1.7 mm ... 2.5 mm thick front plates.

---

Housing screw connection - SACC-BP-F-M12/THR-2,4/3,2-9TIP - 1419633



M12 threaded sleeve with tolerance-compensating function, for straight, THR solderable M12 socket contact inserts. Suitable for 2.4 mm ... 3.2 mm thick front plates.

---

Housing screw connection - SACC-BP-F-M12/THR-3,1/3,9-9TIP - 1419634



M12 threaded sleeve with tolerance-compensating function, for straight, THR solderable M12 socket contact inserts. Suitable for 3.1 mm ... 3.9 mm thick front plates.

---

Housing screw connection - SACC-M12 NUT PRESS - 1437889



Housing screw connection for two-piece M12 connectors for the reflow soldering process.

---

Housing screw connection - SACC-DSIV-M12-NUT-9 THR - 1417989



Housing screw connection with M12 standard thread, with O-ring, for the two-piece straight M12 THR contact carrier and for the two-piece angled M12 contact carrier

---

Protective cap

## Flush-type connector - SACC-CI-M12FS-12CON-L180 THR - 1441970

### Accessories

Screw plug - PROT-M12 - 1680539



An M12 screw plug for the unoccupied M12 sockets of the sensor/actuator cable, boxes and flush-type connectors

---

Screw plug - PROT-M12 SH - 1503302



An M12 screw plug for the unoccupied M12 sockets of the shielded sensor/actuator cable, boxes and flush-type connectors

---

Screw plug - PROT-M12 FB - 1555538



M12 high-grade steel screw plug, for unoccupied M12 sockets of the sensor/actuator cables, boxes and flush-type connectors for the food industry

---

---