

# EAO – Your Expert Partner for Human Machine Interfaces

## 82-6153.21A4 - Illuminated pushbutton 22 mm stainless-steel, maintain

### 82-6153.21A4 - Illuminated pushbutton 22 mm stainless-steel, maintain



*Attention: The preview is based on a sample product. This can differ from your current configuration.*

#### Mounting

Mounting cut-out Ø 22,3 mm  
Design flush

#### Front

Front dimension Ø 25 mm  
Front shape round  
Front ring shape flush  
Front bezel material Stainless steel

#### Other Attributes

Operating voltage 24 V VDC  
Weight 0,018 kg  
Operation current 7 mA

#### Operating-/Indication part

Lens optics opaque  
Lens material Stainless steel  
Lens profile flat  
Lens illumination illuminative  
Lens colour Stainless steel

#### IP-Rating

Front protection IP 65, IP 67

#### Connection Method

Terminal Solder 2.8 x 0.5 mm

#### Actuator

Switching action Maintained

#### Switching element

Switching current 3 A  
Contact material gold-plated silver  
Contacts 1 C  
Switching system Snap-action switching element  
Switching voltage 240 V VAC/DC

#### Illumination

Illumination Ring with LED bi-colour red/green

#### Function

Illuminated pushbutton

# EAO – Your Expert Partner for Human Machine Interfaces

82-6153.21A4 - Illuminated pushbutton 22 mm stainless-steel, maintain

## Dimensions

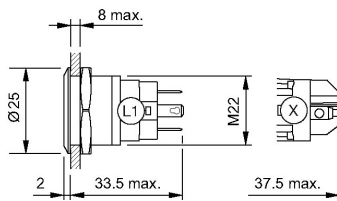

## Mounting cut-outs

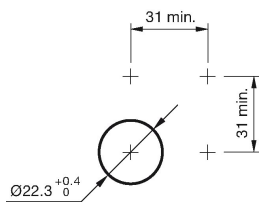

## Wiring diagram

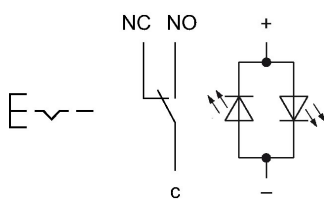

## Component layout



## Legend

Switching action: C = Maintained

Contacts: C = Changeover