

Base strip - MSTBVA 2,5/ 9-G - 1755587

Please be informed that the data shown in this PDF Document is generated from our Online Catalog. Please find the complete data in the user's documentation. Our General Terms of Use for Downloads are valid (<http://phoenixcontact.com/download>)

Header, nominal current: 12 A, rated voltage (III/2): 320 V, number of positions: 9, pitch: 5 mm, Color: green, contact surface: Tin, mounting: Wave soldering



The figure shows a 10-position version of the product

Why buy this product

- Maximum flexibility when it comes to device design – one header for connectors with different connection technologies
- Well-known mounting principle allows worldwide use
- Vertical connection enables multi-row arrangement on the PCB
- Closed contour for optimum stability of the plug-in connection

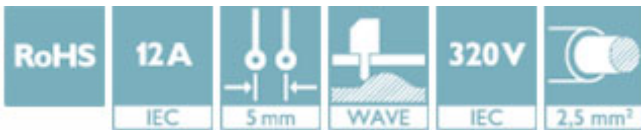

Key Commercial Data

Packing unit	100 STK
GTIN	 4 017918 029166
GTIN	4017918029166
Weight per Piece (excluding packing)	3.360 g
Custom tariff number	85366930
Country of origin	Germany

Technical data

Dimensions

Length [l]	8.6 mm
Pitch	5 mm
Dimension a	40 mm
Width [w]	47 mm
Constructional height	12 mm
Height [h]	15.9 mm
Length of the solder pin	3.9 mm
Pin dimensions	1 x 1 mm

Base strip - MSTBVA 2,5/ 9-G - 1755587

Technical data

Dimensions

Hole diameter	1.4 mm
---------------	--------

General

Range of articles	MSTBVA 2,5/...-G
Insulating material group	I
Rated surge voltage (III/3)	4 kV
Rated surge voltage (III/2)	4 kV
Rated surge voltage (II/2)	4 kV
Rated voltage (III/3)	250 V
Rated voltage (III/2)	320 V
Rated voltage (II/2)	400 V
Connection in acc. with standard	EN-VDE
Nominal current I_N	12 A
Maximum load current	12 A
Insulating material	PA
Flammability rating according to UL 94	V0
Color	green
Number of positions	9

Standards and Regulations

Connection in acc. with standard	EN-VDE
	CSA
Flammability rating according to UL 94	V0

Environmental Product Compliance

China RoHS	Environmentally friendly use period: unlimited = EFUP-e
	No hazardous substances above threshold values

Drawings

Drilling diagram

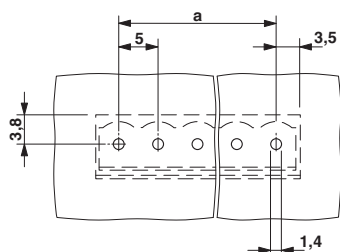

Dimensional drawing

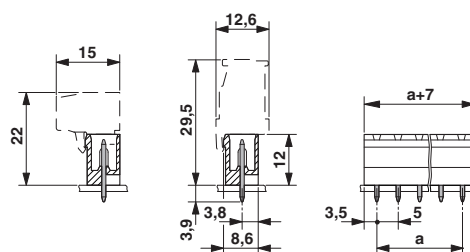

Base strip - MSTBVA 2,5/ 9-G - 1755587

Classifications

eCl@ss

eCl@ss 4.0	272607xx
eCl@ss 4.1	27260701
eCl@ss 5.0	27260701
eCl@ss 5.1	27260701
eCl@ss 6.0	27260704
eCl@ss 7.0	27440402
eCl@ss 8.0	27440402
eCl@ss 9.0	27440402

ETIM

ETIM 3.0	EC001121
ETIM 4.0	EC002637
ETIM 5.0	EC002637
ETIM 6.0	EC002637

UNSPSC

UNSPSC 6.01	30211810
UNSPSC 7.0901	39121409
UNSPSC 11	39121409
UNSPSC 12.01	39121409
UNSPSC 13.2	39121409

Approvals

Approvals

Approvals

CSA / VDE Gutachten mit Fertigungsüberwachung / IECEE CB Scheme / cULus Recognized / EAC

Ex Approvals

Approval details

CSA		13631
	B	D
Nominal current I _N	12 A	10 A
Nominal voltage U _N	300 V	300 V

Base strip - MSTBVA 2,5/ 9-G - 1755587

Approvals

VDE Gutachten mit Fertigungsüberwachung		http://www.vde.com/en/Institute/OnlineService/VDE-approved-products/Pages/Online-Search.aspx	40004701
Nominal current IN	12 A		
Nominal voltage UN	250 V		

IECEE CB Scheme		http://www.iecee.org/	DE1-58978-B1B2
Nominal current IN	12 A		
Nominal voltage UN	250 V		

cULus Recognized		http://database.ul.com/cgi-bin/XYV/template/LISEXT/1FRAME/index.htm	E60425-19931011
	B	D	
Nominal current IN	12 A	10 A	
Nominal voltage UN	300 V	300 V	

EAC		B.01742
-----	--	---------

Accessories

Accessories

Coding element

Coding star - CR-MSTB - 1734401

Coding section, inserted into the recess in the header or the inverted plug, red insulating material



Filler plug

Base strip - MSTBVA 2,5/ 9-G - 1755587

Accessories

Accessories - MSTB-BL - 1755477



Keying cap, for forming sections, plugs onto header pin, green insulating material

Labeled terminal marker

Marker card - SK 5/3,8:FORTL.ZAHLEN - 0804183



Marker card, Card, white, labeled, Horizontal: Consecutive numbers 1 - 10, 11 - 20, etc. up to 91 - (99)100, Mounting type: adhesive, for terminal block width: 5 mm, Lettering field: 5 x 3.8 mm

Additional products

Printed-circuit board connector - TVFKC 1,5/ 9-ST - 1713907



Plug component, nominal current: 10 A, rated voltage (III/2): 320 V, number of positions: 9, pitch: 5 mm, connection method: Push-in spring connection, Color: green, contact surface: Tin

Printed-circuit board connector - TVFKCL 1,5/ 9-ST - 1715992

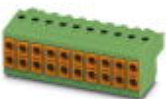

Plug component, nominal current: 10 A, rated voltage (III/2): 320 V, number of positions: 9, pitch: 5 mm, connection method: Push-in spring connection, Color: green, contact surface: Tin

Plug - QC 1,5/ 9-ST - 1718038



Plug component, nominal current: 12 A, rated voltage (III/2): 630 V, number of positions: 9, pitch: 5 mm, connection method: Displacement connection, Color: green, contact surface: Tin

Base strip - MSTBVA 2,5/ 9-G - 1755587

Accessories

Printed-circuit board connector - FKCN 2,5/ 9-ST - 1732810

Plug component, nominal current: 12 A, rated voltage (III/2): 320 V, number of positions: 9, pitch: 5 mm, connection method: Push-in spring connection, Color: green, contact surface: Tin



Printed-circuit board connector - MSTB 2,5/ 9-ST - 1754588

Plug component, nominal current: 12 A, rated voltage (III/2): 320 V, number of positions: 9, pitch: 5 mm, connection method: Screw connection with tension sleeve, Color: green, contact surface: Tin



Printed-circuit board connector - MSTB 2,5/ 9-STZ - 1758995

Plug component, nominal current: 12 A, rated voltage (III/2): 320 V, number of positions: 9, pitch: 5 mm, connection method: Screw connection with tension sleeve, Color: green, contact surface: Tin



Plug - MVSTBW 2,5/ 9-STEH - 1763401

Plug component, nominal current: 12 A, rated voltage (III/2): 320 V, number of positions: 9, pitch: 5 mm, connection method: Screw connection with tension sleeve, Color: green, contact surface: Tin

Printed-circuit board connector - MSTBP 2,5/ 9-ST - 1765849

Plug component, nominal current: 12 A, rated voltage (III/2): 320 V, number of positions: 9, pitch: 5 mm, connection method: Screw connection with tension sleeve, Color: green, contact surface: Tin



Printed-circuit board connector - SMSTB 2,5/ 9-ST - 1768820

Plug component, nominal current: 12 A, rated voltage (III/2): 320 V, number of positions: 9, pitch: 5 mm, connection method: Screw connection with tension sleeve, Color: green, contact surface: Tin



Base strip - MSTBVA 2,5/ 9-G - 1755587

Accessories

Printed-circuit board connector - FRONT-MSTB 2,5/ 9-ST - 1779482

Plug component, nominal current: 12 A, rated voltage (III/2): 320 V, number of positions: 9, pitch: 5 mm, connection method: Front screw connection, Color: green, contact surface: Tin



Printed-circuit board connector - MSTBT 2,5/ 9-ST - 1779903

Plug component, nominal current: 12 A, rated voltage (III/2): 320 V, number of positions: 9, pitch: 5 mm, connection method: Screw connection with tension sleeve, Color: green, contact surface: Tin



Printed-circuit board connector - MVSTBR 2,5/ 9-ST - 1792087

Plug component, nominal current: 12 A, rated voltage (III/2): 320 V, number of positions: 9, pitch: 5 mm, connection method: Screw connection with tension sleeve, Color: green, contact surface: Tin



Printed-circuit board connector - MVSTBW 2,5/ 9-ST - 1792595

Plug component, nominal current: 12 A, rated voltage (III/2): 320 V, number of positions: 9, pitch: 5 mm, connection method: Screw connection with tension sleeve, Color: green, contact surface: Tin



Printed-circuit board connector - FKCT 2,5/ 9-ST - 1909281

Plug component, nominal current: 12 A, rated voltage (III/2): 320 V, number of positions: 9, pitch: 5 mm, connection method: Push-in spring connection, Color: green, contact surface: Tin



Base strip - MSTBVA 2,5/ 9-G - 1755587

Accessories

Printed-circuit board connector - FKCVR 2,5/ 9-ST - 1909786



Plug component, nominal current: 12 A, rated voltage (III/2): 320 V, number of positions: 9, pitch: 5 mm, connection method: Push-in spring connection, Color: green, contact surface: Tin

Printed-circuit board connector - FKCVW 2,5/ 9-ST - 1910102



Plug component, nominal current: 12 A, rated voltage (III/2): 320 V, number of positions: 9, pitch: 5 mm, connection method: Push-in spring connection, Color: green, contact surface: Tin

Printed-circuit board connector - FKC 2,5/ 9-ST - 1910429



Plug component, nominal current: 12 A, rated voltage (III/2): 320 V, number of positions: 9, pitch: 5 mm, connection method: Push-in spring connection, Color: green, contact surface: Tin

Printed-circuit board connector - FKCS 2,5/ 9-ST - 1974805



Plug component, nominal current: 12 A, rated voltage (III/2): 320 V, number of positions: 9, pitch: 5 mm, connection method: Push-in spring connection, Color: green, contact surface: Tin
