

# EAO – Your Expert Partner for Human Machine Interfaces

## 51-271.0252 - Illuminated pushbutton actuator

### 51-271.0252 - Illuminated pushbutton actuator

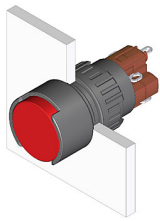

*Attention: The preview is based on a sample product. This can differ from your current configuration.*

#### Mounting

Mounting cut-out  
Design Ø 16 mm  
raised

#### Front

Front dimension  
Front shape  
Front bezel colour  
Front bezel material Ø 18 mm  
round  
black  
Plastic

#### Other Attributes

Weight 0,006 kg

#### Operating-/Indication part

Lens illumination illuminative

#### IP-Rating

Front protection IP65

#### Connection Method

Terminal Solder

#### Actuator

Switching action  
Housing colour  
Housing material Maintain  
black  
Plastic

#### Switching element

Switching system  
Contacts  
Switching current  
Contact material  
Switching voltage Snap-action switching element  
1 NC + 1 NO  
5 A  
250 V AC

#### Function

Illuminated pushbutton

# EAO – Your Expert Partner for Human Machine Interfaces

51-271.0252 - Illuminated pushbutton actuator

## Dimensions

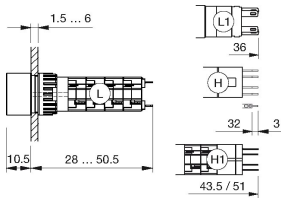

H = Universal terminal 2.0 x 0.5 mm

## Mounting cut-outs

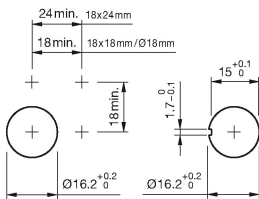

## Wiring diagram

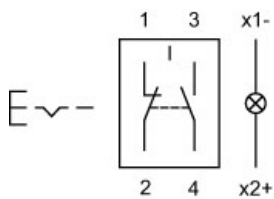

## Legend

Contacts: NC = Normally closed, NO = Normally open  
Switching action: C = Maintained