

EAO – Your Expert Partner for Human Machine Interfaces

82-4151.0112 - Indicator 16 mm stainless-steel

82-4151.0112 - Indicator 16 mm stainless-steel



Attention: The preview is based on a sample product. This can differ from your current configuration.

Mounting

Mounting cut-out Ø 16 mm
Design flush

Front

Front dimension Ø 18 mm
Front shape round
Front ring shape flush
Front bezel material Stainless steel

Other Attributes

Operating voltage 6 V AC/DC
Weight 0,018 kg
Operation current 7 mA

Operating-/Indication part

Lens optics opaque
Lens material Stainless steel
Lens profile flat
Lens illumination illuminative
Lens colour Stainless steel

IP-Rating

Front protection IP65, IP67

Connection Method

Terminal Solder 2.8 x 0.5 mm

Illumination

Illumination Ring with red LED

Function

Indicator

EAO – Your Expert Partner for Human Machine Interfaces

82-4151.0112 - Indicator 16 mm stainless-steel

Dimensions

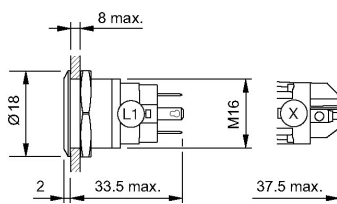

Mounting cut-outs

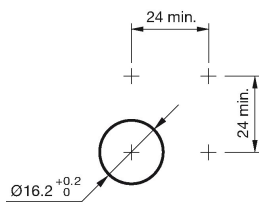

Wiring diagram

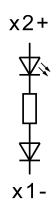

Component layout

