

**Crimping contact
HDC-C-HD-BM2.5AU**

Weidmüller Interface GmbH & Co. KG
Klingenbergstraße 16
D-32758 Detmold
Germany
Fon: +49 5231 14-0
Fax: +49 5231 14-292083
www.weidmueller.com



Crimps provide a electrical and mechanical connection between wire and contact that is both secure and reliable. The optimal crimp connection is gas-tight and corrosion-resistant.

General ordering data

Type	HDC-C-HD-BM2.5AU
Order No.	1651710000
Version	Heavy Duty Connectors, Crimp contact, HD, HDD, HQ, MixMate, Female, Conductor cross-section, max.: 2.5, turned, Copper alloy
GTIN (EAN)	4008190400385
Qty.	100 pc(s).

Data sheet

Crimping contact HDC-C-HD-BM2.5AU

Weidmüller Interface GmbH & Co. KG
 Klingenbergstraße 16
 D-32758 Detmold
 Germany
 Fon: +49 5231 14-0
 Fax: +49 5231 14-292083
 www.weidmueller.com

Technical data

Dimensions and weights

Net weight	0.62 g	Diameter	3.5 mm
------------	--------	----------	--------

General data

Contact diameter, male Ø	1.6 mm	Cross-section for connected wire	2.5 mm ²
Material	Copper alloy	Plugging cycles	≥ 500
Production methods	turned	Series	HD
Stripping length, rated connection	8 mm	Surface finish	gold
Type	Female	Type of connection	Crimp connection
Version insert	HD, HDD, HQ, MixMate	Volume resistance	≤ 4mΩ

Classifications

ETIM 3.0	EC000796	ETIM 4.0	EC000796
ETIM 5.0	EC000796	ETIM 6.0	EC000796
UNSPSC	30-21-18-01	eClass 5.1	27-14-34-19
eClass 6.2	27-26-12-02	eClass 7.1	27-44-02-04
eClass 8.1	27-44-02-04	eClass 9.0	27-44-02-04
eClass 9.1	27-44-02-04		

Approvals

Approvals



ROHS Conform

Downloads

Brochure/Catalogue	CAT 3 HDC 17/18 EN FL FIELDWIRING EN
Engineering Data	EPLAN, WSCAD

Data sheet

**Crimping contact
HDC-C-HD-BM2.5AU**

Weidmüller Interface GmbH & Co. KG
 Klingenbergstraße 16
 D-32758 Detmold
 Germany
 Fon: +49 5231 14-0
 Fax: +49 5231 14-292083
 www.weidmueller.com

Drawings

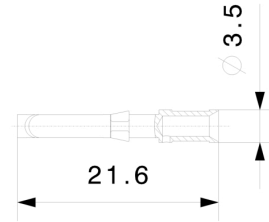
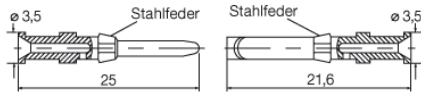

Leiterquerschnitt	Abisolierlänge
0,14 - 0,37 mm ²	AWG 26-22 8 mm
0,50 mm ²	AWG 20 8 mm
0,75 - 1,00 mm ²	AWG 18 8 mm
1,50 mm ²	AWG 16 8 mm
2,50 mm ²	AWG 14 8 mm