

MARKETING SALES DRAWING

DIMENSIONS IN INCHES - DO NOT SCALE THIS DRAWING
 DIMENSIONS IN METRIC - []

Electrical Testing
 per Tusonix standard
 test plans and Mil-Std-202
 Test Methods.

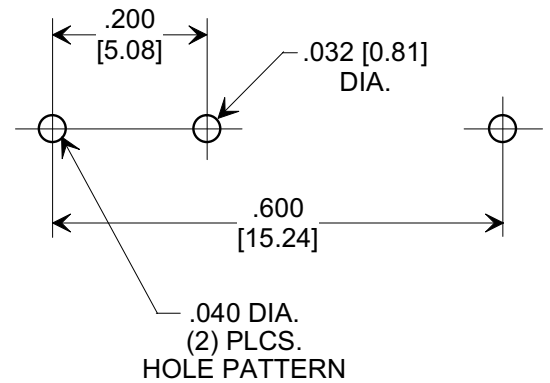
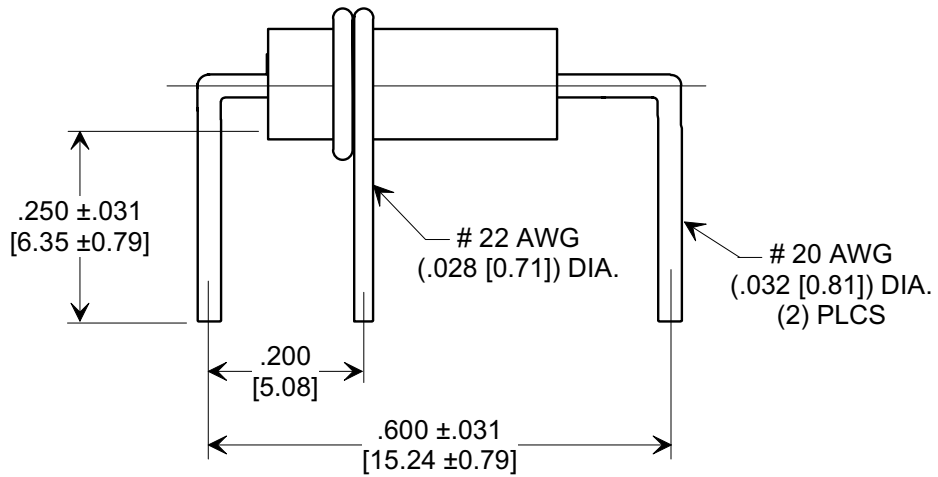
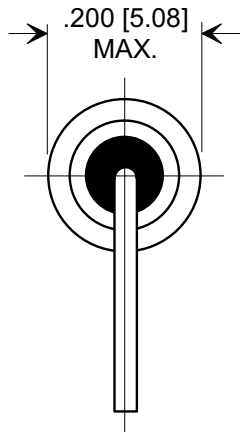
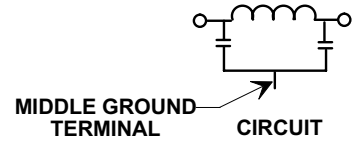
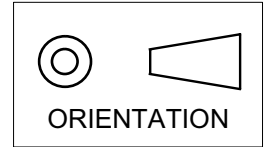

Cx 1KHz @ 25°C	WORKING VOLTAGE		IR	CURRENT I _{dc} (A)	TYPICAL NO LOAD INSERTION LOSS @ 25°C (dB) PER MIL-STD-220			
	+85°C 250 @ 60 HZ VAC	+125°C 200 VDC			1 MHz	10 MHz	100 MHz	1 GHz
10,000/5,000			10 G Ω	10 MAX.	2	18	60	70

X-2015 Rev-0	REVISION RECORD	--TOLERANCES-- Unless Otherwise Specified		Title P.C. BOARD MOUNT		
	Original Release C.O.	0	DECIMAL ± .031 [0.79]	π TYPE LOW PASS FILTER		
	WAS SK 6871-001. EC 07-27-88	1	ANGLES ±	Drawn	S.M. 05-08-00	Scale 4 X
	4056	2	RDN TO COMP FMT. S.M. 05-09-00	Approved		T.C. 05-08-00
	COMPLETELY REVISED & REDRAWN PER SK 6905-000. L.E. 09-29-88	3		TUSONIX		A
4170	4	TUCSON, ARIZONA		4100-053		