

KEMET, SS, Proximity, SMD, Pyroelectric Infrared, Detection Up To 5 Meters

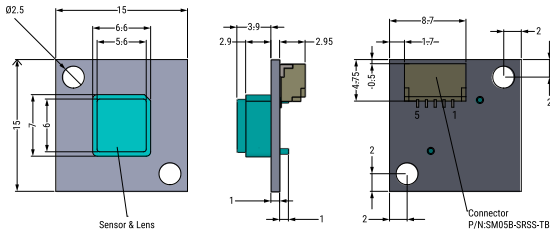

**Dimensions**

<b>L</b>	15mm NOM
<b>W</b>	15mm NOM

**Packaging Specifications**

<b>Packaging:</b>	Tray, Box
<b>Packaging Quantity:</b>	200
<b>Weight:</b>	800 mg

**General Information**

<b>Series:</b>	SS
<b>Type:</b>	Proximity
<b>Style:</b>	SMD
<b>Description:</b>	Sensor Module with Lens
<b>Features:</b>	Detection Up To 5 Meters
<b>RoHS:</b>	Yes
<b>Qualifications:</b>	REACH

**Specifications**

<b>Temperature Range:</b>	-40/+70C
<b>Voltage DC:</b>	3 VDC (Output, Detection), 0.0 VDC (Output, Non-Detection), 2.5 - 5.5 (Supply Voltage)
<b>Current:</b>	800 uA MAX (Consumption)
<b>Miscellaneous:</b>	Field of View: Horizontal +/- 37 degree, Vertical +/-28 degrees. Detection Output Voltage: 0.2 Seconds. Warm Up Time: 30 Sec (MAX)