

Main

Range of product	Harmony XB4
Product or component type	Complete selector switch
Device short name	XB4
Bezel material	Chromium plated metal
Fixing collar material	Zamak
Mounting diameter	22 mm
Sale per indivisible quantity	1
Dust zone	Zone 21 - 22
Gas zone	Zone 1 - 2
Type of operator	Stay put
Operator profile	Key switch
Key number	455
Contacts type and composition	2 NO

Complementary

Width	46.2 mm
Height	30 mm
Depth	110 mm
Product weight	0.177 kg
Device mounting	Fixing hole \varnothing 22.5 mm (+/- 0.2 mm) conforming to EN/IEC 60947-1
Fixing center	\geq 30 x 40 mm on support panel : 1...6 mm
Embedding depth	58 mm
Marking	Ex tb IIIC Db Ex db eb IIC Gb II 2 GD
Shape of signaling unit head	Round
Operator position information	3 positions +/- 45°
Key withdrawal position	Center
Contact operation	Slow-break
Contacts usage	Standard contacts
Positive opening	Without
Mechanical durability	5000000 cycles

Connections - terminals	Screw clamp terminals, clamping capacity: 2 x 1.5 mm ² with cable end conforming to EN/IEC 60947-1 Screw clamp terminals, clamping capacity: 1 x 2.5 mm ² without cable end conforming to EN/IEC 60947-1
Tightening torque	0.8...1.2 N.m conforming to EN 60947-1
[I _{th}] conventional free air thermal current	10 A conforming to EN/IEC 60947-5-1
[U _i] rated insulation voltage	415 V
[I _e] rated operational current	1.9 A at 380 V AC, A600 conforming to EN/IEC 60947-5-1 3 A at 240 V AC, A600 conforming to EN/IEC 60947-5-1 6 A at 120 V AC, A600 conforming to EN/IEC 60947-5-1 0.27 A at 250 V DC, Q300 conforming to EN/IEC 60947-5-1 0.55 A at 125 V DC, Q300 conforming to EN/IEC 60947-5-1 2.87 A at 24 V DC, Q300 conforming to EN/IEC 60947-5-1

Environment

Protective treatment	TH
Ambient air temperature for storage	-40...70 °C
Ambient air temperature for operation	-20...75 °C
IP degree of protection	IP66 conforming to IEC 60529
Standards	CSA C22.2 No 213 EN/IEC 60079-0 : 2009 EN/IEC 60079-1 : 2009 EN/IEC 60079-7 : 2009 EN/IEC 60079-31 : 2009 UL 60079-0 UL 60079-1 UL 60079-31 ANSI/ISA 12.12.01
Product certifications	INERIS 04ATEX9004U

Dimensions

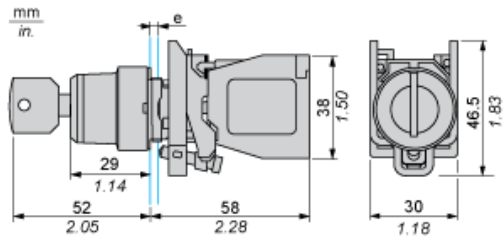

e : support thickness: 1 to 6 mm / 0.04 to 0.24 in.

Panel Cut-out for Pushbuttons, Switches and Pilot Lights (Finished Holes, Ready for Installation)

Connection by Screw Clamp Terminals

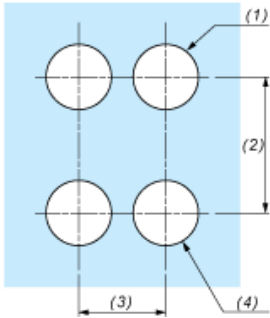

- (1) Diameter on finished panel or support
- (2) 40 mm min. / 1.57 in. min.
- (3) 30 mm min. / 1.18 in. min.
- (4) $\text{Ø } 22.5 \text{ mm} / 0.89 \text{ in. recommended } (\text{Ø } 22.3 \text{ mm }_0^{+0.4} / 0.88 \text{ in. }_0^{+0.016})$