

# MINIFIX

New range  
MINIFIX



## DESCRIPTION

The MINIFIX mounting comprises an elastomer pad with an anti-slip ridged surface and a threaded stud allowing accurate height adjustment of equipment.

Made in two hardnesses (50 and 80 Sh) the MINIFIX mounting is perfectly suited to a variety of applications and is delivered complete with fixing nuts and washers. MINIFIX mounting nuts and screws are made of steel or stainless steel.

## CHARACTERISTICS

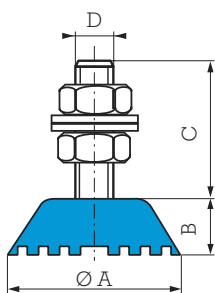

Reference Stainl. steel	Reference Steel	Hardness	Colour	Ø A mm	B mm	C mm	D	Load range daN
-	530801	50 SBR 80 Nitrile	grey black	32	15	38	M8 stud	5 - 30 15 - 70
-	530802*	50 SBR 80 Nitrile	grey black	46	15	-	M10 nut	10 - 80 25 - 200
530806	530805	50 SBR 80 Nitrile	grey black	46	15	38	M10 stud	10 - 40 25 - 100
-	530807	50 SBR 80 Nitrile	grey black	70	25.5	55.5	M12 stud	50 - 120 100 - 350

\* Threaded centre hole.  
See current price list for availability of items.

1 kg ≈ 1 daN

## APPLICATIONS

Simple and economic, MINIFIX mountings are particularly suitable for the installation of equipment such as:

- Electrical or electronic enclosures.
- Packaging equipment.
- Test and measuring equipment.
- Equipment for the food industry.
- Laboratory equipment.
- Household appliances.