

BLZ 5.08 socket blocks

with Screw connection, tin-plated version

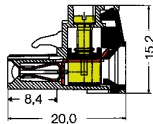

B-Version



BLZF 5.08 socket blocks

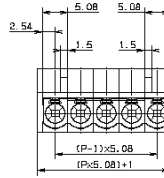
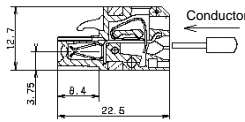

BLZ 5.08/90 socket blocks

with Screw connection, tin-plated version

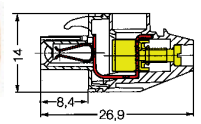

B-Version



BLZ 5.08/2 ... 24

No. of poles	Type	Cat.No.	Qty.
2	BLZ 5.08/2 SN OR	152646	100
3	BLZ 5.08/3 SN OR	152656	100
4	BLZ 5.08/4 SN OR	152666	100
5	BLZ 5.08/5 SN OR	152676	50
6	BLZ 5.08/6 SN OR	152686	50
7	BLZ 5.08/7 SN OR	152696	50
8	BLZ 5.08/8 SN OR	152706	50
9	BLZ 5.08/9 SN OR	152716	50
10	BLZ 5.08/10 SN OR	152726	50
11	BLZ 5.08/11 SN OR	152736	50
12	BLZ 5.08/12 SN OR	152746	50
13	BLZ 5.08/13 SN OR	152756	50
14	BLZ 5.08/14 SN OR	152766	50
15	BLZ 5.08/15 SN OR	152776	50
16	BLZ 5.08/16 SN OR	152786	50
17	BLZ 5.08/17 SN OR	152796	20
18	BLZ 5.08/18 SN OR	152806	20
19	BLZ 5.08/19 SN OR	152816	20
20	BLZ 5.08/20 SN OR	152826	20
21	BLZ 5.08/21 SN OR	152836	20
22	BLZ 5.08/22 SN OR	152846	20
23	BLZ 5.08/23 SN OR	152856	20
24	BLZ 5.08/24 SN OR	152866	20

BLZF 5.08/2 ... 24

No. of poles	Type	Cat.No.	Qty.
2	BLZF 5.08/2 SN OR	167991	100
3	BLZF 5.08/3 SN OR	167992	100
4	BLZF 5.08/4 SN OR	167993	100
5	BLZF 5.08/5 SN OR	167994	50
6	BLZF 5.08/6 SN OR	167995	50
7	BLZF 5.08/7 SN OR	167996	50
8	BLZF 5.08/8 SN OR	167997	50
9	BLZF 5.08/9 SN OR	167998	50
10	BLZF 5.08/10 SN OR	167999	50
11	BLZF 5.08/11 SN OR	168000	50
12	BLZF 5.08/12 SN OR	168001	50
13	BLZF 5.08/13 SN OR	168002	50
14	BLZF 5.08/14 SN OR	168003	50
15	BLZF 5.08/15 SN OR	168004	50
16	BLZF 5.08/16 SN OR	168005	50
17	BLZF 5.08/17 SN OR	168006	20
18	BLZF 5.08/18 SN OR	168007	20
19	BLZF 5.08/19 SN OR	168008	20
20	BLZF 5.08/20 SN OR	168009	20
21	BLZF 5.08/21 SN OR	168010	20
22	BLZF 5.08/22 SN OR	168011	20
23	BLZF 5.08/23 SN OR	168012	20
24	BLZF 5.08/24 SN OR	168013	20

BLZ 5.08/2 ... 24/90

No. of poles	Type	Cat.No.	Qty.
2	BLZ 5.08/2/90 SN OR	155276	100
3	BLZ 5.08/3/90 SN OR	155286	100
4	BLZ 5.08/4/90 SN OR	155296	100
5	BLZ 5.08/5/90 SN OR	155306	50
6	BLZ 5.08/6/90 SN OR	155316	50
7	BLZ 5.08/7/90 SN OR	155326	50
8	BLZ 5.08/8/90 SN OR	155336	50
9	BLZ 5.08/9/90 SN OR	155346	50
10	BLZ 5.08/10/90 SN OR	155356	50
11	BLZ 5.08/11/90 SN OR	155366	50
12	BLZ 5.08/12/90 SN OR	155376	50
13	BLZ 5.08/13/90 SN OR	155386	50
14	BLZ 5.08/14/90 SN OR	155396	50
15	BLZ 5.08/15/90 SN OR	155406	50
16	BLZ 5.08/16/90 SN OR	155416	50
17	BLZ 5.08/17/90 SN OR	155426	20
18	BLZ 5.08/18/90 SN OR	155436	20
19	BLZ 5.08/19/90 SN OR	155446	20
20	BLZ 5.08/20/90 SN OR	155456	20
21	BLZ 5.08/21/90 SN OR	155466	20
22	BLZ 5.08/22/90 SN OR	155476	20
23	BLZ 5.08/23/90 SN OR	155486	20
24	BLZ 5.08/24/90 SN OR	155496	20

BLZ 5.08/2 ... 24 B

Lateral dovetail for mounting brackets

No. of poles	Type	Cat.No.	Qty.
2	BLZ 5.08/2B SN OR	152876	100
3	BLZ 5.08/3B SN OR	152886	100
4	BLZ 5.08/4B SN OR	152896	100
5	BLZ 5.08/5B SN OR	152906	50
6	BLZ 5.08/6B SN OR	152916	50
7	BLZ 5.08/7B SN OR	152926	50
8	BLZ 5.08/8B SN OR	152936	50
9	BLZ 5.08/9B SN OR	152946	50
10	BLZ 5.08/10B SN OR	152956	50
11	BLZ 5.08/11B SN OR	152966	50
12	BLZ 5.08/12B SN OR	152976	50
13	BLZ 5.08/13B SN OR	152986	50
14	BLZ 5.08/14B SN OR	152996	50
15	BLZ 5.08/15B SN OR	153006	50
16	BLZ 5.08/16B SN OR	153016	50
17	BLZ 5.08/17B SN OR	153026	20
18	BLZ 5.08/18B SN OR	153036	20
19	BLZ 5.08/19B SN OR	153046	20
20	BLZ 5.08/20B SN OR	153056	20
21	BLZ 5.08/21B SN OR	153066	20
22	BLZ 5.08/22B SN OR	153076	20
23	BLZ 5.08/23B SN OR	153086	20
24	BLZ 5.08/24B SN OR	153096	20

BLZ 5.08/2 ... 24/90B

Lateral dovetail for mounting brackets

No. of poles	Type	Cat.No.	Qty.
2	BLZ 5.08/2/90B SN OR	155506	100
3	BLZ 5.08/3/90B SN OR	155516	100
4	BLZ 5.08/4/90B SN OR	155526	100
5	BLZ 5.08/5/90B SN OR	155536	50
6	BLZ 5.08/6/90B SN OR	155546	50
7	BLZ 5.08/7/90B SN OR	155556	50
8	BLZ 5.08/8/90B SN OR	155566	50
9	BLZ 5.08/9/90B SN OR	155576	50
10	BLZ 5.08/10/90B SN OR	155586	50
11	BLZ 5.08/11/90B SN OR	155596	50
12	BLZ 5.08/12/90B SN OR	155606	50
13	BLZ 5.08/13/90B SN OR	155616	50
14	BLZ 5.08/14/90B SN OR	155626	50
15	BLZ 5.08/15/90B SN OR	155636	50
16	BLZ 5.08/16/90B SN OR	155646	50
17	BLZ 5.08/17/90B SN OR	155656	20
18	BLZ 5.08/18/90B SN OR	155666	20
19	BLZ 5.08/19/90B SN OR	155676	20
20	BLZ 5.08/20/90B SN OR	155686	20
21	BLZ 5.08/21/90B SN OR	155696	20
22	BLZ 5.08/22/90B SN OR	155706	20
23	BLZ 5.08/23/90B SN OR	155716	20
24	BLZ 5.08/24/90B SN OR	155726	20

Accessories

Marking material, strain reliefs, coding elements, compartment dividing element see page 5/133

Cover hoods, locking latch, mounting bracket, floodlight indication see page 5/134