

Type: **MFD-80**
 Article No.: **265250**



IP65, NEMA 4x,

Removable Titan front frame

Ordering information

Description		Graphical display 132 × 64 pixels Switchable backlight Freely definable status LEDs red + green Individual laser inscription via MFD combination*
-------------	--	--

Notes concerning the product group

Backup of real-time clock (only for appropriate devices)

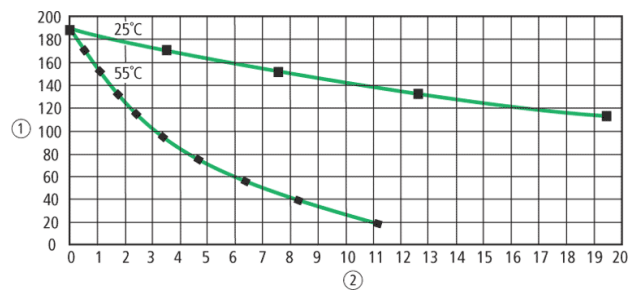

① Backup time (hours)

② Operating time (years)

General			
Standards			EN 61000-6-1/-2/-3/-4, IEC 60068-2-6, IEC 60068-2-27
Weight		kg	0,13
Mounting			2 × 22.5 mm, display is screwed on with 2 fixing rings. When using MFD-CP8..., MFD-AC-CP8 without top-hat rail MFD-TS-144, the mounting plate thickness is 1 – 6 mm. With top-hat rail the mounting plate thickness is 1 – 4 mm.
Climatic environmental conditions			
Operating ambient temperature		°C	-25 to 55, cold as per IEC 60068-2-1, heat as per IEC 60068-2-2
Condensation			Take appropriate measures to prevent condensation
LCD display (clearly legible)		°C	-55(-10 to 0 when background lighting is switched on (continuous operation))
Storage		°C	-40/+70
Relative humidity, non-condensing (IEC/EN 60068-2-30)		%	5 – 95
Air pressure (operation)		hPa	795 – 1080
Ambient conditions, mechanical			
Pollution degree			3
Degree of protection (IEC/EN 60529)			IP65
Vibrations (IEC/EN 60068-2-6)			
Constant amplitude 0.15 mm		Hz	10 – 57
Constant acceleration 2 g		Hz	57 – 150
Mechanical shock resistance (IEC/EN 60068-2-27) semi-sinusoidal 15 g/11 ms		Impacts	18
Drop to IEC/EN 60068-2-31	Drop height	mm	50
Free fall, packaged (IEC/EN 60068-2-32)		m	1
Mounting position			horizontal, vertical
Electromagnetic compatibility (EMC)			

Electrostatic discharge (IEC/EN 61000-4-2, Level 3, ESD)			
Air discharge		kV	8
Contact discharge		kV	6
Electromagnetic fields (IEC/EN 61000-4-3, RFI)		V/m	10
Radio interference suppression (EN 55011)			EN 55011 Class B, EN 55022 Class B
Burst pulses (IEC/EN 61000-4-4, level 3)			
Supply cables		kV	2
Signal lines		kV	2
High-energy pulses (surge) (IEC/EN 61000-4-5)		kV	2 (supply cables, symmetrical)
High-energy pulses (surge) (IEC/EN 61000-4-5, level 2)		kV	0.5 (supply cables, symmetrical)
Immunity to line-conducted interference to (IEC/EN 61000-4-6)		V	10

Insulation resistance

Clearance in air and creepage distances			EN 50178, UL 508, CSA C22.2, no. 142
Insulation resistance			EN 50178

Dimensions

Dimensions

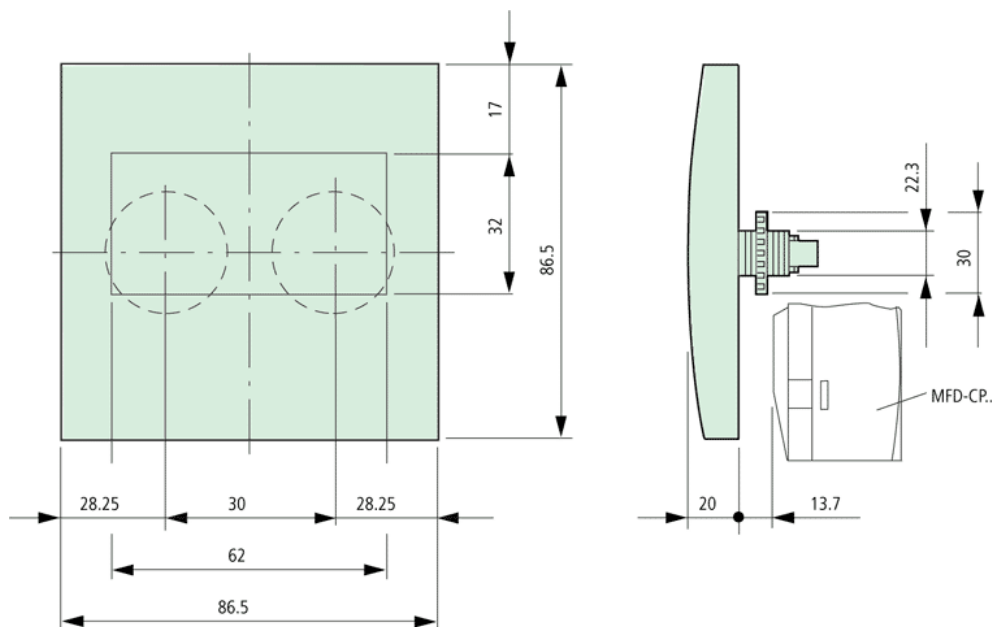

Moeller GmbH, Hein-Moeller-Str. 7-11, D-53115 Bonn
E-Mail: catalog@moeller.net, Internet: www.moeller.net, <http://catalog.moeller.net>

