

Fast-Acting Miniature Cartridge Fuses

5mm x 20mm

multicomp PRO

**RoHS
Compliant**



Description

These fast-acting fuse with high breaking capacity provides protection for printed circuit boards and is used in a large variety of applications. This $\Phi 5\text{mm} \times 20\text{mm}$ device is constructed of a ceramic tube with electro-plated brass end caps. These fuses offers excellent quality and is 100% tested for cold resistance and precise length.



Features

- Miniature fuse with fast-acting, high breaking capacity
- $\Phi 5\text{mm} \times 20\text{mm}$ physical dimensions
- Glass tube, encapsulated design with nickel - plated brass end caps
- Protection against harmful over-currents in primary and secondary applications

Mechanical Specifications

- Operating Temperature : -55°C to 125°C
- Storage Conditions : $+10^{\circ}\text{C}$ to $+60^{\circ}\text{C}$
- Relative humidity : $\leq 75\%$ yearly average without dew, maximum 30 days at 95%
- Vibration Resistance : 24 cycles at 15 min. each (60068-6)
10-60Hz at 0.75mm amplitude
60-2000Hz at 10g acceleration

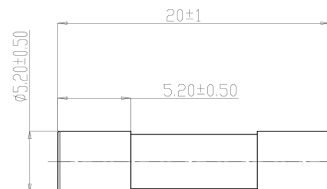
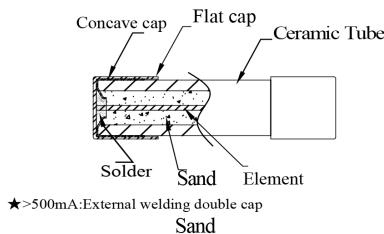

Dimensions : Millimetres

Electrical Specifications

Time vs Current Characteristics Table

(measured with constant current power supply)

Time vs Current Characteristics: UL248-14					
Rated current	100%	210%	275%	400%	1000%
1A to 12.5A	>1h	<30min	40ms to 20s	10ms to 1s	$\leq 30\text{ms}$

Newark.com/multicomp-pro
Farnell.com/multicomp-pro
Element14.com/multicomp-pro

multicomp PRO

Average Time Current (I-T) Curves

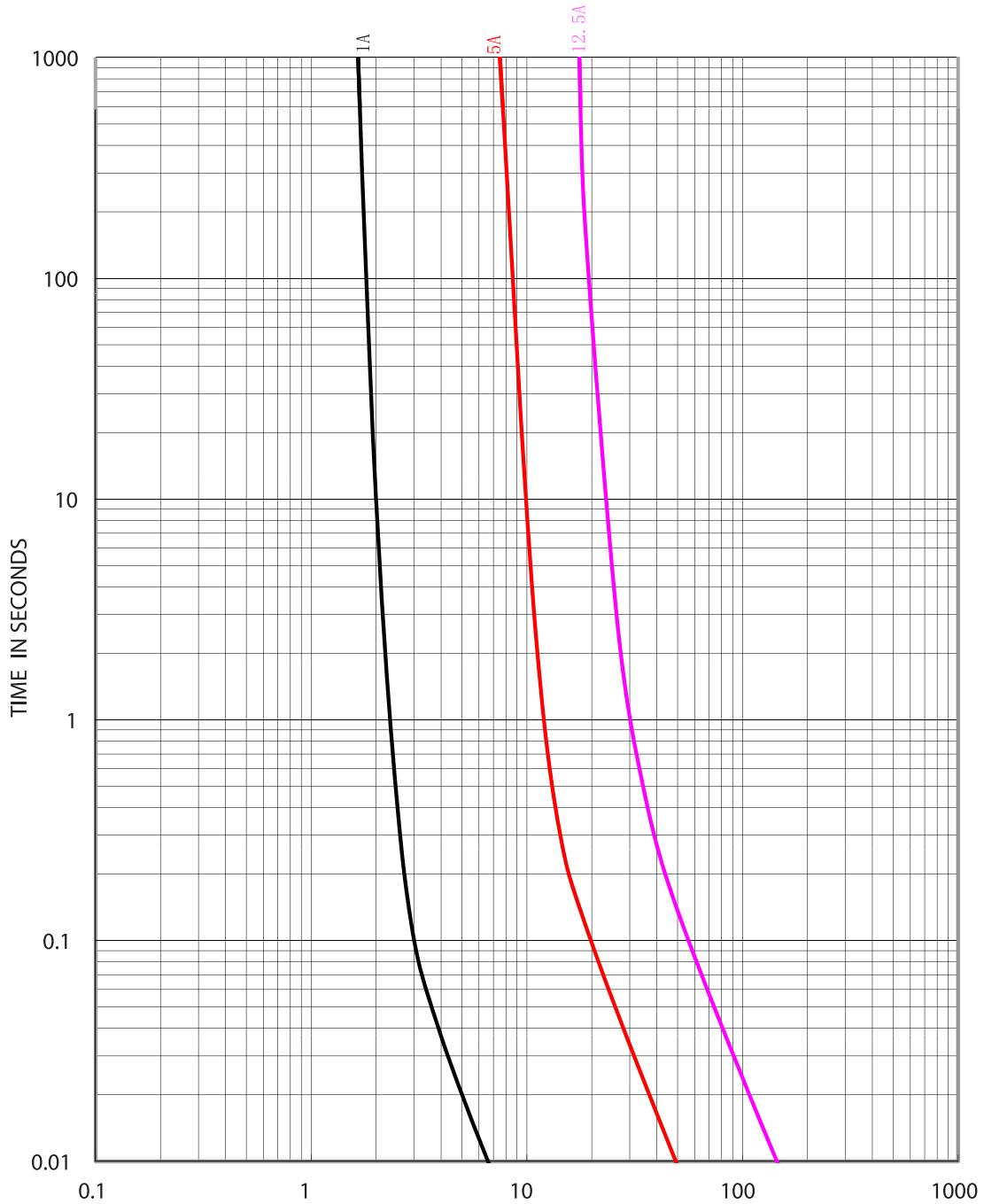

Fast-Acting Miniature Cartridge Fuses 5mm x 20mm

multicomp PRO

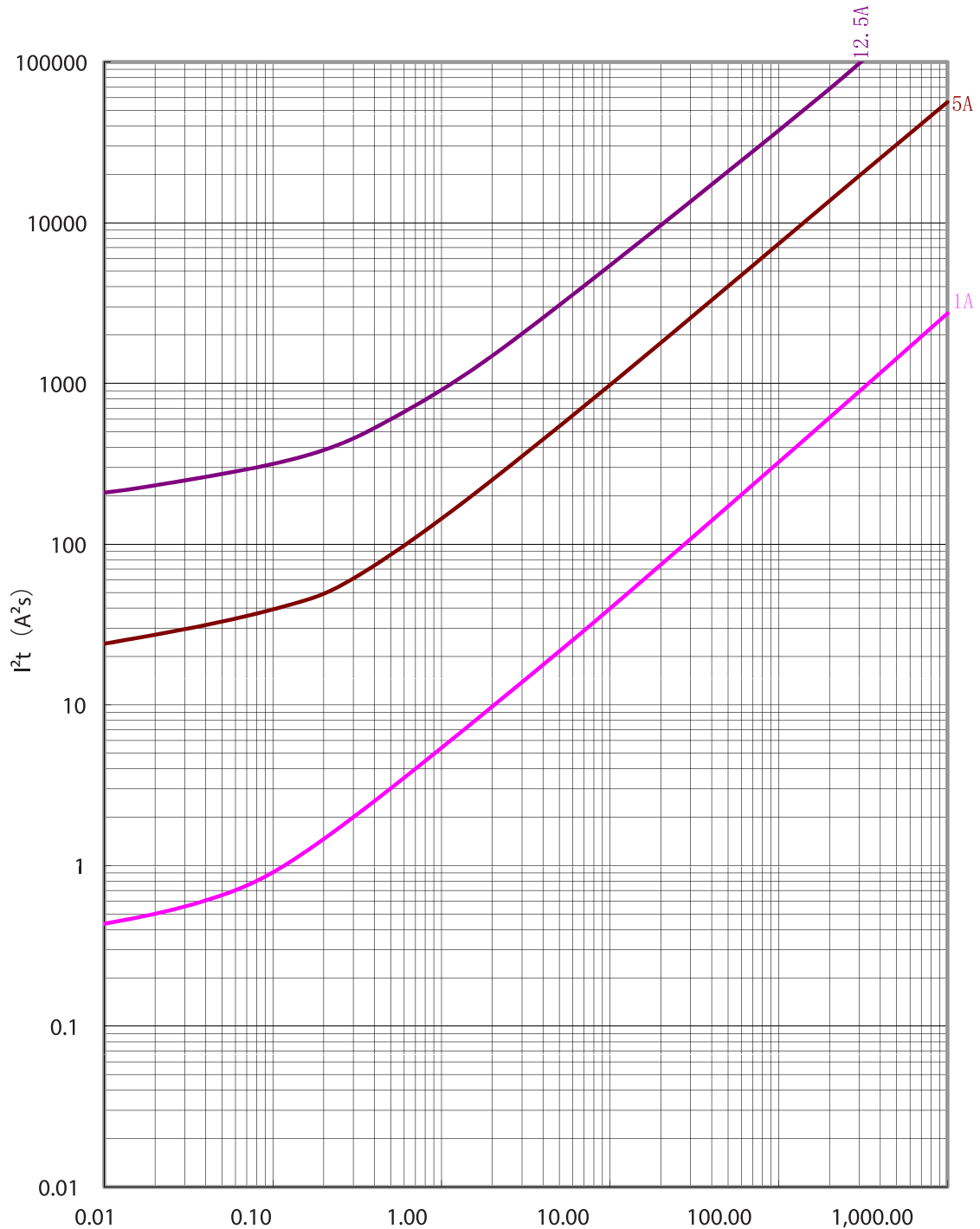

multicomp PRO

Fast-Acting Miniature Cartridge Fuses

5mm x 20mm



Electrical characteristics

Electrical Characteristics at 25°C							
Part Number	Rated Current	Rated Voltage	Nominal Melting I ² t (A ² sec)	Typical cold Resistance (mΩ)	Breaking Capacity	Approvals	
						cURus	TUV
MP007131	1A	250V AC	0.360	360	1500A@250V AC 1500A@300V AC		
MP007132	5A		23.92	20			
MP007130	12.5A		218.8	7.4			

Note: 1. Permissible continuous operating current is ≤100% at ambient temperature of 23°C (73.4°F)
 2. Typical pre-arcing I²t are measured at 10In current.

Temperature Derating Curve

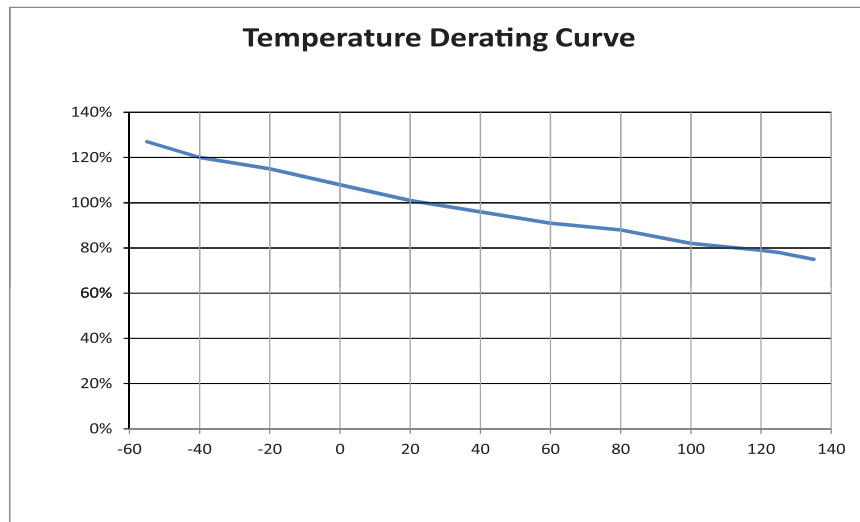

$$\text{Calculation for ideal fuse selection} = \frac{\text{Operating Current (A)}}{\text{Rating (\%} \times 0.75)}$$

Part Number Table

Description	Part Number
Fast-Acting Miniature Cartridge Fuse, 1A, 250V AC, 5mm x 20mm	MP007131
Fast-Acting Miniature Cartridge Fuse, 5A, 250V AC, 5mm x 20mm	MP007132
Fast-Acting Miniature Cartridge Fuse, 12.5A, 250V AC, 5mm x 20mm	MP007130

Important Notice : This data sheet and its contents (the "Information") belong to the members of the AVNET group of companies (the "Group") or are licensed to it. No licence is granted for the use of it other than for information purposes in connection with the products to which it relates. No licence of any intellectual property rights is granted. The Information is subject to change without notice and replaces all data sheets previously supplied. The Information supplied is believed to be accurate but the Group assumes no responsibility for its accuracy or completeness, any error in or omission from it or for any use made of it. Users of this data sheet should check for themselves the Information and the suitability of the products for their purpose and not make any assumptions based on information included or omitted. Liability for loss or damage resulting from any reliance on the Information or use of it (including liability resulting from negligence or where the Group was aware of the possibility of such loss or damage arising) is excluded. This will not operate to limit or restrict the Group's liability for death or personal injury resulting from its negligence. Multicomp Pro is the registered trademark of Premier Farnell Limited 2019.

Newark.com/multicomp-pro
 Farnell.com/multicomp-pro
 Element14.com/multicomp-pro

