

Data sheet Illuminated pushbutton Ø 22 mm stainless steel 316L.

Part No.: 82-6651.1124

Technical data



Front form	round
Mounting cut-out	Ø 22.3 mm
Terminal	Plug-in terminal
Shape of illumination	Ring (Tritan)
Operating voltage	24 V DC (LED)
Lens illumination	illuminative
Lens colour	Silver
Lens shape	flush
Lens material	Stainless steel 316L
Lens optics	opaque
Front bezel shape	flush
Front bezel material	Stainless steel 316L
Weight	0.018 kg
IP front protection	IP65, IP67
Contacts change over	1 C
Contact material	Silver
Illumination colour	Blue
Kind of illumination	Single-LED
Switching action	Momentary
Switching voltage	36 V
Switching voltage kind of	AC/DC
Switching current	0.6 A
Switching system	Snap-action switching element

Hints

- Switching voltage: max. 36 V AC/1A, max. 36 V DC/0.6

Dimensions

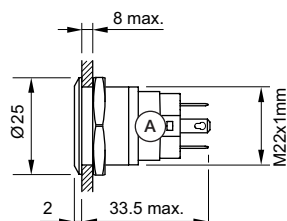

Mounting cut-outs

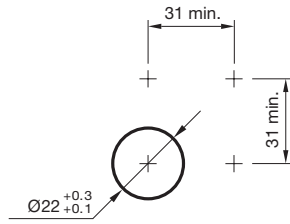

Wiring diagrams

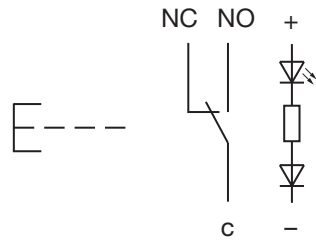

Component layouts

