

Stacked Metallized Plastic Film Capacitor

Type: **ECQV(L)/(M)**

Designed for high density insertion applications.

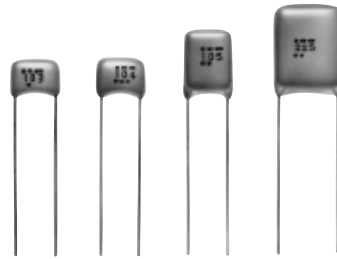

■ Features

- Small size and large capacitance
- Excellent electric characteristics in non-inductive construction
- Wide range for automatic insertion
- RoHS directive compliant

■ Recommended Applications

- General purpose
- Noise suppression for logic circuit

■ Explanation of Part Numbers

1	2	3	4	5	6	7	8	9	10	11	12
E	C	Q	V						J		
Product code	Dielectric & construction		Rated voltage		Capacitance				Cap. Tol.	Suffix	Suffix
50 VDC 1H	63 VDC 1J	100 VDC 1			Taping				Crimped lead		
				Ammo		Reel		Type 1	Type 2		
				Straight		Crimped		style N		style T	
				2		3		Blank		W	

■ Specifications

Category temp. range (Including temperature-rise on unit surface)	-40 °C to +105 °C
Rated voltage	50 VDC, 63 VDC, 100 VDC (Derating of rated voltage by 2.5 %/°C at more than 85 °C)
Capacitance range	0.010 μF to 2.2 μF
Capacitance tolerance	± 5 % (J)
Dissipation factor (tan δ)	tan δ ≤ 1.0 % (20 °C, 1 kHz)
Withstand voltage	Between terminals : Rated volt. (VDC) × 150 % 60 s
Insulation resistance (IR)	C ≤ 0.33 μF : IR ≥ 3000 MΩ (20 °C, 50 VDC, 60 s ECQV1H, ECQV1J) C > 0.33 μF : IR ≥ 1000 MΩ · μF (20 °C, 100 VDC, 60 s ECQV1)

* In case of applying voltage in alternating current (50 Hz or 60 Hz sine wave) to a capacitor with DC rated voltage, please refer to the page of "Permissible voltage (R.M.S) in alternating current corresponding to DC rated voltage".

■ Dimensions in mm (not to scale)

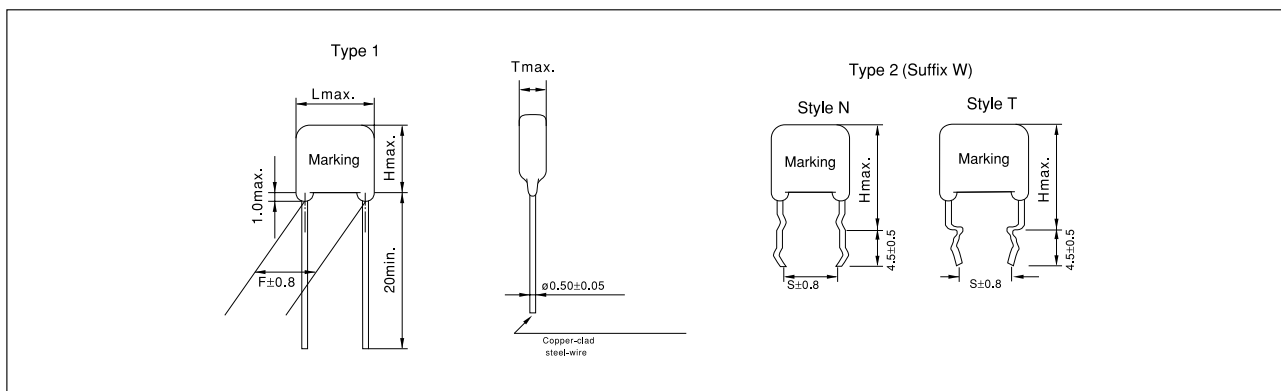

■ Packaging Specifications for Bulk Package

Packing quantity: 100 pcs./bag

■ Taping Specifications for Automatic Insertion

● Taping style

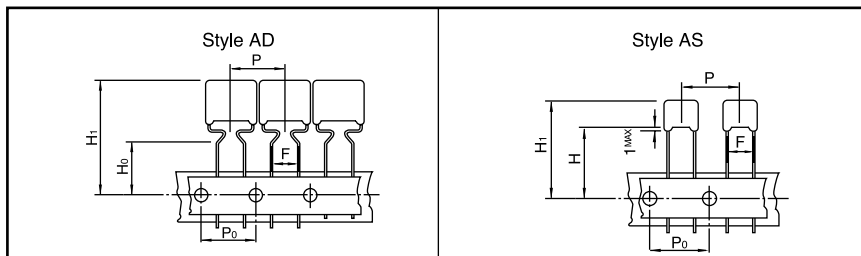

※ Refer to the page of taping specifications.

● Packaging Specifications

Type	Rated volt.	Cap. range (μF)	Taping style						Packing
			AD	AS	B	C	D	E	
ECQV (L)	50 VDC	0.010 to 2.2	○						Ammo
		0.010 to 1.0		○					Ammo
		0.010 to 2.2	○						Reel
		0.010 to 1.0		○					Reel
ECQV (M)	63 VDC	0.010 to 1.0	○						Ammo
		0.010 to 0.15		○					Ammo
		0.010 to 1.0	○						Reel
		0.010 to 0.15		○					Reel
	100 VDC	0.010 to 0.47	○						Ammo
		0.010 to 0.47		○					Reel
		0.010 to 0.10			○				Ammo
		0.010 to 0.10			○				Reel

● Lead Spacing

Style	Lead Spacing
AD	5.0 mm
AS	5.0 mm

※ See the column "Rating, Dimensions & Quantity Box" for packing quantity.

■ Rating, Dimensions & Quantity/Ammo Box or Reel

● Type ECQV(L) Rated voltage : 50 VDC

Part No.	Cap. (μF)	Dimensions (mm)							Quantity	
		L _{max.}	T _{max.}	H _{max.}		F	S	ød	Ammo	Reel
				Type 1	Type 2					
ECQV1H103JL()	0.010	7.3	3.2	5.0	9.0	5.0	5.0	0.50	2000	2000
ECQV1H123JL()	0.012	7.3	3.2	5.0	9.0	5.0	5.0	0.50		
ECQV1H153JL()	0.015	7.3	3.2	5.0	9.0	5.0	5.0	0.50		
ECQV1H183JL()	0.018	7.3	3.2	5.0	9.0	5.0	5.0	0.50		
ECQV1H223JL()	0.022	7.3	3.2	5.0	9.0	5.0	5.0	0.50		
ECQV1H273JL()	0.027	7.3	3.2	5.0	9.0	5.0	5.0	0.50		
ECQV1H333JL()	0.033	7.3	3.2	5.0	9.0	5.0	5.0	0.50		
ECQV1H393JL()	0.039	7.3	3.2	5.0	9.0	5.0	5.0	0.50		
ECQV1H473JL()	0.047	7.3	3.2	5.0	9.0	5.0	5.0	0.50		
ECQV1H563JL()	0.056	7.3	3.2	5.0	9.0	5.0	5.0	0.50		
ECQV1H683JL()	0.068	7.3	3.2	5.0	9.0	5.0	5.0	0.50		
ECQV1H823JL()	0.082	7.3	3.6	5.0	9.0	5.0	5.0	0.50		
ECQV1H104JL()	0.10	7.3	4.0	5.0	9.0	5.0	5.0	0.50		
ECQV1H124JL()	0.12	7.3	4.0	5.0	9.0	5.0	5.0	0.50		
ECQV1H154JL()	0.15	7.3	4.4	5.5	9.5	5.0	5.0	0.50		
ECQV1H184JL()	0.18	7.3	4.5	5.5	9.5	5.0	5.0	0.50		
ECQV1H224JL()	0.22	7.3	4.8	5.5	9.5	5.0	5.0	0.50		
ECQV1H274JL()	0.27	7.3	4.6	7.0	11.0	5.0	5.0	0.50		
ECQV1H334JL()	0.33	7.3	5.2	7.0	11.0	5.0	5.0	0.50		
ECQV1H394JL()	0.39	7.3	5.7	7.3	11.3	5.0	5.0	0.50		
ECQV1H474JL()	0.47	7.3	6.0	7.3	11.3	5.0	5.0	0.50		
ECQV1H564JL()	0.56	7.3	5.8	10.0	14.0	5.0	5.0	0.50		
ECQV1H684JL()	0.68	7.3	6.5	10.0	14.0	5.0	5.0	0.50		
ECQV1H824JL()	0.82	7.3	6.8	10.0	14.0	5.0	5.0	0.50		
ECQV1H105JL()	1.0	7.3	8.0	11.0	15.0	5.0	5.0	0.50		
ECQV1H125JL()	1.2	10.2	6.5	10.0	14.0	7.5	5.0	0.50		
ECQV1H155JL()	1.5	10.2	7.2	10.0	14.0	7.5	5.0	0.50		
ECQV1H185JL()	1.8	10.2	7.2	12.0	16.5	7.5	5.0	0.50		
ECQV1H225JL()	2.2	10.2	7.9	12.0	16.5	7.5	5.0	0.50		

↳ Suffix for lead crimped or taped type

Style N: 0.010 μF to 1.0 μF
Style T: 1.2 μF to 2.2 μF

■ Rating, Dimensions & Quantity/Ammo Box or Reel

● Type ECQV(M) Rated voltage : 63 VDC

Part No.	Cap. (μ F)	Dimensions (mm)							Quantity	
		L _{max.}	T _{max.}	H _{max.}		F	S	ϕ d	Ammo	Reel
				Type 1	Type 2	Type 1	Type 2			
ECQV1J103JM()	0.010	7.5	3.2	6.8	10.8	5.0	5.0	0.50	2000	2000
ECQV1J123JM()	0.012	7.5	3.2	6.8	10.8	5.0	5.0	0.50		
ECQV1J153JM()	0.015	7.5	3.2	6.8	10.8	5.0	5.0	0.50		
ECQV1J183JM()	0.018	7.5	3.2	6.8	10.8	5.0	5.0	0.50		
ECQV1J223JM()	0.022	7.5	3.2	6.8	10.8	5.0	5.0	0.50		
ECQV1J273JM()	0.027	7.5	3.2	6.8	10.8	5.0	5.0	0.50		
ECQV1J333JM()	0.033	7.5	3.2	6.8	10.8	5.0	5.0	0.50		
ECQV1J393JM()	0.039	7.5	3.2	6.8	10.8	5.0	5.0	0.50		
ECQV1J473JM()	0.047	7.5	3.2	6.8	10.8	5.0	5.0	0.50		
ECQV1J563JM()	0.056	7.5	3.2	6.8	10.8	5.0	5.0	0.50		
ECQV1J683JM()	0.068	7.5	3.2	6.8	10.8	5.0	5.0	0.50		
ECQV1J823JM()	0.082	7.5	3.2	6.8	10.8	5.0	5.0	0.50		
ECQV1J104JM()	0.10	7.5	3.2	7.0	11.0	5.0	5.0	0.50		
ECQV1J124JM()	0.12	7.5	3.8	7.0	11.0	5.0	5.0	0.50		
ECQV1J154JM()	0.15	7.5	4.1	7.0	11.0	5.0	5.0	0.50		
ECQV1J184JM()	0.18	10.2	3.5	9.0	14.0	7.5	5.0	0.50		
ECQV1J224JM()	0.22	10.2	3.5	9.0	14.0	7.5	5.0	0.50		
ECQV1J274JM()	0.27	10.2	3.5	9.0	14.0	7.5	5.0	0.50		
ECQV1J334JM()	0.33	10.2	3.8	9.0	14.0	7.5	5.0	0.50		
ECQV1J394JM()	0.39	10.2	4.0	9.0	14.0	7.5	5.0	0.50		
ECQV1J474JM()	0.47	10.2	4.5	9.0	14.0	7.5	5.0	0.50		
ECQV1J564JM()	0.56	10.2	4.9	9.0	14.0	7.5	5.0	0.50		
ECQV1J684JM()	0.68	10.2	5.5	10.0	15.0	7.5	5.0	0.50		
ECQV1J824JM()	0.82	10.2	6.1	10.0	15.0	7.5	5.0	0.50		
ECQV1J105JM()	1.0	10.2	6.9	10.0	15.0	7.5	5.0	0.50		

Style N: 0.010 μ F to 0.15 μ F

Style T: 0.18 μ F to 1.0 μ F

● Type ECQV(M) Rated voltage : 100 VDC

Part No.	Cap. (μ F)	Dimensions (mm)							Quantity	
		L _{max.}	T _{max.}	H _{max.}		F	S	ϕ d	Ammo	Reel
				Type 1	Type 2	Type 1	Type 2			
ECQV1103JM()	0.010	7.5	3.2	7.0	12.0	5.0	5.0	0.50	2000	2000
ECQV1123JM()	0.012	7.5	3.2	7.0	12.0	5.0	5.0	0.50		
ECQV1153JM()	0.015	7.5	3.2	7.0	12.0	5.0	5.0	0.50		
ECQV1183JM()	0.018	7.5	3.2	7.0	12.0	5.0	5.0	0.50		
ECQV1223JM()	0.022	7.5	3.2	7.0	12.0	5.0	5.0	0.50		
ECQV1273JM()	0.027	7.5	3.2	7.0	12.0	5.0	5.0	0.50		
ECQV1333JM()	0.033	7.5	3.2	7.0	12.0	5.0	5.0	0.50		
ECQV1393JM()	0.039	7.5	3.2	7.0	12.0	5.0	5.0	0.50		
ECQV1473JM()	0.047	7.5	3.2	7.0	12.0	5.0	5.0	0.50		
ECQV1563JM()	0.056	7.5	3.2	7.0	12.0	5.0	5.0	0.50		
ECQV1683JM()	0.068	7.5	4.0	7.0	12.0	5.0	5.0	0.50		
ECQV1823JM()	0.082	7.5	4.1	7.0	12.0	5.0	5.0	0.50		
ECQV1104JM()	0.10	7.5	4.5	7.0	12.0	5.0	5.0	0.50	1000	1000
ECQV1124JM()	0.12	10.2	3.3	9.0	14.0	7.5	5.0	0.50	2000	2000
ECQV1154JM()	0.15	10.2	3.3	9.0	14.0	7.5	5.0	0.50		
ECQV1184JM()	0.18	10.2	3.6	9.0	14.0	7.5	5.0	0.50		
ECQV1224JM()	0.22	10.2	4.0	9.0	14.0	7.5	5.0	0.50		
ECQV1274JM()	0.27	10.2	4.2	9.0	14.0	7.5	5.0	0.50	1000	1000
ECQV1334JM()	0.33	10.2	4.8	10.0	15.0	7.5	5.0	0.50		
ECQV1394JM()	0.39	10.2	5.5	10.0	15.0	7.5	5.0	0.50		
ECQV1474JM()	0.47	10.2	6.8	10.5	15.5	7.5	5.0	0.50		

↑ Suffix for lead crimped or taped type

Style N: 0.010 μ F to 0.1 μ F

Style T: 0.12 μ F to 0.47 μ F